

LEGEND:

- A ~ PK nail set
- B ~ 5/8" Rebar set
- C ~ 4" Steel post found

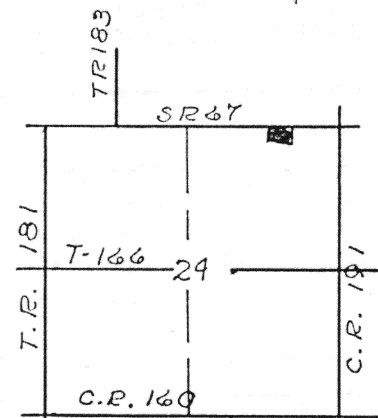

DESCRIPTION

Being a parcel of land situate in the Northeast quarter of Section 24, T-5-S, R-6-E, Duchouquet Township, Auglaize County, Ohio and more particularly described as follows:

Commencing at a railroad spike found at the northeast corner of said Northeast quarter of said Section 24; thence N 90°00'00" W with the north line of said Northeast quarter (also the centerline of State Route 67), 689.30 feet to a PK nail set and the PLACE OF BEGINNING; thence continuing N 90°00'00" W with said north line and centerline, 232.00 feet to a PK nail set; thence S 00°24'02" W (passing through a 5/8 inch rebar set at 30.00 feet), 206.50 feet to a 5/8 inch rebar set; thence S 84°45'50" E (passing through a four inch steel post found at 18.14 feet), 232.00 feet to a four inch steel post found; thence N 00°36'25" E (passing through a four inch steel post found at 197.68 feet), 227.68 feet to the PLACE OF BEGINNING containing 1.154 acres more or less of which 0.154 acre is within road right-of-way and subject to all highways and other legal easements of record.

Signature by a representative of the County Health Dept. denotes compliance with Health Regulations.
Signed: _____ Date: _____

Signature by a representative of the Auglaize County Regional Planning Commission denotes approval of this plat.
Signed: _____ Date: _____

Signature by a representative of City with 3 mile limit jurisdiction or Twp. Trustees or Village with zoning jurisdiction denotes approval of this plat. Signed: _____
for political S. D. of: _____ Date: _____

Signature by a representative of the County Engineer's Dept. denotes that this plat meets tax map plat requirements.
Signed: _____ Date: _____

Client Herbert Boyer
County Auglaize Twp. Duchouquet Sec. 24
Drawn by RDM Scale 1"=100' Drwg. No. _____
Checked by rdm Date 10/20/87
Sheet 1 of 1 H-536 (T-5-S; R-6-E)

LS 6470