

1"=200'

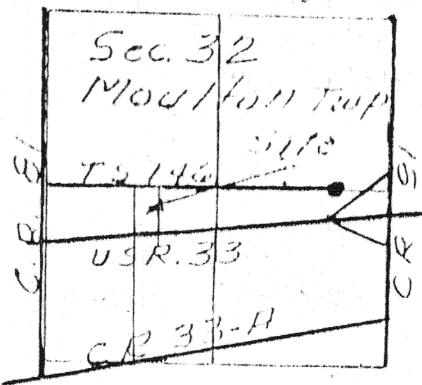

Sheet 1 of 2 14-650 (T 5 S; R 5 E)

420000 28 6470

KUCK and MORRISEY, INC.

CONSULTING ENGINEERS & SURVEYORS

LIMA, OHIO 43005

TELEPHONE 228-1735 - AREA CODE 419

2807 CHAPEL HILL DRIVE

CLIENT	John Eaton RR #4, Wapakoneta, Ohio		
COUNTY	Auglaize	TOWNSHIP	Moulton
SECTION	32	T-5-S, R-5-E	LOT NO.
SUBDIVISION			
DATE	5/21/83	COMPUTED BY	rdm
		SURVEYED BY	J.W.E
SHEET NO.		2	OF 2

The following described tract of land is part of 16.00 acres off the north part of the east half of the southwest quarter of Section 32, T-5-S, R-5-E, Moulton Township, Auglaize County, Ohio and is more particularly described as follows:

Commencing at the stone at the center of said Section 32, Moulton Township (said stone lying 16.5 feet south of the centerline of Lynch Road # 146); thence N 89°17'27" W with the north line of said southwest quarter of Section 32, Moulton Township (said north line being parallel with the centerline of Lynch Road # 146 and 16.5 feet south of said centerline), 1073.96 feet to an iron pin set and the PLACE OF BEGINNING;

Thence S 01°20'17" W, 541.18 feet to an iron pin set on the north line of U.S.R. #33 limited access highway;

Thence S 83°15'31" W along said north line of U.S.R. #33 limited access highway, 205.48 feet to a point being 125.00 feet north of Station 430+00 of U.S.R. #33 limited access highway;

Thence S 84°07'05" W along the north line of U.S.R. #33 limited access highway, 34.32 feet to an iron pin;

Thence N 01°20'17" E, 571.77 feet to an iron pin set on the north line of the southwest quarter of Section 32, Moulton Township (said north line being 16.5 feet south of the centerline of Lynch Road # 146);

Thence S 89°17'27" E along the north line of said southwest quarter of Section 32, Moulton Township (said north line being parallel with the centerline of Lynch Road #146 and 16.5 feet south of said centerline), 237.50 feet to an iron pin which was the PLACE OF BEGINNING containing 3.035 acres more or less and subject to all legal easements of record.

G 21-032-013-02

Land - 4570

Add - 000
11,270

all 1985 taxes paid

H-651