

BARBER SURVEY
PART SW 1/4, SEC. 31, T4S, R4E, SALEM TWP.
AUGLAIZE CO., OHIO



Scale:
100

DB 236, PG. 139

S89°18'32"W 547.85'

EXIST. COR. POST
LOCATION PLAT

EXIST. COR. POST

OCCUPIED LINE

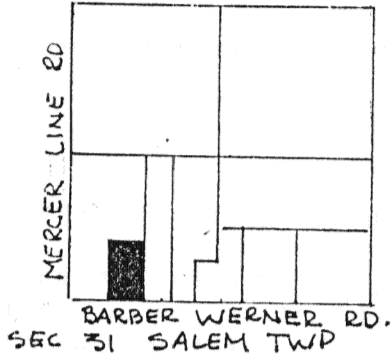

15.431 ACRES

DB 250
PG. 326



DB 69 PG 217

DB 236 PG 139

S00°11'19"W 1341.66'

N 00°23'03"E 1204.64'

MON. BOX
SW COR SEC 31

N00°24'36"W
S00°24'36"E
139.94'

S89°36'43"W 433.15'
N89°36'43"E

1.389 ACRES

NOTE: COUNTY CLAIMS 25' RIGHT OF WAY
OCCUPANCY AT 20'

N89°36'34"E
112.00'

N89°36'34"E 431.21'

N00°23'03"E
139.95'
N89°36'34"E
1341.60'

SOUTH LINE SEC. 31 &
E BARBER-WERNER RD.

LEGEND

- MON. BOX
- RR SPK SET
- IRON PIN SET
- COR. POST-EXISTING

BEARINGS TURNED FROM SOUTH LINE SEC 31
EST. N89°36'34"E ON PREVIOUS SURVEY.

Signature by a representative of the County Health Dept.
denotes compliance with Health Regulations.
Signed: _____ Date _____

Signature by a representative of the Auglaize County Regional
Planning Commission denotes approval of this plat.
Signed: _____ Date _____

Signature by a representative of City with 3 mile limit juris-
diction or Twp. Trustees or Village with zoning jurisdiction
denotes approval of this plat. Signed: _____
for political S. D. of: _____ Date _____

Signature by a representative of the County Engineer's Dept.
denotes that this plat meets tax map plat requirements.
Signed: _____ Date _____

PLAT BY SURVEY JULY 1988

Roy F. Thompson, Jr.
ROY F THOMPSON JR. S-005379

Client HENRIETTA BARBER

County AUGLAIZE Twp. SALEM Sec. 31
Drawn by THOMPSON Scale 1"=100' Drwg. No. _____
Checked by _____ Date JULY 1988
Sheet 1 of 2 11-722 (T 4 S; R 4 E)

15.431 Acres

BARBER SURVEY
PART SW 1/4, SEC. 31, T4S, R4E,
SALEM TOWNSHIP, AUGLAIZE CO., OHIO

COMMENCING AT THE SOUTHWEST CORNER OF SECTION 31, T4S, R4E, SALEM TOWNSHIP, AUGLAIZE COUNTY, OHIO, SAID CORNER BEING A STONE AT THE INTERSECTION OF THE CENTERLINES OF THE BARBER WERNER ROAD AND THE MERCER LINE ROAD,

THENCE NORTH 89 DEGREES 36 MINUTES 34 SECONDS EAST ALONG THE SOUTH LINE OF SECTION 31, ONE THOUSAND THREE HUNDRED AND EIGHTY-EIGHT HUNDREDTHS (1300.88) FEET TO A RAILROAD SPIKE SET AS THE PLACE OF BEGINNING,

THENCE CONTINUING NORTH 89 DEGREES 36 MINUTES 34 SECONDS EAST ON AND ALONG THE SOUTH LINE OF SECTION 31, ALSO BEING THE CENTERLINE OF THE BARBER WARNER ROAD, ONE HUNDRED TWELVE (112.00) FEET TO A RAILROAD SPIKE SET,

THENCE NORTH 00 DEGREES 24 MINUTES 36 SECONDS WEST, ONE HUNDRED THIRTY-NINE AND NINETY-FOUR HUNDREDTHS (139.94) FEET TO AN IRON PIN SET, AND PASSING THRU AN IRON PIN SET AT TWENTY-FIVE (25.00) FEET,

THENCE NORTH 89 DEGREES 36 MINUTES 43 SECONDS EAST, FOUR HUNDRED THIRTY-THREE AND FIFTEEN HUNDREDTHS (433.15) FEET TO AN IRON PIN SET,

THENCE NORTH 00 DEGREES 23 MINUTES 03 SECONDS EAST, ONE THOUSAND TWO HUNDRED FOUR AND SIXTY-FOUR HUNDREDTHS (1204.64) FEET, ALONG THE LANDS DESCRIBED IN DEED VOL. 69, PAGE 217, TO A CORNER POST,

THENCE SOUTH 89 DEGREES 18 MINUTES 32 SECONDS WEST, FIVE HUNDRED FORTY-SEVEN AND EIGHTY-FIVE HUNDREDTHS (547.85) FEET ALONG THE LANDS DESCRIBED IN DEED VOLUME 236, PAGE 139, TO A CORNER POST,

THENCE SOUTH 00 DEGREES 11 MINUTES 19 SECONDS WEST, ONE THOUSAND THREE HUNDRED FORTY-ONE AND SIXTY-SIX HUNDREDTHS (1341.66) FEET ALONG THE LANDS DESCRIBED IN DEED VOLUME 236, PAGE 139, TO THE PLACE OF BEGINNING AND PASSING THRU A CONCRETE POST SET AT TWENTY (20.00) FEET FROM SAID PLACE OF BEGINNING.

THE AFORE DESCRIBED TRACT CONTAINS FIFTEEN AND FOUR HUNDRED THIRTY-ONE THOUSANDTHS (15.431) ACRES, MORE OR LESS, SUBJECT TO ALL HIGHWAYS AND EASEMENTS OF RECORD, IS PART OF THE LANDS DESCRIBED IN THE AUGLAIZE COUNTY RECORD OF DEEDS, VOLUME 250, PAGE 326, AND SHOWN ON A PLAT OF SURVEY FILED WITH THE AUGLAIZE COUNTY ENGINEER.

ALL BEARINGS WERE TURNED FROM THE SOUTH LINE OF SECTION 31, ALSO BEING THE CENTERLINE OF THE BARBER WARNER ROAD ESTABLISHED AS NORTH 89 DEGREES 36 MINUTES 34 SECONDS EAST ON PREVIOUS SURVEYS.

THIS INSTRUMENT PREPARED BY ROY F. THOMPSON JR., REG. SUR. NO. 5379.

H-723

1.389 Acres

BARBER SURVEY
PART SW 1/4, SEC 31, T4S, R4E,
SALEM TOWNSHIP, AUGLAIZE CO., OHIO

COMMENCING AT THE SOUTHWEST CORNER OF SECTION 31, T4S, R4E, SALEM TOWNSHIP, AUGLAIZE COUNTY, OHIO, SAID CORNER BEING A STONE AT THE INTERSECTION OF THE CENTERLINES OF THE BARBER WARNER ROAD AND THE MERCER LINE ROAD,

THENCE NORTH 89 DEGREES 36 MINUTES 34 SECONDS EAST ALONG THE SOUTH LINE OF SECTION 31, ONE THOUSAND FOUR HUNDRED TWELVE AND EIGHTY-EIGHT HUNDREDTHS (1412.88) FEET TO A RAILROAD SPIKE SET AS THE PLACE OF BEGINNING,

THENCE CONTINUING NORTH 89 DEGREES 36 MINUTES 34 SECONDS EAST, FOUR HUNDRED THIRTY-ONE AND TWENTY-ONE HUNDREDTHS (431.21) FEET TO A RAILROAD SPIKE SET,

THENCE NORTH 00 DEGREES 23 MINUTES 03 SECONDS EAST, ALONG THE LANDS DESCRIBED IN DEED VOL. 69, PAGE 217, ONE HUNDRED THIRTY-NINE AND NINETY-FIVE HUNDREDTHS (139.95) FEET TO AN IRON PIN SET, AND PASSING THRU AN EXISTING CORNER POST AT TWENTY (20.00) FEET AND AN IRON PIN SET AT TWENTY-FIVE (25.00) FEET,

THENCE SOUTH 89 DEGREES 36 MINUTES 43 SECONDS WEST, FOUR HUNDRED THIRTY-THREE AND FIFTEEN HUNDREDTHS (433.15) FEET TO AN IRON PIN SET,

THENCE SOUTH 00 DEGREES 24 MINUTES 36 SECONDS EAST, ONE HUNDRED THIRTY-NINE AND NINETY-FOUR HUNDREDTHS (139.94) FEET TO THE PLACE OF BEGINNING AND PASSING THRU AN IRON PIN SET AT ONE HUNDRED FOURTEEN AND NINETY-FOUR HUNDREDTHS (114.94) FEET.

THE AFORE DESCRIBED TRACT CONTAINS ONE AND THREE HUNDRED EIGHTY-NINE THOUSANDTHS (1.389) ACRES, MORE OR LESS, SUBJECT TO ALL HIGHWAYS AND EASEMENTS OF RECORD, IS PART OF THE LANDS LAST DESCRIBED IN DEED VOLUME 250, PAGE 326 AND SHOWN ON A PLAT OF SURVEY FILED WITH THE AUGLAIZE COUNTY ENGINEER.

ALL BEARINGS WERE TURNED FROM THE SOUTH LINE OF SECTION 31, ALSO BEING THE CENTERLINE OF THE BARBER WARNER ROAD ESTABLISHED AS NORTH 89 DEGREES 36 MINUTES 34 SECONDS EAST ON PREVIOUS SURVEYS.

THIS INSTRUMENT PREPARED BY ROY F. THOMPSON JR., REG. SUR. NO. 5379

14-724