

Scale:  
1" = 800'

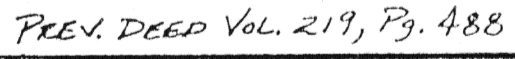

Client JOE SAWMILLER  
County ADAMS Twp. UNION Sec. 6  
Drawn by ML Scale 1"=200' Drwg. No. JE 101  
Checked by REP Date DEC. 4, 1986  
Sheet 1 of 2 H-790 (T 5 S; R 7 E)



Scale:  
N/A

Description 16.80 Acres

Being a parcel of land situated in the southwest quarter of Section 6, T 5 S,  
R 7 E, Union Township, Auglaize County, Ohio, and more fully described as follows:

Beginning at a point (said point being on the centerline of  
County Road No. 191---Townline/Lima Road, also the west line of the southwest quarter  
of Section 6---located S 03° 00' W a distance of 600.00' from a R.R. Spike at the  
northwest corner of the southwest quarter of Section 6); thence continuing  
S 03° 00' W along the centerline of County Road No. 191 and the west line of the  
southwest quarter of Section 6 for a distance of 162.86' to a R.R. Spike found;  
thence S 87° 54' E for a distance of 335.08' to a point; thence S 03° 00' W for a  
distance of 180.00' to a point; thence S 87° 54' 20" E parallel to the north line  
of the southwest quarter of Section 6 for a distance of 1974.92' to a iron pipe found;  
thence N 03° 00' E for a distance of 342.86' to a point; thence N 87° 54' 20" W  
parallel to the north line of the southwest quarter of Section 6 for a distance of  
2310.00' to the point of beginning.

Said parcel of land contains 16.80 acres, more or less, and is subject to all  
legal highways contains 0.11 acres, and easements of record.

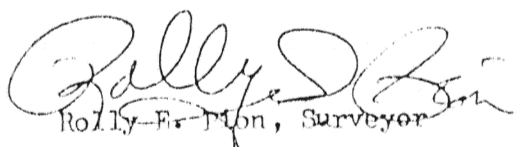
  
Rolly E. Pion, Surveyor

Registration No. 5013

Signature by a representative of the County Health Dept.  
denotes compliance with Health Regulations.  
Signed: \_\_\_\_\_ Date \_\_\_\_\_

Signature by a representative of the Auglaize County Regional  
Planning Commission denotes approval of this plat.  
Signed: \_\_\_\_\_ Date \_\_\_\_\_

Signature by a representative of the Village with zoning jurisdiction  
denotes approval of this plat. Signed: \_\_\_\_\_ Date \_\_\_\_\_  
for political S. D. of: \_\_\_\_\_

Signature by a representative of the County Engineer's Dept.  
denotes that this plat meets tax map plat requirements.  
Signed: \_\_\_\_\_ Date \_\_\_\_\_

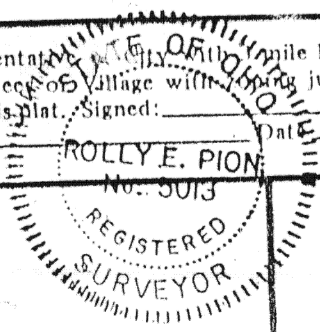

Client JOE SAWMILLER  
County AUGLAIZE Twp. Union Sec. 6  
Drawn by RSP Scale N/A Drwg. No. \_\_\_\_\_  
Checked by RSP Date 12-5-86  
Sheet 2 of 2 H-791 (T 5 S; R 7 E)