

CENTER OF SECTION 18,
NOBLE TOWNSHIP
T-5-S, R-4-E,
AUGLAIZE COUNTY, OHIO

NORTHEAST CORNER,
SOUTHEAST QUARTER,
SECTION 18, NOBLE TWP.,
T-5-S, R-4-E,
AUGLAIZE COUNTY

S. 89° 59' 30" E.
433.09'

E. T.R. 176 (ARNOLD RD.)

REF.
PIN AT
20.00'

3.41 ACRES

NOTE: T.R. 176 HAS NO RECORD
OF RIGHT-OF-WAY, BEING
OCCUPIED AS 40 FEET.

LEGEND

- MONUMENT BOX
- IRON PIN FOUND
- IRON PIN SET
- △ RAILROAD SPIKE FOUND
- ▲ RAILROAD SPIKE SET

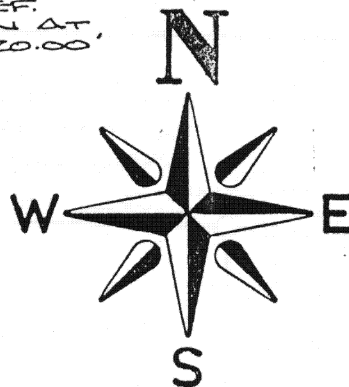

LOCATION

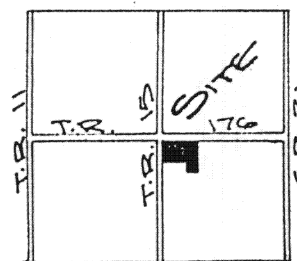

SEC. 18
NOBLE TOWNSHIP

S. 88° 28' 05" W.
326.54'

SCALE

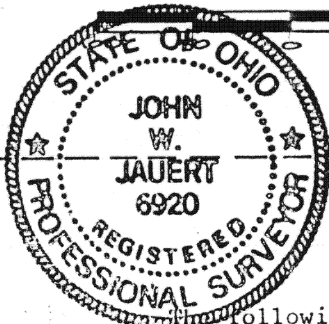

SURVEYOR'S DESCRIPTION

The following described tract of land is situated in the Southeast Quarter of Section 18, Noble Township, Town-5-South, Range-4-East, Auglaize County, Ohio, and is more particularly described as follows:

Commencing at an Auglaize County Monument Box located at the Northwest Corner of the Southeast Quarter of Section 18, Noble Township, Town-5-South, Range-4-East, Auglaize County, Ohio, and the PLACE OF BEGINNING;

thence with a bearing of S. 89°-59'-30" E. along the North line of the Southeast Quarter of said Section 18, and the centerline of Township Road #176 (formerly Arnold Road), for a distance of 433.09 feet to a Railroad Spike (set);

thence with a bearing of S. 00°-12'-35" W. for a distance of 421.20 feet to an iron pin (found), and passing thru an iron pin (set) for reference at 20.00 feet;

thence with a bearing of N. 90°-00'-00" W. for a distance of 106.06 feet to an iron pin (found);

thence with a bearing of N. 00°-29'-55" E. for a distance of 106.89 feet to an iron pin (found);

thence with a bearing of S. 88°-28'-05" W. for a distance of 326.54 feet to a Railroad Spike located on the West line of the Southeast Quarter of said Section 18, and the centerline of Township Road #15 (formerly Koenig Road);

thence with a bearing of N. 00°-00'-00" E. along the West line of the Southeast Quarter of said Section 18, and the centerline of Township Road #15 (Koenig Road), for a distance of 323.10' to an Auglaize County Monument Box and the PLACE OF BEGINNING.

Containing in all 3.41 Acres, of which 0.37 Acre being previously dedicated for highway purposes. The above described tract of land is also subject to all other legal easements, reservations, or restrictions, if any, upon said premises. All bearings were based upon previous surveys performed by Michael Weadock P.S. #6199, and Richard Morrissey P.S. #6470. Previous Deed References: Volume 243, Page 705, Auglaize County Recorder's Office.

THIS PLAT IS RECORDED IN SURVEY
BOOK "I", PAGE 7, IN THE AUGLAIZE
COUNTY ENGINEER'S OFFICE.

ATTEST:
JOHN W. JAUBERT
REGISTERED PROFESSIONAL SURVEYOR
NO. 6920

Jauert
ASSOCIATES

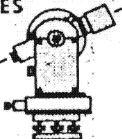

Surveying
AND LAND CONSULTING

RT.3 BOX 449 WAPAKONETA, OHIO 45895
PH. (419) 738-8962

Client ROGER LEFFEL
County AUGLAIZE Township NOBLE
Section 18 T. 5 S., R. 4 E. Drwg. No. 89-507
Drawn By K. SCHNELL Date Nov 1989
Scale AS SHOWN Sheet 1 of 1