

80,000 house

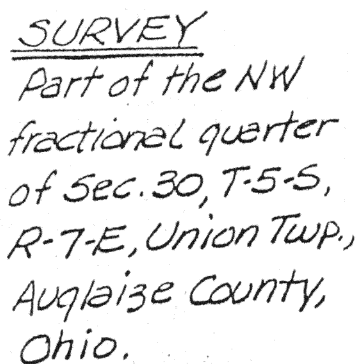

M. BAILEY

LEGEND

- ▲ Mon. Box
- ✖ RR Spike (fd)
- Mine Spike (set)
- 5/8 Re-rod (set)



By: James M. Kent
James M. Kent, P.S. 6792

Client DON BAILEY

County AUGLAIZE Twp. UNION

Sec. 30 T 5 S; R 7 E

Sheet 1 of 3 Drwg. N° 1319

SCALE 1"=100'

DRAWN BY JMK

APPROVED BY

DATE 5/31/91

REVISION 3

kent surveying

1701, Box 903 17500 Bellefontaine Street
Wapakoneta, Ohio 45388
(419) 738-5677

Scale:

LEGAL DESCRIPTION

TRACT "A"

Being a parcel of land situate in the northwest fractional quarter of Section 30, T-5-S, R-7-E, Union Township, Auglaize County, Ohio and being more particularly described as follows:

Commencing at a monument box marking the location of the west quarter corner of said fraction quarter section and the centerline of Townline Lima Road; thence N 00°00'00"E (assumed bearing) along the westerly line of said fractional quarter section and the centerline of Townline Lima Road for a distance of 1820.40 feet to a mine spike (set) and the PLACE OF BEGINNING;

thence continuing N 00°00'00"E along the aforesaid line. for a distance of 239.86 feet to a mine spike (set);

thence N 89°00'00"E, parallel with the north line of the northwest fractional quarter of Section 30, a distance of 363.26 feet to a 5/8" re-rod w/cap (set);

thence S 00°00'00"W for a distance of 239.86 feet to a 5/8" re-rod w/cap (set);

thence S 89°00'00"W a distance of 363.26 feet to the PLACE OF BEGINNING, containing therein 2.00 acres more or less, of which 0.137 acres is road right-of-way. Subject to easements and restrictions of record.

TRACT "B"

Being a parcel of land situate in the northwest fractional quarter of Section 30, T-5-S, R-7-E, Union Township, Auglaize County, Ohio and being more particularly described as follows:

Commencing at a monument box marking the location of the west quarter corner of said fractional quarter section and the centerline of Townline Lima Road; thence N 00°00'00"E (assumed bearing) along the westerly line of said fractional quarter section and the centerline of Townline Lima Road for a distance of 2060.26 feet to a mine spike (set) and the PLACE OF BEGINNING;

thence continuing N 00°00'00"E along the aforesaid line for a distance of 599.65 feet to a monument box at the northwest corner of said northwest fractional quarter;

thence N 89°00'00"E along the north line of said fraction quarter and the centerline of Blank Pike for a distance of 363.26 feet to a mine spike (set);

thence S 00°00'00"W a distance of 599.65 feet to a 5/8" re-rod w/cap (set);

thence S 89°00'00"W a distance of 363.26 feet to the PLACE OF

Client BAILEY
County AUGLAIZE Twp. UNION
Sec. 30 T 5 S, R 7 E
Sheet 2 of 3 Drwg. No. _____

SCALE _____
DRAWN BY _____
APPROVED BY _____
DATE _____
REVISIONS _____

kent
surveying

P.O. Box 181 1780 Belknapville Street
Wapakoneta, Ohio 45388
(419) 748-5677



Scale:

BEGINNING, containing therein 5.00 acres more or less, of which 0.538 acres is road right-of-way. Subject to all easements and restrictions of record.

By:

James M. Kent
James M. Kent, P.S. 6792

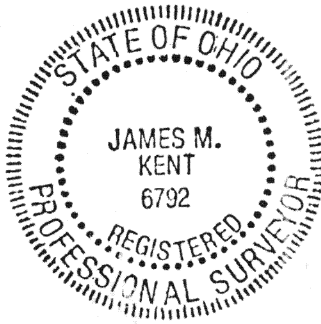

Client BAILEY
County AUGLAIZE TWP. UNION
Sec. 30 T 5 S; R 7 E
Sheet 3 of 3 Drwg. N°

SCALE _____
DRAWN BY _____
APPROVED BY _____
DATE _____
REVISIONS _____

kent
surveying

P.O. Box 103 1760 Bellefontaine Street
Wapakoneta, Ohio 45885
(419) 734-5677