

LEGEND

- A ~ PK nail set
- B ~ Railroad Spike found
- C ~ 5/8" rebar set

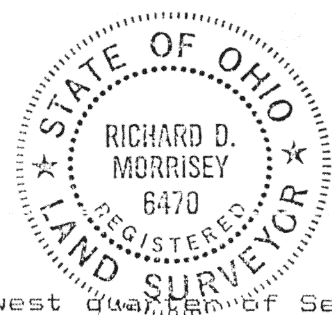

DESCRIPTION

Being a parcel of land situate in the Southwest quarter of Section 2, T-5-S, R-6-E, Duchouquet Township, Auglaize County, Ohio and more particularly described as follows:

Commencing at a monument box found at the southwest corner of said Southwest quarter of said Section 2; thence S 89°38'05" E with the south line of said Southwest quarter (also the centerline of Buckland-Holden Road), 680.00 feet to a railroad spike found at the intersection of said south line and centerline with the centerline of County Road 25-A; thence N 27°52'00" E with said centerline of said County Road 25-A, 2500.26 feet to a PK nail set and the PLACE OF BEGINNING thence continuing N 27°52'00" E with said centerline, 186.16 feet to a PK nail set; thence S 89°43'45" E (passing through a railroad tie corner post found at 51.08 feet), 484.88 feet to a 5/8 inch rebar set; thence S 00°16'21" W, 165.00 feet to a 5/8 inch rebar set; thence N 89°43'45" W (passing through a 5/8 inch rebar set at 520.04 feet), 571.12 feet to a PLACE OF BEGINNING containing 2.000 acres more or less and subject to all highway and other legal easements of record.

Signature by a representative of the County Health Dept. denotes compliance with Health Regulations. Signed: _____ Date: _____	Signature by a representative of the Auglaize County Regional Planning Commission denotes approval of this plat. Signed: _____ Date: _____
Signature by a representative of City with 3 mile limit jurisdiction or Twp. Trustees or Village with zoning jurisdiction denotes approval of this plat. Signed: _____ for political S. D. of: _____ Date: _____	Signature by a representative of the County Engineer's Dept. denotes that this plat meets tax map plat requirements. Signed: _____ Date: _____

KUCK AND MORRISEY, INC.
CONSULTING ENGINEERS & SURVEYORS
2807 CHAPEL HILL DRIVE
LIMA, OHIO 45805 - 228-1735

Client William Terflinger S. Dixie Hwy.
County Auglaize Twp. Duchouquet Sec. 2
Drawn by RDM Scale 1" = 150' Drwg. No. _____
Checked by rdm Date 2/28/89
Sheet 1 of 1 J-290 (T-5-S:R-6-E)