

Plat of Survey: Parcel B- Being a part of
the S 1/2 of the NW 1/4 of Sec. 31, Moulton
Twp., T-5-S, R-5-E, Auglaize Co., Ohio

Scale:
1"=50'

Vogel Rd.
Mon Box e NW Cor Sec 31

2277.04'
25'
205.00'

NOBLE TWP
MOULTON TWP
N 01°19'05"E (per O.D.O.T.)
165.00'

S 89°27'07"E
264.00'

PARCEL B
1.095 Acres

264.00'
N 89°27'07"W
Parcel A

S 89°27'07"E 3447.04'

Fd. Stone @
Center Sec. 31

165.00'
S 01°19'05"W

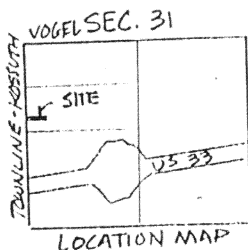

Legend

- Set RR spike
- Set 5/8" re-radw/cap.

ATTEST:

[Signature]

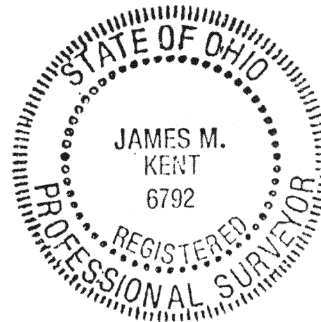

Signature by a representative of the County Engineer's Dept.
denotes that this plat meets tax map plat requirements.
Signed: _____ Date _____

Signature by a (representative of the) County Commissioner(s)
denotes approval of this plat.
Signed: _____ Date _____

Signature by a representative of the County Health Dept.
denotes compliance with Health Regulations.
Signed: _____ Date _____

Signature by a representative of the Auglaize County Regional
Planning Commission denotes approval of this plat.
Signed: _____ Date _____

kent
surveying

P.O. Box 402
Wapakoneta, Ohio 45895

Client KATHY LINK
County AUGLAIZE Twp. MOULTON Sec. 31
Drawn by VJK Scale 10/25/89 Drwg. No. 992-B
Checked by JMK Date 10/25/89
Sheet 1 of 2 J 480 (T S R E)



Scale: _____

PARCEL B

LEGAL DESCRIPTION

Being a part of the South one-half of the northwest fractional quarter of section 31, T-5-S, R-5-E, Moulton Township, Auglaize County, Ohio and being more particularly described as follows:

Commencing at a railroad spike found at the west quarter corner of said section 31 and the centerline of Townline-Kossuth Road; thence N 01°19'05"E along the west line of section 31 and the centerline of Townline-Kossuth Road a distance of 205.00 feet to a railroad spike (set) and the PLACE OF BEGINNING;

thence continuing N 01°19'05"E along the west line of section 31 and the centerline of said Townline-Kossuth Road a distance of 165.00 feet to a railroad spike (set);

thence S 89°27'07"E (passing through a 5/8" re-rod w/cap [set] at a distance of 25.00 feet) a distance of 289.00 feet to a 5/8" re-rod w/cap (set);

thence S 01°19'05"W a distance of 165.00 feet to a 5/8" re-rod w/cap (set);

thence N 89°27'07"W and parallel with the south line of the northwest quarter of section 31 (passing through a 5/8" re-rod [set] at a distance of 264.00 feet) a distance of 289.00 feet to the PLACE OF BEGINNING, containing 1.095 acres more or less and subject to easements and right-of-ways of record.

Prepared by James M. Kent, P.S.

Signature by a representative of the County Engineer's Dept.
denotes that this plat meets tax map plat requirements.
Signed: _____ Date _____

Signature by a (representative of the) County Commissioner(s)
denotes approval of this plat.
Signed: _____ Date _____

Signature by a representative of the County Health Dept.
denotes compliance with Health Regulations.
Signed: _____ Date _____

Signature by a representative of the Auglaize County Regional
Planning Commission denotes approval of this plat.
Signed: _____ Date _____

kent
surveying

P.O. Box 402
Wapakoneta, Ohio 45895

Client Kathy Link
County _____ Twp. _____ Sec. _____
Drawn by _____ Scale _____ Drwg. No. _____
Checked by _____ Date _____
Sheet 2 of 2 J-481 (T _____ S _____ R _____ E)