

BRUNSWICK SURVEY
PART OF THE SW 1/4 OF NW FRACTIONAL 1/4 OF
SECTION 19, T7S, R4E,
JACKSON TWP, AUGLAIZE COUNTY, OHIO

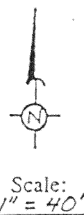

0 25 50 100

Bearings are Assumed

Clarence J. & Velma E.
Bruns
Vol. 197 Pg. 717
57.44 Ac.

Paul J. & Velma H.
Walters
Vol. 259 Pg. 84

AREA SURVEYED
1.073 Ac.

Paul J. & Velma H.
Walters
Vol. 193 Pg. 84

1.073 Ac. Total
0.073 Ac. Road R/W
1.000 Ac. Net

West Quarter Corner

N 0°-39'-00" E 292.25'

S 0°-39'-00" W 292.25'

Existing R/W

SE Corner of NW Quarter

1/2 Section Line &
Heitkamp Rd.
EAST 800.84' WEST 160.00'

Location Map

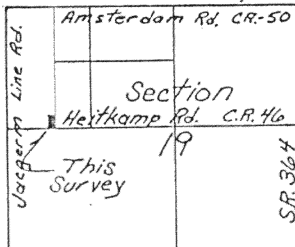

~LEGEND~

- Iron Pin Set
- ⊗ R.R. Spike Set
- Monument Box

SURVEYED SEPTEMBER 5, 1990

By ALVIN J. SPRALEY
NORTH STAR, OHIO
REGISTERED SURVEYOR NO. 5016
Field work by Steven H. Kremer, S.I.T.

Signature by a representative of the County Health Dept. denotes compliance with Health Regulations.
Signed: _____ Date _____

Signature by a representative of the Auglaize County Regional Planning Commission denotes approval of this plat.
Signed: _____ Date _____

Signature by a representative of City with 3 mile limit jurisdiction or Twp. Trustees or Village with zoning jurisdiction denotes approval of this plat. Signed: _____ Date _____
for political S.D. of: _____

Signature by a representative of the County Engineer's Dept. denotes that this plat meets tax map plat requirements.
Signed: _____ Date _____

Client Allen Brunswick
County Auglaize Twp. Jackson Sec. 19
Drawn by Steven H. Kremer Scale 1" = 40' Drwg. No. _____
Checked by A. J. SPRALEY Date 9-7-90
Sheet 1 of 1 J- 504 (T 7 S 4 E)

Description for deed for Clarence J. Bruns, Grantor.

Real Estate situated in Jackson Township, Auglaize County, State of Ohio and bounded and described as follows:

Being a tract in the southwest quarter of the northwest fractional quarter of Section 19, Town 7 South, Range 4 East, commencing at the quarter corner marker in a monument box at the southwest corner of said fractional quarter section; thence Due East along the half section line ~~800.84~~ feet to a railroad spike for the true point of beginning; thence North 0° 39' 00" East 292.25 feet to an iron pin; thence Due East 160.00 feet to an iron pin; thence South 0° 39' 00" West 292.25 feet to a railroad spike on the half section line; thence Due West 160.00 feet along the half section line and centerline of Heitkamp Road to the point of beginning containing 1.073 acres of land more or less.

Said tract being subject to highways and any other easement or restriction of record.

Previous Deed Reference: Volume 197 Pages 716-718

Description from survey made on September 5, 1990 by A. J. Spraley, Registered Surveyor No. 5016.