

LEGEND:

- △A ~ ODOT Conc. Monu. @ SW Corner SE 1/4 Sec. 33, Union Twp.
- △B ~ ODOT Conc. Monu @ NW Corner NE 1/4 Sec. 4, Clay Twp.
- c ~ Capped 5/8" rebar set
- d ~ Iron Pin found @ SE Corner SE 1/4 Sec. 33, Union Twp.
- △E ~ RR Spike @ NE Corner NE 1/4 Sec. 4, Clay Twp.
- F ~ RR Spike set
- △G ~ RR Spike fd. @ NW Corner SW 1/4 SE 1/4 Sec. 4
- △H ~ Concrete Corner Post fd
- △I ~ Monu. Box @ SW Corner NE 1/4 Sec. 4, Clay Twp.
- oj ~ 4" Steel Post in Conc. found @ SE Corner NE 1/4 Sec. 4, Clay Twp.

LOCATION MAP

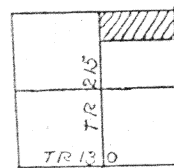

SECTION 4
Clay Township
T-6-S, R-7-E
Auglaize County,
Ohio.

Signature by a representative of the County Health Dept.
denotes compliance with Health Regulations.
Signed: _____ Date: _____

Signature by a representative of the Auglaize County Regional
Planning Commission denotes approval of this plat.
Signed: _____ Date: _____

Signature by a representative of City with 3 mile limit juris-
diction or Twp. Trustees or Village with zoning jurisdiction
denotes approval of this plat. Signed: _____ Date: _____
for political S. D. of: _____

Signature by a representative of the County Engineer's Dept.
denotes that this plat meets tax map plat requirements.
Signed: _____ Date: _____

KUCK and MORRISSEY, INC.
CONSULTING ENGINEERS & SURVEYORS
LIMA, OHIO 45805
TELEPHONE 228-1735 - AREA CODE 419
2807 CHAPEL HILL DRIVE

Client John SETTLAGE to Keith BENDER
County Auglaize Twp. Clay Sec. 4
Drawn by RDM Scale 1"=400' Drwg. No. _____
Checked by rdm Date 4/12/94
Sheet 1 of 2 J-599 (T-6-S; R-7-E)

DESCRIPTION
PARCEL NO. 1

Being a parcel of land situate in the north half of the Northeast quarter of Section 4, T-6-S, R-7-E, Clay Township, Auglaize County, Ohio and more particularly described as follows:

BEGINNING at a ODOT concrete monument found at the northwest corner of said Northeast quarter of said Section 4; thence S 89°59'07" E with the north line of said Northeast quarter, 1,460.33 feet to a 5/8 inch rebar set; thence S 00°45'42" E, 455.02 feet to a 5/8 inch rebar set; thence N 87°53'56" E, 589.82 feet to a 5/8 inch rebar set; thence N 00°35'58" E, 433.22 feet to a 5/8 inch rebar set on the north line of said Northeast quarter of said Section 4; thence S 89°59'07" E with said north line, 398.60 feet to an iron pin found at the southeast corner of the Southeast quarter of Section 33, T-5-S, R-7-E, Union Township; thence S 89°11'40" E continuing with the north line of said Northeast quarter of said Section 4, 203.45 feet to an railroad spike at the northeast corner of said Northeast quarter; thence S 00°35'58" W with the east line of said Northeast quarter, 653.44 feet to a 5/8 inch rebar set; thence N 89°55'29" W, 2,660.26 feet to a railroad spike set on the west line of said Northeast quarter of said Section 4; thence N 00°24'53" E with said west line, 653.43 feet to the PLACE OF BEGINNING containing 33.937 acres more or less and subject to all highway and other legal easements of record.

DESCRIPTION
PARCEL NO. 2

Being a parcel of land situate in the north half of the Northeast quarter of Section 4, T-6-S, R-7-E, Clay Township, Auglaize County, Ohio and more particularly described as follows:

Commencing at a ODOT concrete monument found at the northwest corner of said Northeast quarter of said Section 4; thence S 89°59'07" E with the north line of said Northeast quarter, 1,460.33 feet to a 5/8 inch rebar set and the PLACE OF BEGINNING; thence S 00°45'42" E, 455.02 feet to a 5/8 inch rebar set; thence N 87°53'56" E, 589.82 feet to a 5/8 inch rebar set; thence N 00°35'58" E, 433.22 feet to a 5/8 inch rebar set on the north line of said Northeast quarter of said Section 4; thence N 89°59'07" W with said north line, 600.00 feet to the PLACE OF BEGINNING containing 6.063 acres more or less and subject to all highway and other legal easements of record.

I hereby certify the accompanying map and survey which it represents to be correct to the best of my knowledge and belief. All rebar set and called for are topped with a plastic Peramark cap stamped: KUCK & MORRISEY L.S. 6470.

Date: 4/12/94

Richard D. Morrissey, L.S. 6470
Kuck and Morrissey, Inc.

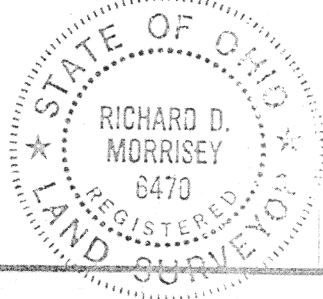

Signature by a representative of the County Health Dept. denotes compliance with Health Regulations.
Signed: _____ Date: _____

Signature by a representative of the Auglaize County Regional Planning Commission denotes approval of this plat.
Signed: _____ Date: _____

Signature by a representative of City with 3 mile limit jurisdiction or Twp. Trustees or Village with zoning jurisdiction denotes approval of this plat. Signed: _____
for political S. D. of: _____ Date: _____

Signature by a representative of the County Engineer's Dept. denotes that this plat meets tax map plat requirements.
Signed: _____ Date: _____

KUCK and MORRISEY, INC.
CONSULTING ENGINEERS & SURVEYORS
LIMA, OHIO 45805
TELEPHONE 228-1735 - AREA CODE 419
2607 CHAPEL HILL DRIVE

Client John SETTLAGE to Keith BENDER
County Auglaize Twp. Clay Sec. 4
Drawn by RDM Scale 1"=400' Drwg. No. _____
Checked by rdm Date 4/12/94
Sheet 2 of 2 J-600 (T-6-S; R-7-E)