

LOCATION SKETCH

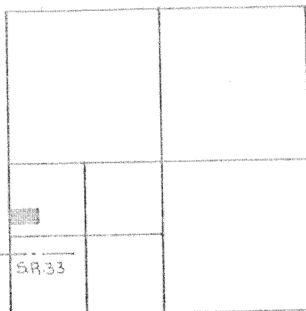

SECTION 31

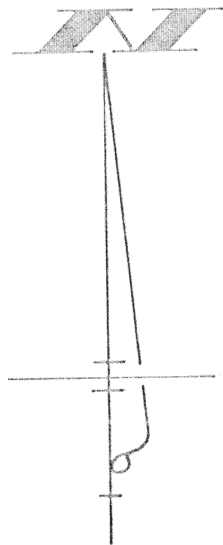

LEGEND

- "A" = IRON BAR IN MON. BOX (OVER COR STONE).
- "B" = COR. STONE IN MON. BOX.
- = MINE SPIKE SET.
- = 5/8" x 30" IRON BAR SET.

W. LINE ~ N.W. 1/4 ~ S.W. 1/4 ~ SEC. 31 & 2 C.R. 71
N. 01° 19' 05" E. ~ 1324.65

W. 1/4 POST ~ SEC. 31

SURVEYED BY

Gordon L. Geeslin

GORDON L. GEESLIN, P.S. 5372

NOTE

REFERENCE IS MADE TO A 7/14/12 SURVEY BY C. STIMMEL. STIMMEL'S SURVEY DID NOT MATHEMATICALLY CLOSE BY 33.89 E. & W. IN MY OPINION, THIS EXPLAINS THE DIFFERENCE IN DIST. ON THE S. LINE.

8.362 ACRES

S. 88° 57' 49" E. ~ 1080.34

1080.43

N. 89° 26' 06" W. ~ 2362.60
(STIMMEL'S DIST. 2395.18, SEE NOTE)

STA 378+80
220.0(L)
(SET BY S.R. 33 R/W PLANS)

ZWIEBEL SURVEY

PART ~ N.W. 1/4 ~ S.W. 1/4 ~ SECTION 31, T. 5 S.,
R. 5 E., (MOULTON TOWNSHIP), AUGLAIZE
COUNTY, OHIO.

AUGUST 6, 1993

SCALE 1" = 200'



PERMANENT
PARCEL NO.

Part of: Sec. T R Township
Grantor: Area Retained: Acres
Grantee: Area Transferred: Acres
Deed References:

APPROVALS
AGENCY Board of Health
DATE

J-696

GORDON L. GEESLIN

LAND SURVEYOR

810 EAST MARKET STREET

CELINA, OHIO

PHONE (419) 586-6155

GORDON L. GEESLIN

REGISTERED LAND SURVEYOR

PHONE 419-586-6155

August 6, 1993

ZWIEBEL SURVEY DESCRIPTION

Being a parcel of land situated in Moulton Township, Auglaize County, Ohio, in the northwest quarter of the southwest quarter of Section 31, Township 5 South, Range 5 East. Being more particularly described as follows:

Commencing for reference at an iron bar in a monument box at the southwest corner of the northwest quarter of the southwest quarter of said Section 31-

Thence, north $01^{\circ}19'05''$ east, along the west line of the northwest quarter of the southwest quarter of said Section 31 and the centerline of County Road 71, a distance of two hundred fifty-four and $78/100$ (254.78) feet to a mine spike. Said point being the place of beginning for the parcel to be conveyed by this instrument-

Thence, continuing, north $01^{\circ}19'05''$ east, along the last described line, a distance of three hundred forty-one and $63/100$ (341.63) feet to a mine spike-

Thence, south $88^{\circ}57'49''$ east, a distance of one thousand eighty and $34/100$ (1080.34) feet to a $5/8$ inch iron bar-

Thence, south $01^{\circ}19'05''$ west, a distance of three hundred thirty-two and $74/100$ (332.74) feet to a $5/8$ inch iron bar in the north line of a 8.56 acre tract of land as surveyed by Clayton H. Stimmel on July 14, 1972-

Thence, north $89^{\circ}26'06''$ west, along said north line of an 8.56 acre tract of land, a distance of one thousand eighty and $43/100$ (1080.43) feet to the place of beginning.

Containing 8.362 acres of land more or less.

Subject to all easements and right-of-way of record.

Reference is made to a survey of this area by Gordon L. Geeslin, Registered Surveyor 5372, dated August 6, 1993, on file in the County Engineer's Office.

Surveyed by

Gordon L. Geeslin

Gordon L. Geeslin

Registered Surveyor 5372