

- STARTING BEARING; $N 87^{\circ} 31' 00'' E$,
THE SOUTH LINE OF THE S.E. QUARTER
OF SECTION 10, TOWN 7S, RANGE 4E
BASED ON AN ASSUMED MERIDIAN AND
USED TO DENOTE ANGLES ONLY.

THE NORTH RIGHT-OF-WAY LINE OF MONROE STREET:
THE WIDTH PRESENTLY ACCEPTED IS SET FORTH IN
ORDINANCE NO 243 OF THE VILLAGE OF NEW FOREMEN;
SEE PLAT BOOK 1, PAGE 372; THE SOUTH BUILDING
LINES CONSTITUTE THE NORTH LINE OF MONROE STREET.

OF
THE ORIGINAL PLAT OF NEW BREMEN
S.E. QUARTER, SECTION 10, TOWN 7 S, RANGE 4 E
SOUTH & EAST OF THE FIRST PRINCIPAL MERIDIAN
VILLAGE OF NEW BREMEN
GERMAN TOWNSHIP AUGLAIZE COUNTY
STATE OF OHIO

CROWN EQUIPMENT CORP.
40 S. WASHINGTON STREET NEW BREMEN, OHIO 45869
BY

ARCHITECTS/ENGINEERS
SIDNEY, OHIO 45365

REGISTERED SURVEYOR #4079
REGISTERED SURVEYOR #7108

MAY 1994



0 10 20 30 40

SCALE IN FEET

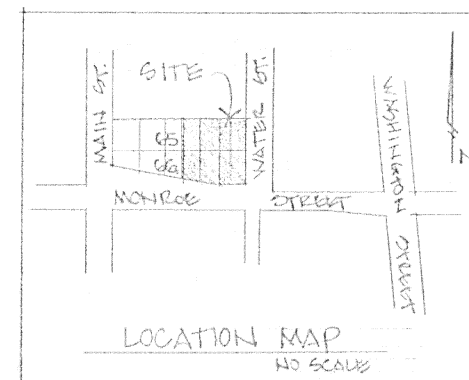

(MASONRY NAIL FOUND (OVER IRON PIN)
AT S.E. CORNER, SOUTHEAST QUARTER,
SECTION 10, TOWN 7S, RANGE 4E

5-701

MAY 20, 1994
MICHAEL R. HOLT REGISTERED SURVEYOR #7108

REFERENCE - PLAT OF SURVEY OF LOTS 65 & 66,
SURVEY BOOK "G", PAGE 799.

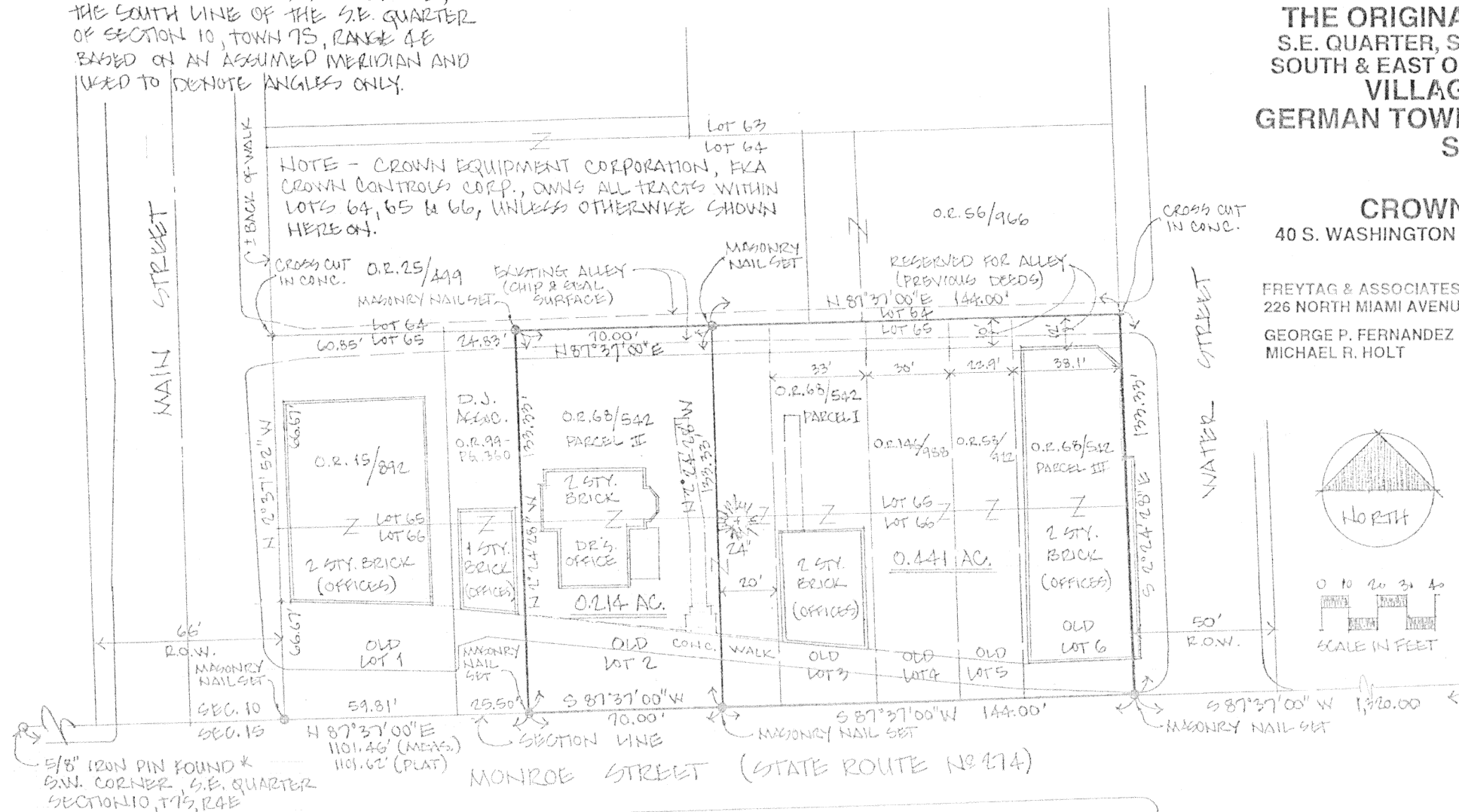

LEGAL DESCRIPTION
FOR
EAST PART OF LOTS 65 & 66
IN THE VILLAGE OF NEW BREMEN

Situate in the eastern part of Inlots 65 and 66 (new numbers) of the Original Plat of New Bremen, as recorded in Deed Book "B", Page 284 of the records of Mercer County, Ohio, and being formerly known as Lots 2,3,4,5 and 6 of the division of said Inlots 65 & 66 in the Village of New Bremen, the southeast quarter of Section 10, Town 7 South, Range 4 East, South and East of the First Principal Meridian, German Township, Auglaize County, State of Ohio, and being more particularly described as follows, to-wit:

Commencing at a 5/8 inch iron pin found at the southwest corner of the southeast quarter of said Section 10, said point being in the westbound lane of Monroe Street (State Route No.274) ;

thence, North 87 degrees 37' 00" East, 1171.46 feet along the south line of the southeast quarter of said Section 10 to a masonry nail set, said point being the place of beginning of the herein described tract and, also, being 20 feet west from the southeast corner of Old Lot 2, described as Parcel II in Official Record 68, Page 542 of the records of Auglaize County;

thence, North 2 degrees 24' 28" West, 133.33 feet to a masonry nail set on the north line of aforesaid Inlot 65, and the northwest corner of the herein described tract;

thence, North 87 degrees 37' 00" East, 144.00 feet to a cross cut in the concrete drive at the northeast corner of said Inlot 65 and, also, the west right-of-way line of Water Street;

thence, South 2 degrees 24' 28" East, 133.33 feet along the west right-of-way line of Water Street to a masonry nail set at the southeast corner of said Inlot 65, and on the south line of the southeast quarter of aforesaid Section 10;

thence, South 87 degrees 37' 00" West, 144.00 feet along the south line of the southeast quarter of said Section 10 to the place of beginning.

Containing 0.441 acre (19,199.94 square feet), more or less.

Subject to the right-of-way of Monroe Street (State Route No.274) and, also, to a 10 feet wide strip along the north side of former lots 2, 3, 4 and 5, and a 12 feet wide strip along the north side of former lot 6, both of which were reserved for use as an alley (see previous deeds).

Being the same tracts conveyed to Crown Equipment Corporation by deeds recorded in Official Record 58, Page 922 (all of Old Lot 5), Official Record 146, Page 988 (all of Old Lot 4), and Official Record 68, Page 542 (all of Parcel I, Old Lot 3; 20 feet off the east side of Parcel II, Old Lot 2; and all of Parcel III, Old Lot 6), all in the records of Auglaize County, Ohio.

Reference a plat of survey of Inlots 65 & 66 filed in Survey Book "G", Page 799 of the records of the Auglaize County Engineer (Tax Map office).

The above description prepared by Michael R. Holt, Registered Surveyor No.7108, of Freytag and Associates, Inc., 226 North Miami Avenue, Sidney, Ohio, from a field survey performed by same on May 20, 1994.

J-702

LEGAL DESCRIPTION
FOR
CENTRAL PART OF LOTS 65 & 66
IN THE VILLAGE OF NEW BREMEN

Situate in the central part of Inlots 65 and 66 (new numbers) of the Original Plat of New Bremen, as recorded in Deed Book "B", Page 284 of the records of Mercer County, Ohio, and being formerly known as Lot 2 of the division of said Inlots 65 & 66 in the Village of New Bremen, the southeast quarter of Section 10, Town 7 South, Range 4 East, South and East of the First Principal Meridian, German Township, Auglaize County, State of Ohio, and being more particularly described as follows, to-wit:

Commencing at a 5/8 inch iron pin found at the southwest corner of the southeast quarter of said Section 10, said point being in the westbound lane of Monroe Street (State Route No.274) ;

thence, North 87 degrees 37' 00" East, 1101.46 feet along the south line of the southeast quarter of said Section 10 to a masonry nail set, said point being the place of beginning of the herein described tract and, also, being 90 feet west of the southeast corner of Old Lot 2, described as Parcel II in Official Record 68, Page 542 of the records of Auglaize County;

thence, North 2 degrees 24' 28" West, 133.33 feet to a masonry nail set on the north line of aforesaid Inlot 65, and the northwest corner of the herein described tract;

thence, North 87 degrees 37' 00" East, 70.00 feet along the north line of said Inlot 65 to a masonry nail set at the northeast corner of the herein described tract;

thence, South 2 degrees 24' 28" East, 133.33 feet to a masonry nail set on the south line of the southeast quarter of aforesaid Section 10;

thence, South 87 degrees 37' 00" West, 70.00 feet along the south line of the southeast quarter of said Section 10 to the place of beginning.

Containing 0.214 acre (9,333.10 square feet), more or less.

Subject to the right-of-way of Monroe Street (State Route No.274) and, also, to a 10 feet wide strip along the north side of former lot 2 which was reserved for use as an alley (see previous deeds).

Being part of the same tract conveyed to Crown Equipment Corporation by deed recorded in Official Record 68, Page 542 (Parcel II, Old Lot 2), in the records of Auglaize County, Ohio.

Reference a plat of survey of Inlots 65 & 66 filed in Survey Book "G", Page 799 of the records of the Auglaize County Engineer (Tax Map office).

The above description prepared by Michael R. Holt, Registered Surveyor No.7108, of Freytag and Associates, Inc., 226 North Miami Avenue, Sidney, Ohio, from a field survey performed by same on May 20, 1994.

J-703