

# Survey for Evelyn Minnich

Part of Section 21, Clay Township,  
Town-6-South, Range-7-East, Auglaize County, and  
Part of Outlots 6 and 10, Village of Geyer, Ohio  
Containing 6.384 Acres

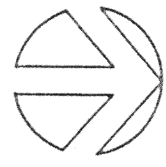

Scale



## Legend

- Iron Pin (set)
- Iron Pin (found)
- △ Corner Stone (found)
- ▲ Railroad Spike (found)
- ◻ Wooden End Post (found)

## Vicinity Map

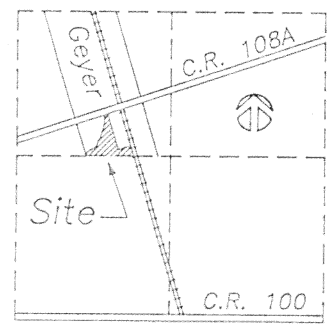

## Section 21 Clay Township

Attest:

*Ted K. Schnell*

Ted K. Schnell  
Professional Engineer  
Professional Surveyor

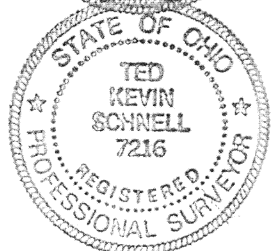
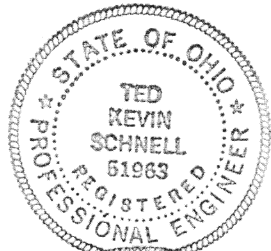

West line of Section 21  
Clay Township

N.87°-16'-33"E.  
1,004.90'

Indian Treaty Boundary Line  
and South line of the Village  
of Geyer, Ohio

N.13°-45'-30"E.  
192.66'

N.53°-42'-10"E.  
237.70'

N.29°-52'-46"E.  
65.16'

N.18°-11'-40"E.  
216.50'

N.14°-22'-37"E.  
188.62'

S.20°-10'-00"E.  
660.00'

N.71°-00'-00"E.  
20.37'

N.71°-00'-00"E.  
198.00'

S.20°-10'-00"E.  
194.09'

S.87°-16'-33"W.  
886.22'

# 6.384 Acres

Previous Deed  
Volume 246, Page 8

Outlot 7  
Deed Volume OR10, Page 649

Grand Trunk Western Railroad (66')

Iron Bar (found)  
8" Deep

Elm Street (60')

Railroad Spike (found)  
6" deep

Pike Street (60')

## Note

There will exist a 40' wide easement to Auglaize County for the purpose of maintaining the Pusheta Ditch (tile and waterway). No structures, buildings, or fences shall be constructed within this area.

## Previous Surveys

Kuck & Morrissey	Book H, Page 503	1/18/88
Kuck & Morrissey	Book H, Page 505	5/24/88
Thomas Kuck	Book C, Page 364	4/13/77
J.H. Meyer	Book 3, Page 219	4/15/12

Ted K. Schnell Professional Engineer Professional Surveyor			
REVISIONS			Minnich to Jarrels Survey
NO.	DATE	BY	
1			Part of Sec 21, Clay Twp.
2			
3			DRAWN BY Kevin SCALE Shown
4			
5			DATE 7/06/94
CHECKED Greg			DRAWING NO.
TRACED			1 OF 2

K-5A

Civil Engineering  
Land Surveying

R.R. No. 3  
11873 Glynnwood Road  
Wapakoneta, Ohio 45895  
phone - (419) 738-4758

Ted Kevin Schnell  
Registered Professional Engineer  
Registered Professional Surveyor

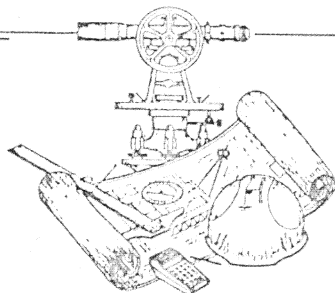

client MINNICH TO JARRELS  
county AUGLAIZE township CLAY  
section 21 T- 6 -S, R- 7 -E  
drawn by KEVIN date 7/6/94  
checked by GREG sheet 2 of 2

SURVEYOR'S DESCRIPTION  
6.384 ACRE PARCEL

THE FOLLOWING DESCRIBED PARCEL OF LAND IS SITUATED IN THE NORTHWEST QUARTER OF SECTION 21, CLAY TOWNSHIP, TOWN-6-SOUTH, RANGE-7-EAST, AUGLAIZE COUNTY, AND IS ALSO A PART OF OUTLOTS 6 AND 10 OF THE VILLAGE OF GEYER, OHIO, SAID PARCEL BEING MORE PARTICULARLY DESCRIBED AS FOLLOWS:

COMMENCING FOR REFERENCE AT A CORNER STONE (FOUND) AT THE INTERSECTION OF THE OLD INDIAN TREATY BOUNDARY LINE WITH THE WEST LINE OF THE NORTHWEST QUARTER OF SECTION 21, CLAY TOWNSHIP, TOWN-6-SOUTH, RANGE-7-EAST, AUGLAIZE COUNTY, OHIO;

THENCE WITH A BEARING OF N. 87°-16'-33" E. ALONG THE OLD INDIAN TREATY BOUNDARY LINE, PART OF THE SAME BEING THE SOUTH LINE OF OUTLOT 10 OF THE VILLAGE OF GEYER, OHIO, FOR A DISTANCE OF 1,004.90 FEET TO AN IRON PIN (SET) AND THE PLACE OF BEGINNING;

THENCE WITH A BEARING OF N. 13°-45'-30 E. ALONG THE CENTERLINE OF THE PUSHETA COUNTY DITCH WATERWAY FOR A DISTANCE OF 192.66 FEET TO AN IRON PIN (SET);

THENCE WITH A BEARING OF N. 53°-42'-10 E. ALONG THE CENTERLINE OF THE PUSHETA COUNTY DITCH WATERWAY FOR A DISTANCE OF 237.70 FEET TO AN IRON PIN (SET);

THENCE WITH A BEARING OF N. 18°-11'-40 E. ALONG THE CENTERLINE OF THE PUSHETA COUNTY DITCH WATERWAY FOR A DISTANCE OF 216.50 FEET TO AN IRON PIN (SET);

THENCE WITH A BEARING OF N. 14°-22'-37 E. ALONG THE CENTERLINE OF THE PUSHETA COUNTY DITCH WATERWAY FOR A DISTANCE OF 188.62 FEET TO AN IRON PIN (SET) ON THE SOUTHERLY RIGHT-OF-WAY LINE OF PIKE STREET;

THENCE WITH A BEARING OF S. 71°-00'-00" E. ALONG THE SOUTHERLY RIGHT-OF-WAY LINE OF PIKE STREET FOR A DISTANCE OF 20.37 FEET TO AN IRON PIN (FOUND);

THENCE WITH A BEARING OF S. 20°-10'-00" E. ALONG THE WESTERLY LINE OF OUTLOT 7 FOR A DISTANCE OF 660.00 FEET TO AN IRON PIN (FOUND);

THENCE WITH A BEARING OF N. 71°-00'-00" E. ALONG THE SOUTHERLY LINE OF OUTLOT 7 FOR A DISTANCE OF 198.00 FEET TO AN IRON PIN (FOUND) ON THE WESTERLY LINE OF THE GRAND TRUNK RAILROAD;

THENCE WITH A BEARING OF S. 20°-10'-00" E. ALONG THE WESTERLY LINE OF THE GRAND TRUNK RAILROAD FOR A DISTANCE OF 194.09 FEET TO A POINT, SAID POINT BEING REFERENCED BY A WOODEN END POST AT S. 87°-16'-33" W. AT A DISTANCE OF 1.03 FEET;

THENCE WITH A BEARING OF S. 87°-16'-33" W. ALONG THE OLD INDIAN TREATY BOUNDARY LINE, PART OF THE SAME BEING THE SOUTH LINE OF OUTLOT 10 OF THE VILLAGE OF GEYER, OHIO, FOR A DISTANCE OF 886.22 FEET TO AN IRON PIN (SET) AND THE PLACE OF BEGINNING;

CONTAINING IN ALL 6.384 ACRES OF LAND SUBJECT TO ALL LEGAL EASEMENTS, RESERVATIONS, OR RESTRICTIONS, IF ANY UPON SAID PREMISES. PREVIOUS DEED REFERENCES: DEED VOLUME 246, PAGE 8, AUGLAIZE COUNTY RECORDER'S OFFICE.

A 40 FOOT WIDE COUNTY DITCH EASEMENT EXISTS UPON THE ABOVE DESCRIBED PARCEL OF LAND PARALLEL WITH AND ADJACENT TO THE WESTERLY BOUNDARY OF SAID PARCEL FOR THE PURPOSE OF THE PERMANENT MAINTENANCE OF THE PUSHETA SINGLE COUNTY DITCH (TILE AND WATERWAY) UNDER THE JURISDICTION OF THE AUGLAIZE COUNTY COMMISSIONERS.

PREPARED BY:

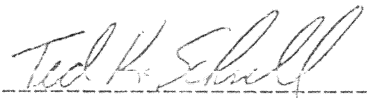
  
TED K. SCHNELL  
PROFESSIONAL ENGINEER  
PROFESSIONAL SURVEYOR

K-6

