

Site	

2. COUNTRY RD. 103. Δ (MOULTON ΔNGLE)

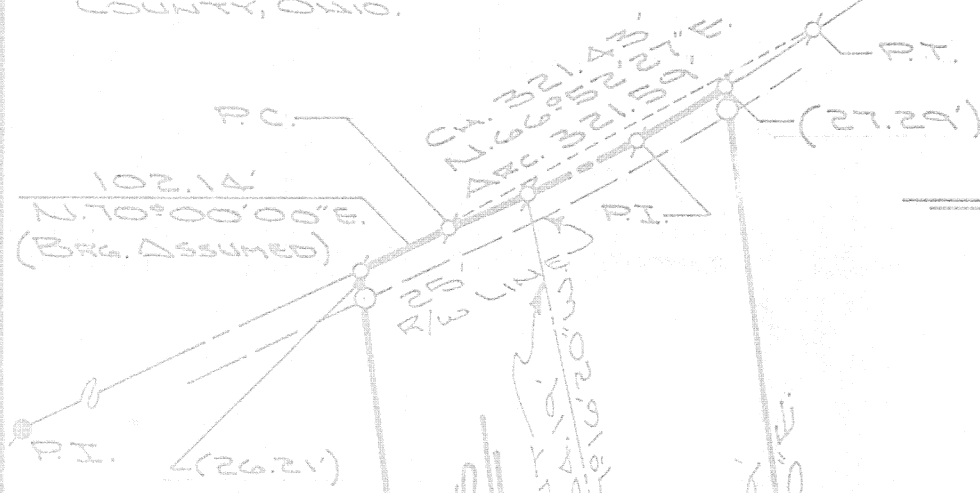

$\Delta = 8^{\circ}19'40''$
 $E = 7.80'$
 $T = 214.56'$
 $R = 2,947.24'$
 $D_c = 1^{\circ}56'39''$
 $l = 428.37$
 $C_u = 428.00'$

☐ IRON PIN SET
☒ IRON PIN FD. (SET PRO.)
☐ P.K. NAIL SET
☒ IRON PIN FOUND

THIS PLAT IS RECORDED IN
SURVEY BOOK "K", PAGE 157,
IN THE DUGLAIZE COUNTY
ENGINEER'S OFFICE.

ATTEST: John W. Souvert
JOHN W. SOUVERT
PROFESSIONAL
SURVEYOR No 6920

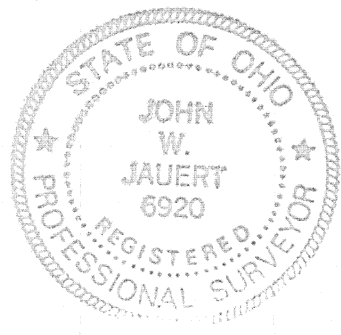

Janert

ASSOCIATES

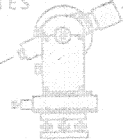

Surveying

RT.3 BOX 449 WAPAKONETA, OHIO 45895
PH. (419) 738-8962

Client EDDINGFIELD SURVEY
County AUGLAIZE Township WASHINGTON
Section 20 T. 6 S., R. 5 E. Drwg. No. 95-1037
Drawn By J. BAUERT Date OCT. 1995
Scale 1"=200' Sheet 1 of 2

SURVEYOR'S DESCRIPTION FOR 8.67 ACRE TRACT



The following described tract of land is part of the West half of Section 20, Town 6 South, Range 5 East, Washington Township, Auglaize County, Ohio and is more particularly described as follows:

Commencing at an iron pin found at the Southeast corner of the Northwest Quarter of Section 20, Washington Township;

thence N.86°32'50"W. a distance of 510.59 feet to a point in the center of a farm bridge, which is the PLACE OF BEGINNING for the tract of land herein described;

thence S.49°49'27"W. along the centerline of the Center Branch Creek, a distance of 343.34 feet to a point;

thence N.02°31'30"W. a distance of 1,022.46 feet to a P.K. nail set, passing thru an iron pin set for reference at 48.00 feet on the top of the bank of the Center Branch Creek, also passing thru an iron pin set for reference at 996.25 feet in the Southerly Right-of-Way line of County Road 103-A (Moulton Angle Road);

thence N.70°00'00"E. along the centerline of County Road 103-A, a distance of 102.14 feet to a P.K. nail set at the P.C. of a curve to the left with the following curve data: A = 8°19'40", R = 2,947.24 feet, E = 7.80 feet and T = 214.56 feet;

thence along the curved centerline of County Road 103-A, an arc distance of 321.59 feet, the chord of which bears N.66°52'27"E., a distance of 321.43 feet to a P.K. nail set;

thence S.02°31'30"E. a distance of 949.79 feet to a point, passing thru an iron pin set for reference at 27.29 feet in the Southerly Right-of-Way line of County Road 103-A, also passing thru an iron pin set for reference at 912.80 feet on top of the bank of the Center Branch Creek;

thence N.54°16'05"W. along the centerline of the Center Branch Creek, a distance of 12.97 feet to a point;

thence S.87°13'27"W. along the centerline of the Center Branch Creek, a distance of 71.59 feet to a point;

thence S.69°34'53"W. along the centerline of the Center Branch Creek, a distance of 46.96 feet to a point in the center of a farm bridge that was the true PLACE OF BEGINNING;

Containing in all 8.67 acre of which 0.24 acre has been dedicated for highway purposes, 8.16 being located in the Northwest Quarter and 0.51 acre being located in the Southwest Quarter of Section 20, Washington Township. The above described tract of land is subject to all legal easements, restrictions and reservations, if any, of record or in use on said premises. Previous deed references: Volume OR 230, page 703. This plat is recorded in Survey Book "K", page 157, in the Auglaize County Engineer's Office.

The following described tract of land is part of the West half of Section 20, Town 6 South, Range 5 East, Washington Township, Auglaize County, Ohio and is the centerline of a 24 foot wide agricultural easement being more particularly described as follows:

Commencing at an iron pin found at the Southeast corner of the Northwest Quarter of Section 20, Washington Township;

thence N.86°32'50"W. a distance of 510.59 feet to a point in the center of a farm bridge, which is the PLACE OF BEGINNING for the tract of land herein described;

thence N.09°55'06"W. along the centerline of a 24 foot wide easement, a distance of 391.94 feet to a point;

thence N.07°16'20"W. along the centerline of a 24 foot wide easement, a distance of 484.19 feet to a point in the centerline of County Road 103-A (Moulton Angle Road), passing thru a P.K. nail set for reference at 482.83 feet and there to terminate.

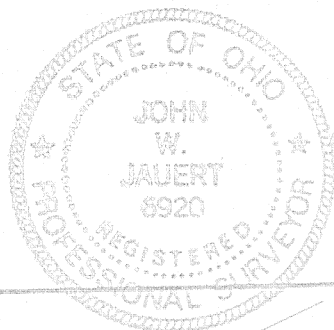

ATTEST:

John W. Jauert
Professional Surveyor No. 6920

Jauert
ASSOCIATES



Surveying
AND LAND CONSULTING

RT.3 BOX 449 WAPAKONETA, OHIO 45895
PH. (419) 738-8962

Client EDDINGFIELD SURVEY
County AUGLAIZE Township WASHINGTON
Section 20 T. 6 S., R. 5 E. Drwg. No. 95-1037
Drawn By _____ Date OCT. 1995
Scale _____ Sheet 2 of 2