



Scale:
1" = 100'

SR 119

Ed. Dirksen
OR 116 Pg. 783

S 88° 56' 00" W

611.34' to E Lot 4

Lot 3

2,801 Ac.

N 88° 56' 00" E

608.92' to E

1,511 Ac.

N 88° 56' 00" E 290.44'

Tim Grow
OR 74 Pg. 477
Plat 200 L "C" Pg. 88

DUE NORTH
150.00'

316.30'
N 88° 56' 00" E

290.44' to E
South Line Lot N° 3

91° 04' 00" W
150.00'

CANAL RD.
C-45
652.22'

No recorded E/W

Seventh St.

Plat References
Engineer's Book "C" Pg. 88
Plat Vol. 1 Pg. 121



William G. Fultz, Jr.
P.S. 5173

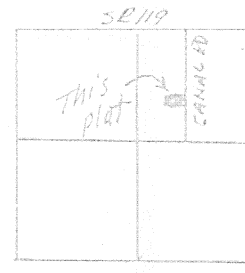

- ⊗ = P.K. Nail fd.
- ⊗ = P.K. Nail set
- = I.P. fd.
- = Steel Corner Post
- = 3/8" Rebar set

Signature by a representative of the County Health Dept.
denotes compliance with Health Regulations.
Signed: _____ Date: _____

Signature by a representative of the Auglaize County Regional
Planning Commission denotes approval of this plat.
Signed: _____ Date: _____

Signature by a representative of City with 3 mile limit juris-
diction or Twp. Trustees or Village with zoning jurisdiction
denotes approval of this plat. Signed: _____
for political S. D. of: _____ Date: _____

Signature by a representative of the County Engineer's Dept.
denotes that this plat meets tax map plat requirements.
Signed: _____ Date: _____

Client Ed Dirksen & Mark & Laura Becker
County Auglaize Twp. Jackson Sec. 27
Drawn by _____ Scale 1" = 100' Drwg. No. _____
Checked by _____ Date 16 Dec 1995
Sheet 1 of 1 K-187 (T 7 S; R 4 E)

WILLIAM G. FULTZ, JR.
Professional Surveyor
819 Lori Court
Sidney, Ohio 45365
(513) 492-9674

DIRKSEN - GROW DESCRIPTION

Part of the NE 1/4 of Sec.27, T7S, R4E,
Jackson Twp., Auglaize Co., Ohio:

Commencing at a P.K. Nail found on the south line of Lot No. 3 of the Third Addition to the Village of Minster as recorded in Plat Book 1 Pg. 121 of the Auglaize Co. Plat Records and in the center of Canal Rd., said P.K. Nail also being at the southeast corner of the Tim Grow premises as recorded in O.R. 74 Pg. 477; Thence Due North, along said center 150.00 ft. to a P.K. Nail found in the northeast corner of said Tim Grow premises and the place of beginning for the following described real estate:

Thence continuing Due North, along said center, 30.00 ft. to a P.K. Nail;

Thence $S88^{\circ}-56'-00''W$, 608.92 ft. to an iron pin on the east line of the Norfolk and Western RR., passing for reference an iron pin set at 15.00 ft.;

Thence $S00^{\circ}-41'-36''E$, along said east line, 179.97 ft. to a corner post on the south line of the aforesaid Lot No. 3;

Thence $N88^{\circ}-56'-00''E$, along said south line, 316.30 ft. to an iron pin in the southwest corner of the aforesaid Grow premises;

Thence Due North, along the west line of said Grow premises, 150.00 ft. to an iron pin in the northwest corner of said premises;

Thence $N88^{\circ}-56'-00''E$, along the north line of said Grow premises, 290.44 ft. to the place of beginning, passing for reference an iron pin found at 275.44 ft.

Containing 1.511 Ac. more or less, being subject to all legal highways and easements of record, and being part of the premises recorded in O.R. 116 Pg. 783 of the Auglaize Co. Deed Records.

Plat recorded in Vol. Pg.



William G. Fultz, Jr.
Reg. Surveyor No. 5173
16 Dec. 1995

K-188

WILLIAM G. FULTZ, JR.
Professional Surveyor
819 Lori Court
Sidney, Ohio 45365
(513) 492-9674

DIRKSEN - BECKER DESCRIPTION

Part of the NE 1/4 of Sec. 27, T7S, R4E,
Jackson Twp., Auglaize Co., Ohio:

Commencing at a P.K. Nail found on the south line of Lot No. 3 of the Third Addition to the Village of Minster as recorded in Plat Book 1 Pg. 121 of the Auglaize Co. Plat Records and in the center of Canal Rd., said P.K. Nail also being at the southeast corner of the Tim Grow premises as recorded in O.R. 74 Pg. 477; Thence Due North, along said center 180.00 ft. to a P.K. Nail and the place of beginning for the following described real estate:

Thence continuing Due North, along said center, 200.00 ft. to a P.K. Nail;

Thence S88°-56'-00"W, 611.34 ft. to an iron pin on the east line of the Norfolk and Western R.R., passing for reference an iron pin set at 15.00 ft.;

Thence S00°-41'-36"E, along said east line, 199.97 ft. to an iron pin;

Thence N88°-56'-00"E, 608.92 ft. to the place of beginning, passing for reference an iron pin set at 593.92 ft.

Containing 2.801 Ac. more or less, being subject to all legal highways and easements of record, and being part of the premises recorded in O.R. 116 Pg. 783 of the Auglaize Co. Deed Records.

Plat recorded in Vol. Pg.

William G. Fultz, Jr.
Reg. Surveyor No. 5173
16 Dec. 1995

K-189