

<p>Signature by a representative of the County Health Dept. denotes compliance with Health Regulations.</p> <p>Signed: _____ Date _____</p>	<p>Signature by a representative of the Auglaize County Regional Planning Commission denotes approval of this plat.</p> <p>Signed: _____ Date _____</p>
<p>Signature by a representative of City with 3 mile limit jurisdiction or Twp. Trustees or Village with zoning jurisdiction denotes approval of this plat. Signed: _____ Date _____</p> <p>for political S. D. of: _____</p>	<p>Signature by a representative of the County Engineer's Dept. denotes that this plat meets tax map plat requirements.</p> <p>Signed: _____ Date _____</p>

<p>KUCK AND MORRISEY, INC. CONSULTING ENGINEERS & SURVEYORS 2807 CHAPEL HILL DRIVE LIMA, OHIO 45805 - 228-1735</p>	<p>Client <u>Stan & Dona Mae KUENNING</u> County <u>Auglaize</u> Twp. <u>NEW BREMEN</u> Sec. <u>10</u> Drawn by <u>RDM</u> Scale _____ Drwg. No. _____ Checked by <u>rdm</u> Date <u>3/1/99</u> Sheet <u>1</u> of <u>2</u> <u>K-415</u> (T-7-S; R-4-E)</p>
---	--

DESCRIPTION

Being a parcel of land situated in the Village of New Bremen, German Township, T-7-S, R-4-E, Auglaize County, Ohio and being part of Outlots No. 11, 12 and 13 within said Village of New Bremen and being more particularly described as follows:

Commencing at a railroad spike found at the intersection of the centerline of Pearl Street and the centerline of North Main Street within said Village of New Bremen; thence N 00°00'00" E (assumed bearing) with said centerline of said North Main Street, 98.31 feet to a concrete nail set during a previous survey (found bent); thence N 89°47'51" E (passing through a concrete monument found at 30.00 feet), 185.00 feet to a capped 5/8 inch rebar set and the **PLACE OF BEGINNING** thence N 00°00'00" E, 68.06 feet to a point; thence N 90°00'00" W, 2.00 feet to a point; thence N 00°00'00" E, 68.00 feet to a concrete monument found; thence N 90°00'00" W, 75.85 feet to a cut "X" found cut at the edge of a concrete drive; thence N 04°58'00" E, 199.08 feet to an iron pipe found; thence S 84°18'00" E, 105.85 feet to an iron pin found; thence S 88°28'00" E (passing through an iron pin found at 200.00 feet), 383.10 feet to an iron pipe found on the westerly right-of-way line of State Route 66; thence S 08°33'00" W with said westerly right-of-way line, 148.80 feet to a O.D.O.T. concrete right-of-way monument found; thence S 09°01'00" W continuing with said westerly right-of-way line, 195.48 feet to a capped 5/8 inch rebar set at the intersection of said westerly right-of-way line with the south line of said Outlot 13; thence N 89°45'18" W with said south line, 370.79 feet to an iron pin found; thence N 00°00'00" E, 25.01 feet to an iron pin found; thence S 89°47'51" W, 4.06 feet to the **PLACE OF BEGINNING** containing 3.500 acres more or less and subject to all legal easements of record.

I hereby certify the accompanying map and survey which it represents to be correct to the best of my knowledge and belief. All rebar set and called for are topped with a plastic Peramark cap stamped:
KUCK & MORRISEY L.S. 6470

Date: 3/1/99

Richard D. Morrissey
Richard D. Morrissey, L.S. 6470
KUCK and MORRISEY, Inc.

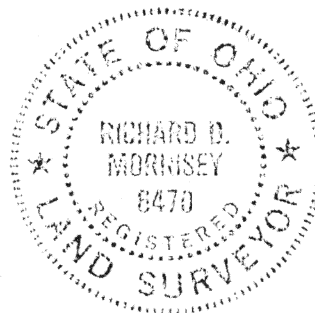

Signature by a representative of the County Health Dept. denotes compliance with Health Regulations.
Signed: _____ Date: _____

Signature by a representative of the Auglaize County Regional Planning Commission denotes approval of this plat.
Signed: _____ Date: _____

Signature by a representative of City with 3 mile limit jurisdiction or Twp. Trustees or Village with zoning jurisdiction denotes approval of this plat. Signed: _____
for political S. D. of: _____ Date: _____

Signature by a representative of the County Engineer's Dept. denotes that this plat meets tax map plat requirements.
Signed: _____ Date: _____

KUCK AND MORRISEY, INC.
CONSULTING ENGINEERS & SURVEYORS
2807 CHAPEL HILL DRIVE
LIMA, OHIO 45805 - 228-1735

Client Stan & Dona Mae KUENNING
County Auglaize Twp. NEW BREMEN Sec. 10
Drawn by RDM Scale _____ Drwg. No. _____
Checked by rdm Date 3/1/99
Sheet 2 of 2 K-416 (T-7-S; R-4-E)