

LEGEND

- "A" = Iron Bar Set
- "B" = Iron Bar Found
- "C" = PK Spike & Shinner Set
- "D" = PK Spike & Shinner Fd
- "E" = Monument Box

The parcels shown hereon is NOT within the 100 year flood zone

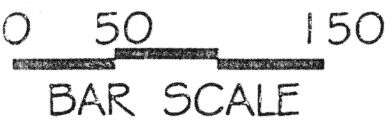

NORTH
Scale 1" = 100'

Wuebker Road
Quarter Section Line

David Bensman Survey

Section 24 (SE Qtr) Town 7 South
Jackson Township Auglaize County

Range 4 East
Ohio

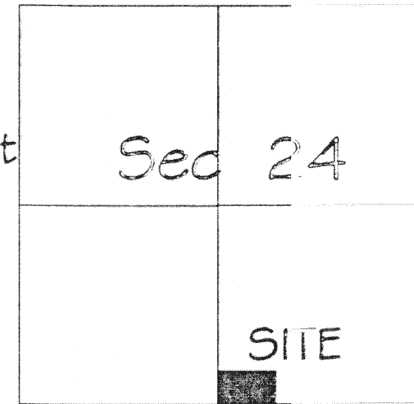

Boecker DB 259 PG 144

Reference Deed Book	Page
256	733
259	144
248	190
311	75
OR 85	160

Reference Survey By: T.W. Steinke
Dated 2/2/99

Basis of Bearings
Centerline of Bensman Road
S 88° 31' 17" E
Aug. Co. Section Cor. References

Deed Book 248 Page 190
1.500 Acres
(0.10 Acre in road RW)

1.500 Acres
(0.10 Acre in road RW)

SW Cor
SE Qtr
Sec 24

25' Existing RW Line

Section Line

Bensman Road (CR#40)

14-480

Prepared By:
Thomas W. Steinke
Registered Surveyor # 6177
16454 CR# 25-A
Anna, Ohio 45302

Phone 937-693-6538
Fax 937-693-2068

Thomas W. Steinke
Thomas W. Steinke August 1, 1999



July 31, 1999

Description of 3.000 Acres
For: David Bensman

Being 3.000 Acres located in the southeast quarter of Section 24, Town 7 South, Range 4 East, Jackson Township, Auglaize County, Ohio and being further described as follows:

Commencing at a monument box located at the southwest corner of the southeast quarter of Section 24, said point also being the centerline of Bensman Road and the PLACE OF BEGINNING for the parcel herein described;

Thence North 01 degrees 10 minutes 16 seconds East along the west line of the Southeast quarter of section 24, a distance of 384.36 feet to an iron bar set;

Thence South 88 degrees 31 minutes 17 seconds East, a distance of 340.00 feet to an iron bar set;

Thence South 01 degrees 10 minutes 16 seconds West, a distance of 384.36 feet to a PK Spike & Shinner set in the south line of Section 24 and centerline of Bensman Road, passing through an iron bar set at 354.36 feet;

Thence North 88 degrees 31 minutes 17 seconds West with said centerline and section line, a distance of 340.00 feet to the place of beginning.

Containing in all 3.000 acres of which 0.20 acre is located within the existing road right of way

Survey & description prepared by Thomas W. Steinke, registered surveyor # 6177, on this 31st day of July, 1999

July 31, 1999

Description of 1.500 Acres
For: David Bensman

Being 1.500 Acres located in the southeast quarter of Section 24, Town 7 South, Range 4 East, Jackson Township, Auglaize County, Ohio and being further described as follows:

Commencing at a monument box located at the southwest corner of the southeast quarter of Section 24, said point also being the centerline of Bensman Road and the PLACE OF BEGINNING for the parcel herein described;

Thence North 01 degrees 10 minutes 16 seconds East along the west line of the southeast quarter of Section 24, a distance of 384.36 feet to an iron bar set;

Thence South 88 degrees 31 minutes 17 seconds East, a distance of 170.00 feet to an iron bar set;

Thence South 01 degrees 10 minutes 16 seconds West, a distance of 384.36 feet to a PK Spike & Shinner set in the south line of Section 24 and centerline of Bensman Road, passing through an iron bar set at 354.36 feet;

Thence North 88 degrees 31 minutes 17 seconds West with said centerline and section line, a distance of 170.00 feet to the place of beginning.

Containing in all 1.500 acres of which 0.10 acre is located within the existing road right of way

Survey & description prepared by Thomas W. Steinke, registered surveyor # 6177, on this 31st day of July, 1999

K-482

July 31, 1999

Description of 1.500 Acres
For: David Bensman

Being 1.500 Acres located in the southeast quarter of Section 24, Town 7 South, Range 4 East, Jackson Township, Auglaize County, Ohio and being further described as follows:

Commencing at a monument box located at the southwest corner of the southeast quarter of Section 24, said point also being the centerline of Bensman Road;

Thence South 88 degrees 31 minutes 17 seconds East along the centerline of Bensman Road and south line of section 24, a distance of 170.00 feet to a PK Spike & shinner and the PLACE OF BEGINNING for the parcel herein described;

Thence North 01 degrees 10 minutes 16 seconds East a distance of 384.36 feet to an iron bar set;

Thence South 88 degrees 31 minutes 17 seconds East, a distance of 170.00 feet to an iron bar set;

Thence South 01 degrees 10 minutes 16 seconds West, a distance of 384.36 feet to a PK Spike & Shinner set in the south line of Section 24 and centerline of Bensman Road, passing through an iron bar set at 354.36 feet;

Thence North 88 degrees 31 minutes 17 seconds West with said centerline and section line, a distance of 170.00 feet to the place of beginning.

Containing in all 1.500 acres of which 0.10 acre is located within the existing road right of way

Survey & description prepared by Thomas W. Steinke, registered surveyor # 6177, on this 31st day of July, 1999