

H & S Civil Engineers and Land Surveyors

913 Fieldstone Court
Wapakoneta, Ohio 45895
Ted K. Schnell P.E., P.S.
Gregory B. Huber P.E.
(419) 738-4758
(419) 753-3162



Tangeman Survey

1.038 Acres located in the South Half of the Northeast
Quarter of Section 1, Logan Township, T-5-S,
R-5-E, Auglaize County, Ohio

LOCATION PLAN

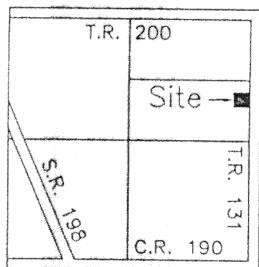

Section 1
Logan Township

SCALE

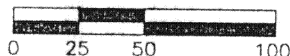

North Line of the Northeast Quarter of Section 1
and Centerline of Township Road #200 Monroe Road

PREVIOUS SURVEY REFERENCES

Survey Book "I", Page 587
Survey Book "I", Page 589

PREVIOUS DEED

Deed Volume OR 209
Page 848

North Line of the South Half of the
Northeast Quarter of Section 1

N 89°-41'-38" E
373.18'

LEGEND

- Iron Pin (set)
- Iron Pin (found)
- △ PK Nail (set)
- ▲ PK Nail (found)
- Railroad Spike (found)
- Monument Box

3.962 Ac Remain

NOTE

This Survey Plat and Legal Description
is Recorded in Survey Book K,
Page 680, Auglaize County Engineer's
Tax Map Office

S 89°-53'-20" E
373.21'

1.038 Ac

0.056 Acre R/W

(This acreage is not intended to be used as a building site)

373.21'

N 89°-53'-20" W

Deed Volume OR 168
Page 37

Attest

Ted K. Schnell
Professional Engineer
Professional Surveyor

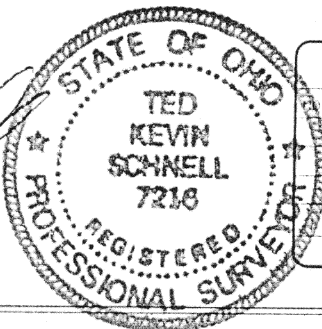

REVISIONS

DATE	BY

Tangeman Survey

1.038 Acre Parcel Split

DRAWN BY Greg	SCALE Shown	DRAWING NO.
CHK'D Kevin	DATE 3/11/98	1 OF 2
TRACED	APP'D	

subdivision developments construction staking topographic surveys drainage analysis
lot surveys on-site septic systems farm surveys ohio epa SWPP plans

14-680

H & S Civil Engineers and Land Surveyors

913 Fieldstone Court
Wapakoneta, Ohio 45895
(419) 738-4758

Ted K. Schnell P.E., P.S.
Greg B. Huber P.E.

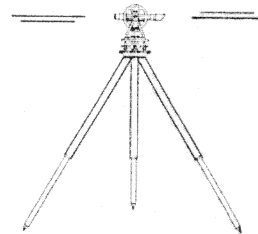

SURVEYOR'S DESCRIPTION 1.038 ACRE PARCEL

The following described parcel of land is situated in the South Half of the Northeast Quarter of Section 1, Logan Township, Town-5-South, Range-5-East, County of Auglaize, State of Ohio, and is more particularly described as follows:

Commencing for reference at a Monument Box located at the Northeast corner of the Northeast Quarter of Section 1, Logan Township, Town-5-South, Range-5-East, County of Auglaize, State of Ohio;

Thence with a bearing of S. 00 -40'-24" E. along the East line of the Northeast Quarter of said Section 1, for a distance of 1,327.80 feet to a Railroad Spike (found) on the North line of the South Half of the Northeast Quarter of said Section 1;

Thence continuing with a bearing of S. 00 -40'-24" E. along the East line of the Northeast Quarter of said Section 1, for a distance of 538.87 feet to a P.K. Nail/Shiner (set) and the PLACE OF BEGINNING;

Thence continuing with a bearing of S. 00 -40'-24" E. along the East line of the Northeast Quarter of said Section 1, for a distance of 121.13 feet to a P.K. Nail/Shiner (found);

Thence with a bearing of N. 89 -53'-20" W. for a distance of 373.21 feet to an iron pin (found), and passing thru an iron pin (found) for reference at 20.00 feet;

Thence with a bearing of N. 00 -40'-24" W. for a distance of 121.13 feet to an iron pin (set);

Thence with a bearing of S. 89 -53'-20" E. for a distance of 373.21 feet to a P.K. Nail/Shiner (set), and passing thru an iron pin (set) for reference at 353.21 feet, said P.K. Nail/Shiner being the original PLACE OF BEGINNING.

Containing in all 1.038 Acres, of which, 0.056 Acre was previously dedicated for highway purposes. The above described parcel of land is subject to all other legal easements, reservations, or restrictions, if any, upon said premises. Previous Deed References: Deed Volume OR 209, Page 848.

Prepared by:

Ted K. Schnell
Professional Engineer
Professional Surveyor



subdivision developments • construction staking • topographic surveys • drainage analysis
lot surveys • on-site septic systems • farm surveys • ohio epa SWPP plans

K-681