

DESCRIPTION

Being a parcel of land situate in the Northwest quarter of Section 16, T-5-S, R-8-E, Wayne Township, Auglaize County, Ohio and more particularly described as follows:

Commencing at a monument box found at the northwest corner of said Northwest quarter of said Section 16; thence S 00°09'56" E with the west line of said Northwest quarter (also the centerline of Moyer Road), 989.37 feet to a PK nail and the PLACE OF BEGINNING thence N 89°11'49" E, 1,094.87 feet to a capped 5/8 inch rebar set; thence S 00°09'56" E, 287.43 feet to a capped 5/8 inch rebar set; thence S 89°50'04" W, 599.80 feet to a capped 5/8 inch rebar set; thence N 00°09'56" W, 160.25 feet to a capped 5/8 inch rebar found; thence S 89°50'04" W (passing through a capped 5/8 inch rebar found at 475.00 feet), 495.00 feet to a PK nail found on the west line of said Northwest quarter; thence N 00°09'56" W with said west line of said Northwest quarter (also the centerline of Moyer Road), 115.00 feet to the PLACE OF BEGINNING containing 5.250 acres more or less and subject to all highway and other legal easements of record.

I hereby certify the accompanying map and survey which it represents to be correct to the best of my knowledge and belief. All rebar set and called for are topped with a plastic permark cap stamped: KUCK & MORRISEY L.S. 6470.

Date: 7/20/95

Richard D. Morrissey, L.S. 6470
Kuck and Morrissey, Inc.

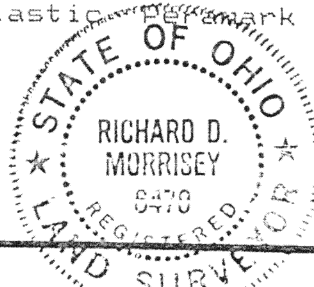

Signature by a representative of the County Health Dept. denotes compliance with Health Regulations.
Signed: _____ Date: _____

Signature by a representative of the Auglaize County Regional Planning Commission denotes approval of this plat.
Signed: _____ Date: _____

Signature by a representative of City with 3 mile limit jurisdiction or Twp. Trustees or Village with zoning jurisdiction denotes approval of this plat. Signed: _____
for political S. D. of: _____ Date: _____

Signature by a representative of the County Engineer's Dept. denotes that this plat meets tax map plat requirements.
Signed: _____ Date: _____

KUCK AND MORRISEY, INC.
CONSULTING ENGINEERS & SURVEYORS
2807 CHAPEL HILL DRIVE
LIMA, OHIO 45805 - 228-1735

Client Mr. Dale CUMMINGS
County Auglaize Twp. Wayne Sec. 16
Drawn by RDM Scale _____ Drwg. No. _____
Checked by rdm Date 7/20/95
Sheet 1 of 1
(T-5-S; R-8-E)