

Being a parcel of land situate in the Northeast quarter of Section 18, T-5-S, R-8-E, Wayne Township, now within the Village of Waynesfield, Auglaize County, Ohio and more particularly described as follows:

BEGINNING at a PK nail found at the southeast corner of said Northeast quarter of said Section 18; thence N 00° 17' 57" W (basis of bearing - adjoining subdivision) with the east line of said Northeast quarter (also the centerline of S.R. 196), 360.41 feet to a PK nail found; thence S 89° 53' 23" W (passing through an iron pipe found at 30.00 feet and at 391.00 feet), 400.00 feet to a point on the current west Corporation Line for said Village of Waynesfield; thence S 00° 17' 29" E with said west Corporation Line, 360.28 feet to a capped iron pin found on the south line of said Northeast quarter; thence N 89° 54' 31" E with said south line of said Northeast quarter (passing through a capped 5/8 inch rebar set at 370.05 feet), 400.05 feet to the PLACE OF BEGINNING containing 3.309 acres more or less and subject to all highway and other legal easements of record.

I hereby certify the accompanying map and survey which it represents to be correct to the best of my knowledge and belief. All rebar set and called for are topped with a plastic Peramark cap stamped:

KUCK & MORRISEY L.S. 6470

Date: 3/17/99

Richard D. Morrissey, L.S. 6470
KUCK and MORRISEY, Inc.

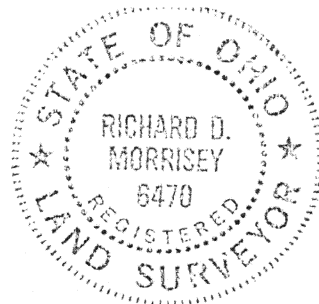

L-725

Signature by a representative of the County Health Dept. denotes compliance with Health Regulations.
Signed: _____ Date: _____

Signature by a representative of the Auglaize County Regional Planning Commission denotes approval of this plat.
Signed: _____ Date: _____

Signature by a representative of City with 3 mile limit jurisdiction or Twp. Trustees or Village with zoning jurisdiction denotes approval of this plat. Signed: _____
for political S. D. of: _____ Date: _____

Signature by a representative of the County Engineer's Dept. denotes that this plat meets tax map plat requirements.
Signed: _____ Date: _____

KUCK AND MORRISEY, INC.
CONSULTING ENGINEERS & SURVEYORS
2807 CHAPEL HILL DRIVE
LIMA, OHIO 45805 - 228-1735

Client Mr. David NIELSEN c/o Oakridge Realty Co
County Auglaize Twp. Wayne Sec. 18
Drawn by J RDM Scale 1"=100' Drwg. No. _____
Checked by rdm Date 3/17/99
Sheet 1 of 1
(T-5-S; R-8-E)