

Lloyd Few to Kevin Bayliff Survey

5.00 Acres located in the Northwest Quarter of Section 22, Union Township,
Town-5-South, Range-7-East, Auglaize County, Ohio

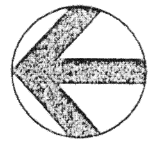

Scale



State Route #67

East Line of the Northwest Quarter of Section 22, Union Township
N. 00°-40'-59" E.

2,142.15'

N. 00°-40'-59" E.

509.36'

Site Plan

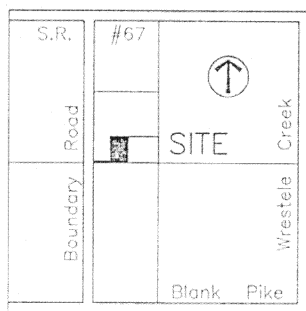

Section 22
Union Township

Legend

- Iron Pin (set)
- Iron Pin (found)
- △ P.K. Nail/Shiner (set)
- ▲ P.K. Nail (found)
- Monument Box
- Stone

Note

(1) The basis of bearings used for this Survey was by holding the centerline of Boundary Road as being N. 00°-26'-54" E. as per the Auglaize County Engineer's Global Positioning Survey (GPS).

Boundary Road

N. 00°-26'-54" E.

2,622.89'

S. 89°-10'-46" E.
477.30'

S. 89°-10'-46" E.
449.67'

S. 00°-40'-59" W.
484.36'

5.00 Acres

Previous Deed
Deed Volume 173, Page 363

N. 00°-40'-59" E.
484.36'

PLACE
OF
BEGINNING

280.04'

N. 00°-26'-54" E.
25.00'

South Line of the Northwest Quarter of Section 22, Union Township
N. 89°-10'-46" W. - 1,206.91'

This Survey Plat is Recorded in Survey Book M, Page 133
Auglaize County Engineer's Tax Map Office.

Prepared by:

Ted K. Schnell

Ted K. Schnell
Professional Engineer
Professional Surveyor

11-13-00
date

H & S Civil Engineers and Land Surveyors

913 Fieldstone Court Wapakoneta, Ohio 45895

Lloyd Few to Kevin Bayliff 22

Union Auglaize Ohio 1/1

M-133

H & S Civil Engineers and Land Surveyors

913 Fieldstone Court

Wapakoneta, Ohio 45895

Phone (419) 738-4758

Fax (419) 739-7631

E-Mail hscivil@bright.net

Ted K. Schnell P.E., P.S.

Gregory B. Huber P.E.

SURVEYOR'S DESCRIPTION FOR 5.00 ACRE PARCEL

The following described parcel of land is situated in the Northwest Quarter of Section 22, Union Township, Town-5-South, Range-7-East, Auglaize County, Ohio, and is more particularly described as follows:

Commencing for reference at a Monument Box (found) at the intersection of the Centerline of Boundary Road with the South Line of the Northwest Quarter of said Section 22, Union Township;

Thence with a bearing of N. 00°-26'-54" E. along the Centerline of Boundary Road for a distance of 25.00 feet to a P.K. Nail/Shiner(found);

Thence with a bearing of S. 89°-10'-46" E. for a distance of 280.04 feet to an Iron Pin (set) and the PLACE OF BEGINNING;

Thence with a bearing of N. 00°-40'-59" E. for a distance of 484.36 feet to an Iron Pin (set);

Thence with a bearing of S. 89°-10'-46" E. for a distance of 449.67 feet to an iron pin (found);

Thence with a bearing of S. 00°-40'-59" W. for a distance of 484.36 feet to an iron pin (found);

Thence with a bearing of N. 89°-10'-46" W. for a distance of 449.67 feet to an iron pin (set) and the original PLACE OF BEGINNING.

Containing in all 5.00 Acres of land which is subject to all other legal easements, reservations, or restrictions, if any, upon said premises. Previous Deed References: Deed Volume 173, Page 363, Auglaize County Recorder's Office.

Prepared by:

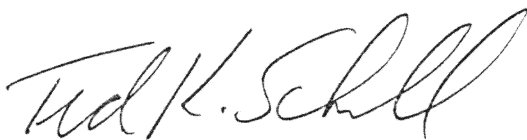

Ted K. Schnell
Professional Engineer
Professional Surveyor

m-134