

LEGEND:

- A ~ Capped Iron Pin found
- B ~ Capped 5/8" Rebar set.
- C ~ RR Spike found

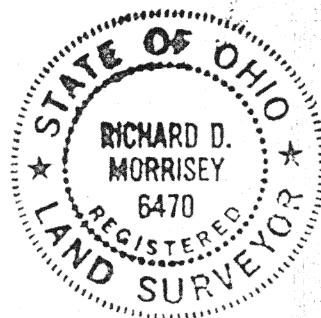

I hereby certify the accompanying map and survey which it represents to be correct to the best of my knowledge and belief. All rebar set and called for are topped with a plastic Permark cap stamped: KUCK & MORRISSEY L.S. 6470.

Date: 7/1/94
Richard D. Morrissey, L.S. 6470
Kuck and Morrissey, Inc.

Signature by a representative of the County Health Dept. denotes compliance with Health Regulations.
Signed: _____ Date: _____

Signature by a representative of the Auglaize County Regional Planning Commission denotes approval of this plat.
Signed: _____ Date: _____

Signature by a representative of City with 3 mile limit jurisdiction or Twp. Trustees or Village with zoning jurisdiction denotes approval of this plat. Signed: _____
for political S. D. of: _____ Date: _____

Signature by a representative of the County Engineer's Dept. denotes that this plat meets tax map plat requirements.
Signed: _____ Date: _____

KUCK AND MORRISSEY, INC.
CONSULTING ENGINEERS & SURVEYORS
2807 CHAPEL HILL DRIVE
LIMA, OHIO 45805 • 228-1735
N-427

Client TERRY HERWIG
County Auglaize Twp. Duchangnet Sec. 19
Drawn by RDM Scale 1"=130' Drwg. No. _____
Checked by rdm Date October 9, 1996
Sheet 1 of 5
(T-5-S-R-6-E)

SEE N-432 for REVISED

DESCRIPTION
PARCEL "A"

Being a parcel of land situate in the Southwest quarter of Section 19, T-5-S, R-6-E, Duchouquet Township, Auglaize County, Ohio and more particularly described as follows:

Commencing at a monument box found at the northwest corner of said Southwest quarter of said Section 19, Duchouquet Township; thence N 89°23'49" E with the north line of said Southwest quarter (also the centerline of Infirmary Road), 557.43 feet to a PK nail found and the PLACE OF BEGINNING; thence continuing N 89°23'49" E with said north line and centerline, 52.10 feet to a railroad spike found at the northwest corner of Lot No. 5 in Sherwood West Subdivision; thence S 00°07'31" E with the west line of said Lot No. 5, 430.00 feet to a capped 5/8 inch rebar found at the southwest corner of said Lot No. 5; thence N 89°23'49" E with the south line of said Sherwood West Subdivision, 422.46 feet to a capped 5/8 inch rebar found at the northwest corner of a 1.431 acres parcel of land; thence S 00°07'31" E with the west line of said 1.431 acres parcel and the west line of a 0.905 acre parcel of land described in O.R. Book 18 on Page 749, 490.43 feet to an iron pin found at the northwest corner of a 1.00 acre parcel of land described in O.R. Book 7 on Page 816; thence S 89°22'29" W with the north line of a 0.669 acre parcel of land and the projection of said north line, 330.46 feet to a capped 5/8 inch rebar found; thence N 00°07'31" W, 390.56 feet to a capped 5/8 inch rebar set; thence S 89°23'49" W, 144.10 feet to a capped 5/8 inch rebar set; thence N 00°07'31" W, 530.00 feet to the PLACE OF BEGINNING containing 4.566 acres more or less and subject to all highway and other legal easements of record including but not limited to the ingress/egress access easement to Parcel "B" described below. This parcel shall also have rights to the following described fifteen (15) foot easement:

See Sheet 3 of 5 for ingress/egress easement

Signature by a representative of the County Health Dept. denotes compliance with Health Regulations. Signed: _____ Date _____	Signature by a representative of the Auglaize County Regional Planning Commission denotes approval of this plat. Signed: _____ Date _____
Signature by a representative of City with 3 mile limit jurisdiction or Twp. Trustees or Village with zoning jurisdiction denotes approval of this plat. Signed: _____ for political S. D. of: _____ Date _____	Signature by a representative of the County Engineer's Dept. denotes that this plat meets tax map plat requirements. Signed: _____ Date _____
KUCK AND MORRISEY, INC. CONSULTING ENGINEERS & SURVEYORS 2807 CHAPEL HILL DRIVE LIMA, OHIO 45805 -- 228-1735 N-428	Client <u>TERRY HERWIG</u> County <u>Auglaize</u> Twp. <u>Duchouquet</u> Sec. <u>19</u> Drawn by <u>RDM</u> Scale <u>1"=130'</u> Drwg. No. _____ Checked by <u>rdm</u> Date <u>October 9, 1996</u> Sheet <u>2</u> of <u>5</u> (T-5-S: R-6-E)

EASEMENT
FOR PARCEL "A"

BEING A FIFTEEN (15) FOOT EASEMENT ALONG THE ENTIRE EAST
SIDE OF THE FOLLOWING DESCRIBED PARCEL:

Being a parcel of land situate in the Southwest quarter of Section 19, T-5-S,
R-6-E, Duchouquet Township, Auglaize County, Ohio and more particularly
described as follows:

Commencing at a monument box found at the northwest corner of said
Southwest quarter of said Section 19, Duchouquet Township; thence
N 89°23'49" E with the north line of said Southwest quarter (also the center-
line of Infirmary Road), 557.43 feet to a PK nail found; thence
S 00°07'31" E, 1,130.01 feet to a capped 5/8 inch rebar found at the north-
west corner of Lot No. 24 in Sherwood Forest Subdivision; thence
N 89°28'44" E with the north of said Lot No. 24, 144.10 feet to a capped 5/8
inch rebar found at the northeast corner of said Lot No. 24 and the PLACE
OF BEGINNING; thence N 00°07'31" W, 209.65 feet to a capped 5/8 inch
rebar found; thence N 89°22'29" E, 190.63 feet to a capped 5/8 inch rebar
found at the northwest corner of a 0.669 acre parcel of land; thence
S 00°46'29" E with the west line of said 0.669 acre parcel, 210.00 feet to a
capped 5/8 inch rebar found at the northeast corner of Lot No. 23 in
Sherwood Forest Subdivision; thence S 89°28'44" W with the north line of
said Lot No. 23, 193.10 feet to the PLACE OF BEGINNING containing
0.924 acre more or less.

Signature by a representative of the County Health Dept.
denotes compliance with Health Regulations.

Signed: _____ Date _____

Signature by a representative of the Auglaize County Regional
Planning Commission denotes approval of this plat.

Signed: _____ Date _____

Signature by a representative of City with 3 mile limit juris-
diction or Twp. Trustees or Village with zoning jurisdiction
denotes approval of this plat. Signed: _____
for political S. D. of: _____ Date _____

Signature by a representative of the County Engineer's Dept.
denotes that this plat meets tax map plat requirements.

Signed: _____ Date _____

KUCK AND MORRISEY, INC.

CONSULTING ENGINEERS & SURVEYORS

2807 CHAPEL HILL DRIVE

LIMA, OHIO 45805 - 228-1735

N-429

Client TERRY HERWIG

County Auglaize Twp. Duchouquet Sec. 19

Drawn by RDM Scale 1"=130 Drwg. No. _____

Checked by rdm Date October 9, 1996

Sheet 3 of 5

(T-5-S-R-6-E)

**DESCRIPTION
PARCEL "B"**

Being a parcel of land situate in the Southwest quarter of Section 19, T-5-S, R-6-E, Duchouquet Township, Auglaize County, Ohio and more particularly described as follows:

Commencing at a monument box found at the northwest corner of said Southwest quarter of said Section 19, Duchouquet Township; thence N 89°23'49" E with the north line of said Southwest quarter (also the center-line of Infirmary Road), 557.43 feet to a PK nail found; thence S 00°07'31" E, 530.00 feet to a capped 5/8 inch rebar set and the PLACE OF BEGINNING thence N 89°23'49" E, 144.10 feet to a capped 5/8 inch rebar set; thence S 00°07'31" E, 600.21 feet to a capped 5/8 inch rebar found at the northeast corner of Lot No. 24 in Sherwood Forest Subdivision; thence S 89°28'44" W with the north line of said Lot No. 24, 144.10 feet to a capped 5/8 inch rebar found at the northwest corner of said Lot No. 24; thence N 00°07'31" W, 600.00 feet to the PLACE OF BEGINNING containing 1.985 acres more or less and subject to all legal easements of record and with the rights to the following ingress/egress easement.

**DESCRIPTION
EASEMENT TO PARCEL "B"**

Being an easement in the Southwest quarter of Section 19, T-5-S, R-6-E, Duchouquet Township, Auglaize County, Ohio and more particularly described as follows:

Commencing at a monument box found at the northwest corner of said Southwest quarter of said Section 19, Duchouquet Township; thence N 89°23'49" E with the north line of said Southwest quarter (also the center-line of Infirmary Road), 557.43 feet to a PK nail found and the PLACE OF BEGINNING; thence continuing N 89°23'49" E with said north line and centerline, 52.10 feet to a railroad spike found at the northwest corner of Lot No. 5 in Sherwood West Subdivision; thence S 00°07'31" E with the west line of said Lot No. 5 and the southerly project of said west line, 530.00 feet; thence S 89°23'49" W, 50.00 feet; thence N 00°07'31" W, 530.00 feet to the PLACE OF BEGINNING

Signature by a representative of the County Health Dept. denotes compliance with Health Regulations.
Signed: _____ Date _____

Signature by a representative of the Auglaize County Regional Planning Commission denotes approval of this plat.
Signed: _____ Date _____

Signature by a representative of City with 3 mile limit jurisdiction or Twp. Trustees or Village with zoning jurisdiction denotes approval of this plat. Signed: _____ Date _____
for political S. D. of: _____

Signature by a representative of the County Engineer's Dept. denotes that this plat meets tax map plat requirements.
Signed: _____ Date _____

KUCK AND MORRISEY, INC.
CONSULTING ENGINEERS & SURVEYORS
2807 CHAPEL HILL DRIVE
LIMA, OHIO 45805 .. 228-1735

N-430

Client TERRY HERWIG
County Auglaize Twp. Duchouquet Sec. 19
Drawn by RDM Scale 1"=130 Drwg. No. _____
Checked by rdm Date October 9, 1996
Sheet 4 of 5
(T-5-S-R-6-E)

DESCRIPTION
PARCEL "C"

Being a parcel of land situate in the Southwest quarter of Section 19, T-5-S, R-6-E, Duchouquet Township, Auglaize County, Ohio and more particularly described as follows:

Commencing at a monument box found at the northwest corner of said Southwest quarter of said Section 19, Duchouquet Township; thence N 89°23'49" E with the north line of said Southwest quarter (also the center-line of Infirmary Road), 557.43 feet to a PK nail found; thence S 00°07'31" E, 1,130.01 feet to a capped 5/8 inch rebar found at the northwest corner of Lot No. 24 in Sherwood Forest Subdivision; thence N 89°28'44" E with the north of said Lot No. 24, 144.10 feet to a capped 5/8 inch rebar found at the northeast corner of said Lot No. 24 and the PLACE OF BEGINNING; thence N 00°07'31" W, 209.65 feet to a capped 5/8 inch rebar found; thence N 89°22'29" E, 190.63 feet to a capped 5/8 inch rebar found at the northwest corner of a 0.669 acre parcel of land; thence S 00°46'29" E with the west line of said 0.669 acre parcel, 210.00 feet to a capped 5/8 inch rebar found at the northeast corner of Lot No. 23 in Sherwood Forest Subdivision; thence S 89°28'44" W with the north line of said Lot No. 23, 193.10 feet to the PLACE OF BEGINNING containing 0.924 acre more or less and subject to all legal easements of record including but not limited to a fifteen (15) foot easement along the entire east side of this parcel.

Signature by a representative of the County Health Dept.
denotes compliance with Health Regulations.
Signed: _____ Date _____

Signature by a representative of the Auglaize County Regional
Planning Commission denotes approval of this plat.
Signed: _____ Date _____

Signature by a representative of City with 3 mile limit juris-
diction or Twp. Trustees or Village with zoning jurisdiction
denotes approval of this plat. Signed: _____
for political S. D. of: _____ Date _____

Signature by a representative of the County Engineer's Dept.
denotes that this plat meets tax map plat requirements.
Signed: _____ Date _____

KUCK AND MORRISEY, INC.
CONSULTING ENGINEERS & SURVEYORS
2807 CHAPEL HILL DRIVE
LIMA, OHIO 45805 .. 228-1735

N-431

Client TERRY HERWIG
County Auglaize Twp. Duchouquet Sec. 19
Drawn by RDM Scale 1"=130 Drwg. No. _____
Checked by cdm Date October 9, 1996
Sheet 5 of 5

(T-5-S:R-6-E)