

Location Map

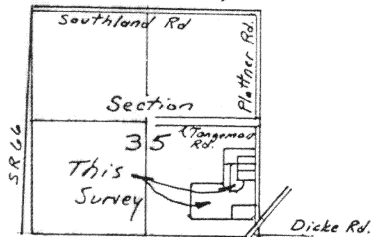

WULBER SURVEY

Part of the SE 1/4 of Section 35
T 6 S, R 4 E

St. Marys Twp., Auglaize County, Ohio

Owner of tracts surveyed: Don Wulber

Vol. 262 Pg. 331

Scale:
1" = 200'

~ LEGEND ~

- Iron pin fd. (Unless otherwise noted)
- Iron pin set
- ✱ Railroad Spike fd.
- ✱ P.K. nail found.
- P.K. nail set in tree root

Bearing on C.R. 61 (Platner Rd.)
from previous survey.

Helen Froning
37.5 Ac.
Vol. 261 Pg. 468

Tract 2

25.417 Ac. Total
0.330 Ac. Rd. R/W
25.087 Ac. Net

⊕ Tract 1

2.552 Ac. Total
0.017 Ac. Rd. R/W
2.535 Ac. Net

* Lines established by previous Survey
See Plat Bk. H Pg. 89.

Surveyed August 26, 1995

Steven H. Kremer

By Steven H. Kremer
New Bremen, Ohio

Registered Surveyor No. 7487

Signature by a representative of the County Health Dept. denotes
compliance with Health Regulations.

Signed: _____ Date _____

Signature by a representative of the Auglaize County Regional
Planning Commission denotes approval of this plat.

Signed: _____ Date _____

Signature by a representative of City with 3 mile limit jurisdiction
or Twp. Trustees or Village with zoning jurisdiction denotes
approval of this plat. Signed: _____

for political S.D. of: _____ Date _____

Signature by a representative of the County Engineer's Dept.
denotes that this plat meets tax map plat requirements.

Signed: _____ Date _____

N-651

Client Don Wulber

County Auglaize

Drawn by S. Kremer

Checked by _____

Sheet _____ of _____

Twp. St. Marys

Scale 1" = 200'

Date _____

Sec. 35

Drwg. No. _____

(T 6 S; R 4 E)

Description for Deed, Don Wulber, Grantor

Real Estate situated in St. Marys Township, Auglaize County, State of Ohio and bounded and described as follows:

TRACT 1

Being a tract in the southeast quarter of Section 35, Town 6 South, Range 4 East, commencing at a monument box at the southeast corner of said Section 35, thence North $00^{\circ} 00' 45''$ East 1622.38 feet along the east section line and centerline of County Road 61 (Plattner Pike) to a P.K. nail for the true point of beginning;

thence North $89^{\circ} 59' 15''$ West 373.50 feet to an iron pin;

thence South $00^{\circ} 00' 45''$ West 175.00 feet to a P.K. nail in the root of a ten (10) inch diameter tree;

thence South $89^{\circ} 59' 15''$ East 100.00 feet to an iron pin;

thence South $00^{\circ} 00' 45''$ West 100.00 feet to an iron pin;

thence South $53^{\circ} 08' 33''$ West 125.00 feet to an iron pin;

thence North $89^{\circ} 59' 15''$ West 125.00 feet crossing Carter Creek to an iron pin;

thence North $03^{\circ} 15' 29''$ West 175.29 feet along the top bank of Carter Creek to an iron pin;

thence North $01^{\circ} 15' 03''$ West 451.58 feet to an iron pin;

thence North $88^{\circ} 36' 58''$ East 145.00 feet to an iron pin;

thence South $00^{\circ} 00' 45''$ West 250.00 feet to an iron pin;

thence South $89^{\circ} 59' 15''$ East 373.50 feet to a rail road spike;

thence South $00^{\circ} 00' 45''$ West 30.00 feet along the east section line and centerline of Plattner Pike to the point of beginning containing 2.552 acres of land more or less.

Said tract being subject to highways and any other easement or restriction of record.

Previous Deed Reference: VOLUME 262, PAGE 331

Survey Reference: Plat Book "H", PAGE 89
Plat Book "H", Page 114
Plat Book "I", Page 426

Description from survey made on August 26, 1995 by Steven H. Kremer, Registered Surveyor No. 7487.

N-652

Description for Deed, Don Wulber, Grantor

Real Estate situated in St. Marys Township, Auglaize County, State of Ohio and bounded and described as follows:

TRACT 2.

Being a tract in the Southeast quarter of Section 35; Town 6 South, Range 4 East, commencing at a monument box at the Southeast corner of said Section 35; thence North $00^{\circ} 00' 45''$ East 871.51 feet along the east section line and centerline of County Road 61 (Plattner Pike) to a railroad spike for the true point of beginning;

thence North $89^{\circ} 07' 01''$ West 258.58 feet to an iron pin;

thence North $88^{\circ} 49' 32''$ West 149.94 feet to an iron pin;

thence South $00^{\circ} 25' 14''$ East 221.81 feet to an iron pin;

thence South $89^{\circ} 34' 46''$ West 897.82 feet to a fence post on the East side of Froning's lane;

thence North $00^{\circ} 01' 30''$ East 998.00 feet to a point in a 4.5 foot diameter Burr Oak;

thence North $89^{\circ} 26' 10''$ East 641.34 feet to a point in a twenty (20) inch diameter Hackberry tree;

thence North $00^{\circ} 14' 56''$ East 240.98 feet to a point in a eighteen (18) inch diameter Walnut tree;

thence North $88^{\circ} 36' 58''$ East 143.87 feet to an iron pin;

thence South $01^{\circ} 15' 03''$ East 451.58 feet to an iron pin;

thence South $03^{\circ} 15' 29''$ East 175.29 feet along the top bank of Carter Creek to an iron pin;

thence South $89^{\circ} 59' 15''$ East 125.00 feet crossing Carter Creek to an iron pin;

thence North $53^{\circ} 08' 33''$ East 125.00 feet to an iron pin;

thence North $00^{\circ} 00' 45''$ East 100.00 feet to an iron pin;

thence South $89^{\circ} 59' 15''$ East 273.50 feet to a P.K. nail;

thence South $00^{\circ} 00' 45''$ West 575.87 feet along the east section line and centerline of Plattner Pike to the point of beginning containing 25.417 acres of land more or less.

N-653

Said tract being subject to highways and any other easement or restriction of record.

Previous Deed Reference: VOLUME 262, PAGE 331

SURVEY REFERENCE: PLAT BOOK "H", PAGE 89
PLAT BOOK "H", PAGE 114
PLAT BOOK "I" PAGE 426

Description from survey made on March 22, 1987 By Registered Surveyor No. 7044 and
portions of survey made of August 26, 1995 by Steven H. Kremer, Registered Surveyor No.
7487.

N-654