

SAWMILLER - JAUBERT SURVEY

Part of the North Half of Section 1, Logan Township, Auglaize County, Ohio.

T.R. 121
Bowsher Road

E Township Road 200

34.11'
N.89°16'35"E.

N.W. Corner,
N.E. Quarter,
Section 1

(Monroe Road 40' R/W)
E Township Road 200

15.89'
N.89°16'35"E.

435.60'
N.89°16'35"E.

108.80'
E Township Road 200

273.48'

1,315.87'
S.00°41'00"E.

684.01'

595.99'

598.93'

709.68'

666.96'

R.J. Corman Railroad
N.46°38'25"E.
449.29'

7.241 ACRE
R & V. Sawmiller
Deed: Vol. OR 221,
Page 239.

3.000 ACRE
0.200 Ac. R/W
J.W. Jaubert
Deed: Vol. OR 221,
Page 230.

2.000 ACRE
0.050 Ac. R/W

12.077 ACRE
0.275 Ac. R/W
11.614 Ac. in N.W. 1/4
0.463 Ac. in N.E. 1/4

25.202 ACRE
R & V. Sawmiller
Deed: Vol. OR 221,
Page 239.

Post 7.3' East
of property corner

Post 5.42' North
of property corner

N.00°41'36"W.
745.50'

N.00°41'36"W.
265.88'

S.67°20'02"E.
684.01'

N.00°41'36"W.
595.99'

S.00°33'07"E.
598.93'

S.00°41'36"E.
598.93'

N.00°43'25"W.
300.00'

S.00°43'25"E.
400.00'

S.00°43'25"E.
400.00'

S.00°43'25"E.
400.00'

S.00°43'25"E.
400.00'

S.00°43'25"E.
400.00'

S.00°43'25"E.
400.00'

S.00°43'25"E.
400.00'

S.00°43'25"E.
400.00'

S.00°43'25"E.
400.00'

S.00°43'25"E.
400.00'

S.00°43'25"E.
400.00'

S.00°43'25"E.
400.00'

S.00°43'25"E.
400.00'

S.00°43'25"E.
400.00'

S.00°43'25"E.
400.00'

S.00°43'25"E.
400.00'

S.00°43'25"E.
400.00'

S.00°43'25"E.
400.00'

S.00°43'25"E.
400.00'

LOCATION PLAN

Section 1

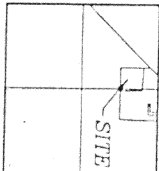

Logan Township
T-5-S, R-5-E, Auglaize
County, Ohio.

LEGEND

- Iron Pin w/cap Set
- Iron pin Found
- ⬢ P.K. Nail Set
- County Monument Box
- ⬢ P.K. Nail Found
- ⬢ 6" Wooden Corner Post
- ▲ R.R. Spike Found



Jaubert
surveying

11584 Monroe Road
Wapakoneta, Ohio
45895
(419) 657-6999

CLIENT: Jaubert Survey

COUNTY: Auglaize TOWNSHIP: Logan

DRAWN BY: J.W.J. SCALE: 1"=200' DWG. 98-930A

CHECKED BY: DATE: December, 1998

SHEET 1 OF 4 (T-5-S, R-5-E)

ATTEST:

John W. Jaubert
Professional Surveyor No. 6920

Graphic Scale



SURVEYORS DESCRIPTION FOR 3.000 ACRE TRACT

The following described tract of land is part of the Northeast Quarter of Section 1, Town 5 South, Range 5 East, Logan Township, Auglaize County, Ohio and is more particularly described as follows:

Commencing at a monument box at the Northwest corner of the Northeast Quarter of Section 1, Logan Township and in the centerline of Township Road 200 (Monroe Road);

thence N.89°16'35"E. along the centerline of Township Road 200 and the North line of the Northeast Quarter of Section 1, a distance of 200.00 feet to a R.R. spike found, which is the PLACE OF BEGINNING for the tract of land herein described;

thence continuing N.89°16'35"E. along the above described line, a distance of 435.60 feet to a P.K. Nail set;

thence S.00°43'25"E. a distance of 300.00 feet to an iron pin set, passing thru an iron pin set at 20.00 feet in the South right-of-way line of Township Road 200;

thence S.89°16'35"W., parallel to the centerline of Township Road 200 and the North line of the Northeast Quarter of Section 1, a distance of 435.60 feet to an iron pin set;

thence N.00°43'25"W. a distance of 300.00 feet to the R.R. spike, passing thru an iron pin set for reference at 280.00 feet in the South right-of-way line of Township Road 200, which was the true PLACE OF BEGINNING.

Containing in all 3.000 acre of which 0.200 acre has been dedicated for highway purposes. The above described tract of land is subject to all legal easements, restrictions and reservations, if any, of record or in use on said premises. Previous deed references: Volume OR 221, page 230. This plat is on file the Auglaize County Engineer's Office. Basis of bearings is per a previous survey by me as recorded in Survey Book "K" page 10, in the Auglaize County Engineer's Office.

ATTEST:

John W. Jauert
Professional Surveyor No. 6920

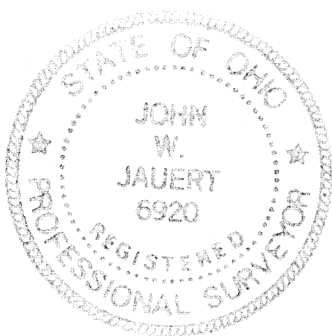

N-702

Jauert
surveying

11584 Monroe Road
Wapakoneta, Ohio
45895
(419) 657-6999

CLIENT:	John Jauert				
COUNTY:	Auglaize	TOWNSHIP:	Logan	SEC.	1
DRAWN BY:	J.W.J.	SCALE:	1" = 200'	DWG.	98-930A
CHECKED BY:		DATE:	December, 1998		
SHEET	2	OF	4		(T-5-S; R-5-E)

SURVEYORS DESCRIPTION FOR 2.000 ACRE TRACT

The following described tract of land is part of the Northeast Quarter of Section 1, Town 5 South, Range 5 East, Logan Township, Auglaize County, Ohio and is more particularly described as follows:

Commencing at a monument box at the Northwest corner of the Northeast Quarter of Section 1, Logan Township and in the centerline of Township Road 200 (Monroe Road);

thence N.89°16'35"E. along the centerline of Township Road 200 and the North line of the Northeast Quarter of Section 1, a distance of 635.60 feet to a P.K. Nail set, which is the PLACE OF BEGINNING for the tract of land herein described;

thence continuing N.89°16'35"E. along the above described line, a distance of 108.90 feet to a R.R. spike found;

thence S.00°43'25"E. a distance of 400.00 feet to a point, passing thru an iron pin set at 20.00 feet in the South right-of-way line of Township Road 200;

thence S.89°16'35"W., parallel to the centerline of Township Road 200 and the North line of the Northeast Quarter of Section 1, a distance of 544.50 feet to a point;

thence N.00°43'25"W. a distance of 100.00 feet to an iron pin set;

thence N.89°16'35"E., parallel to the centerline of Township Road 200 and the North line of the Northeast Quarter of Section 1, a distance of 435.60 feet to an iron pin set;

thence N.00°43'25"W. a distance of 300.00 feet to the R.R. spike, passing thru an iron pin set for reference at 280.00 feet in the South right-of-way line of Township Road 200, which was the true PLACE OF BEGINNING.

Containing in all 2.000 acre of which 0.050 acre has been dedicated for highway purposes. The above described tract of land is subject to all legal easements, restrictions and reservations, if any, of record or in use on said premises. Previous deed references: Volume OR 221, page 230. This plat is on file the Auglaize County Engineer's Office. Basis of bearings is per a previous survey by me as recorded in Survey Book "K" page 10, in the Auglaize County Engineer's Office.

ATTEST:

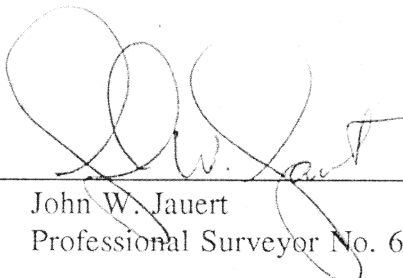
John W. Jauert

Professional Surveyor No. 6920

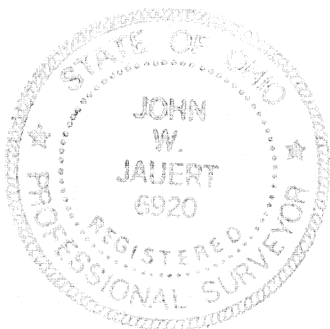

N-103

Jauert
surveying

11584 Monroe Road
Wapakoneta, Ohio
45895
(419) 657-6999

CLIENT: John Jauert

COUNTY: Auglaize TOWNSHIP: Logan SEC. 1

DRAWN BY: J.W.J. SCALE: 1" = 200' DWG. 98-930A

CHECKED BY: DATE: December, 1998

SHEET 3 OF 4 (T-5-S; R-5-E)

SURVEYORS DESCRIPTION FOR 12.077 ACRE TRACT

The following described tract of land is part of the Northeast Quarter and the Northwest Quarter of Section 1, Town 5 South, Range 5 East, Logan Township, Auglaize County, Ohio and is more particularly described as follows:

The PLACE OF BEGINNING is at a monument box at the Northwest corner of the Northeast Quarter of Section 1, Logan Township and in the centerline of Township Road 200 (Monroe Road);

thence N.89°16'35"E. along the centerline of Township Road 200 and the North line of the Northeast Quarter of Section 1, a distance of 15.89 feet to a P.K. Nail set;

thence S.00°41'36"E., parallel to the North-South 1/2 Section line, a distance of 598.93 feet to a 6" dia. wooden corner post found, passing thru an iron pin set for reference at 20.00 feet in the South right-of-way line of Township Road 200;

thence S.00°33'07"E. along an existing fence line, a distance of 709.68 feet to a point, passing thru a 6" dia. wooden corner post found at 704.26 feet;

thence S.89°41'29"W. a distance of 14.13 feet to a point;

thence S.89°39'51"W. a distance of 666.96 feet to an iron pin set;

thence N.00°41'36"W. a distance of 745.50 feet to a point;

thence S.87°20'02"E. along an existing fence line, a distance of 633.92 feet to an iron pin set, passing thru a 6" dia. wooden corner post found for reference at 7.30 feet;

thence N.00°41'36"W. a distance of 595.99 feet to a P.K. Nail set, passing thru an iron pin set for reference at 575.99 feet in the South right-of-way line of Township Road 200;

thence N.89°16'35"E. along the centerline of Township Road 200 and the North line of the Northwest Quarter of Section 1, Logan Township, a distance of 34.11 feet to the monument box which was the true PLACE OF BEGINNING.

Containing in all 12.077 acre of which 0.023 acre has been dedicated for highway purposes. 0.463 acre being located in the Northeast Quarter and 11.614 acre being located in the Northwest Quarter of Section 1, Logan Township. The above described tract of land is subject to all legal easements, restrictions and reservations, if any, of record or in use on said premises. Previous deed references: Volume OR 221, page 239. This plat is on file the Auglaize County Engineer's Office. Basis of bearings is per a previous survey by me as recorded in Survey Book "K" page 10, in the Auglaize County Engineer's Office.

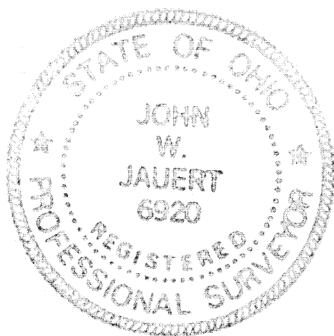

ATTEST:

A handwritten signature in cursive script, appearing to read "John W. Jauert", written over a horizontal line.

John W. Jauert
Professional Surveyor No. 6920

N-704

Jauert surveying		11584 Monroe Road Wapakoneta, Ohio 45895 (419) 657-6999
CLIENT: John Jauert		
COUNTY: Auglaize	TOWNSHIP: Logan	SEC. 1
DRAWN BY: J.W.J.	SCALE: 1" = 200'	DWG. 98-930A
CHECKED BY:	DATE: December, 1998	
SHEET 4 OF 4	(T-5-S; R-5-E)	