

**PLAT OF SURVEY**  
OF  
**O.L. No. 3, NORTH ADDITION TO TOWN OF BREMEN**  
&  
**SOUTH PT. O.L. No. 1, SHROEDER'S ADDN. OF O.L. TO NEW BREMEN**  
WEST PART SE/4 SECTION 10, TOWN 7 SOUTH, RANGE 4 EAST  
GERMAN TOWNSHIP AUGLAIZE COUNTY STATE OF OHIO  
FOR  
**CROWN EQUIPMENT CORPORATION**  
BY

FREYTAG & ASSOCIATES, INC.  
226 NORTH MIAMI AVENUE  
GEORGE P. FERNANDEZ  
MICHAEL R. HOLT

ARCHITECTS/ENGINEERS  
SIDNEY, OHIO 45365  
REGISTERED SURVEYOR #4079  
REGISTERED SURVEYOR #7108

SEPTEMBER 1992

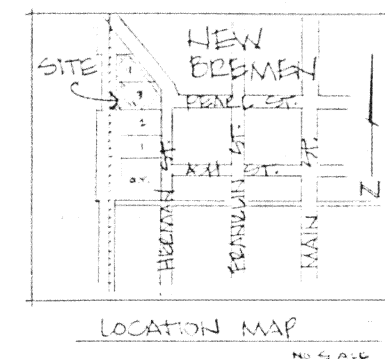
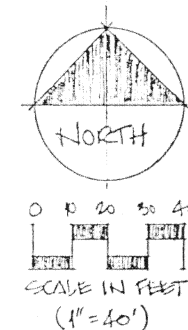

REFERENCE - NORTH ADDN TO THE TOWN OF BREMEN, MERCER CO. D.E.L. PG. 57  
AND SHROEDER'S ADDITION OF OUTLOTS TO NEW BREMEN, AUGLAIZE CO. P.B. 1, PG. 77.

I HEREBY STATE TO CROWN EQUIPMENT CORPORATION AND THE OHIO BAR TITLE INSURANCE COMPANY THAT THE DRAWING ATTACHED HERETO IS REPRESENTATIVE OF A TRUE AND ACCURATE SURVEY MADE BY MICHAEL R. HOLT, REGISTERED SURVEYOR #7108 OF FREYTAG AND ASSOCIATES, INC., THAT THE PREMISES WERE ESTABLISHED BY ACTUAL FIELD MEASUREMENTS; THAT MONUMENTS WERE FOUND OR SET HEREON; AND THAT ALL PROPERTIES SURVEYED AND DESCRIBED ON THE ATTACHED LEGAL DESCRIPTION ARE ENCLOSED WITHIN THE PERIMETER HEREIN;

I FURTHER STATE THAT THE RIGHT-OF-WAY LINE FOR HERMAN STREET IS COMPLETELY CONTIGUOUS TO THE PERIMETER LINE OF THE PREMISES ALONG THE ENTIRE RIGHT-OF-WAY AS NOTED AND SHOWN HEREON; I FURTHER STATE THAT THERE ARE NO BUILDINGS OR ABOVE-GROUND STRUCTURES OF ANY KIND, OR MONUMENTS, IRON PINS, OR ENCROACHMENTS, LOCATED ON SAID PROPERTY AT THE DATE OF THIS SURVEY, OTHER THAN THESE SHOWN HEREON.

*Michael R. Holt*  
MICHAEL R. HOLT

SEPT. 13, 1992  
DATE

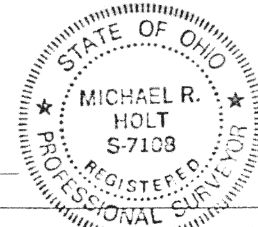

N-152

**LEGAL DESCRIPTION  
FOR  
OUTLOT No.3, NORTH ADDITION TO NEW BREMEN  
&  
SOUTH PT. OUTLOT No.1, SHROEDER'S ADD'N. OF OUTLOTS TO NEW BREMEN  
(MAGOTO TRACTS)**

Situate in Outlot No.3 of the North Addition to the Town of Bremen (as recorded in Mercer County Deed Book L, Pages 57 & 58) and the south part of Outlot No.1 of Shroeder's Addition of Outlots to New Bremen (as recorded in Plat Book 1, Page 77 of the records of Auglaize County) German Township, Auglaize County, State of Ohio, and being more particularly described as follows, to-wit:

Comencing at a boat spike found at the intersection of the centerlines of Herman Street and Pearl Street in the Village of New Bremen;

thence, South 2 degrees 37' 00" East, 22.02 feet along the centerline of Herman Street to a masonry nail set;

thence, South 87 degrees 44' 17" West, 24.75 feet to the southeast corner of the aforesaid Outlot No.3 on the west right-of-way line of Herman Street and, also, the point of beginning of the herein described tract;

thence, South 87 degrees 44' 17" West, 227.37 feet along the north line of Outlot No.2 of the aforesaid North Addition to the Town of Bremen to a 5/8 inch iron pin set on the east line of the former Lake Erie & Louisville Railroad (now owned by the Western Ohio Railway Authority), as recorded in Deed Volume 39, Page 84 of the records of Auglaize County, reference a 5/8 inch iron pin found at 0.36 feet and, also, a 5/8 inch iron pin found South 85 degrees 29' 06" West, 10.15 feet from said southwest corner of Outlot No.3;

thence, North 2 degrees 09' 40" West, 331.00 feet along the east line of said railroad tract to the northwest corner of the herein described tract, reference a 5/8 inch iron pin found North 59 degrees 00' 24" East, 1.81 feet and, also, a 5/8 inch iron pin set at the southwest corner of Outlot No.1 of the aforesaid Shroeder's Addition of Outlots to New Bremen at 165.00 feet from the southwest corner of said Outlot No.3;

thence, North 87 degrees 44' 17" East, 68.80 feet along the south line of a tract now, or formerly, owned by John Earl Voress, as recorded in Official Record 20, Page 21 of the records of Auglaize County, to a point on the westerly right-of-way line of Herman Street (also known as the Piqua-St. Marys Road and, being known as County Road 66-A outside the corporation limits of New Bremen), reference a 5/8 inch iron pin found South 32 degrees 55' 25" East, 1.17 feet;

thence, South 40 degrees 31' 27" East, 253.80 feet along the westerly right-of-way line of Herman Street to a 5/8 inch iron pin set, reference a 5/8 inch iron pin set at the southeasterly corner of the aforesaid Outlot No.1 at 211.42 feet;

thence, South 2 degrees 37' 00" East, 131.73 feet along the west right-of-way line of Herman Street to the point of beginning.

Containing 1.361 acres, more or less, with 0.849 acre, more or less, in Outlot No.3, and 0.512 acre, more or less, in Outlot No.1.

W. 752A

Subject to all easements of record.

Being the same tract conveyed to Cletus H. Magoto, Jr. and Rose M. Magoto, as recorded in Deed Volume 195, Page 583 of the records of Auglaize County.

The starting bearing South 2 degrees 37' 00" East, along the centerline of Herman Street, is based on an assumed meridian and is used to denote angles only.

Reference a Plat of Survey of Outlot No.3 in the North Addition to New Bremen and the South Part of Outlot No.1 in Shroeder's Addition of Outlots to New Bremen as filed in the records of the Auglaize County Engineer (Tax Map Office).

The above description prepared by Michael R. Holt, Registered Surveyor #7108, of Freytag and Associates, Inc., 226 North Miami Avenue, Sidney, Ohio, from a field survey performed by same on September 15, 1992.

N-752B