

# WIESENMAYER SURVEY

1.780 Acres being a part of the South Half of the Southwest Quarter  
of Section 17, Clay Township, Town-6-South, Range-7-East,  
County of Auglaize, State of Ohio

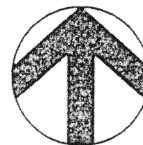

## LEGEND

- Iron Pin (set)
- Iron Pin (found)
- Monument Box
- ▲ P.K. Nail/Shiner (set)

## LOCATION PLAN

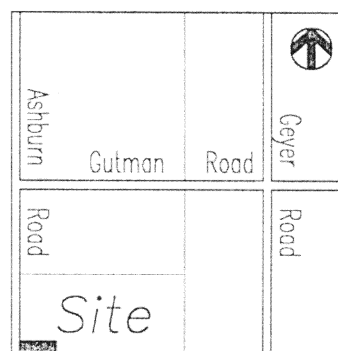

Section 17, Clay Twp.  
Auglaize County, Ohio

## PREVIOUS DEED REFERENCES

Volume 255  
Page 44

## SCALE



## ATTEST

*Ted K. Schnell*

Ted K. Schnell  
Professional Engineer  
Professional Surveyor

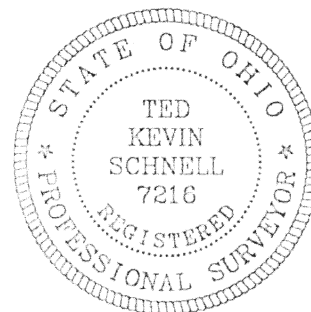
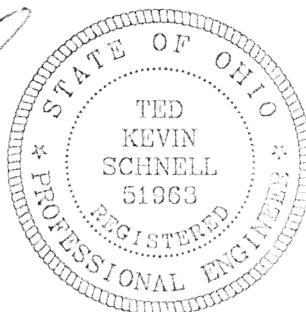

S. 89°-33'-48" E.

420.00'

1.780 Acres

(0.106 Acre R/W)

S. 00°-35'-44" W.

184.51'

420.00'

N. 89°-33'-48" W.

N. 00°-35'-44" E.

184.51'

FREYBURG  
EAST

Volume 255  
Page 44

South Line of the Southwest Quarter of  
Section 17, Clay Township

Volume OR 330  
Page 240

## NOTES

The Basis of Bearings used for this Survey was determined  
from the Auglaize County Engineer's Global Positioning Survey

This Survey Plat and Description is Recorded in Survey Book 6,

Page 49, Auglaize County Engineer's Tax Map Office.

NOTE: The Auglaize County Board of Commissioners reserves a  
permanent maintenance drainage easement on the open ditch which  
measures 25 feet perpendicular from the top of the ditch bank on  
each side of the open ditch.

## H & S Civil Engineers and Land Surveyors

913 Fieldstone Court Wapakoneta, Ohio 45895

R.C. WIESENMAYER

client

17

section

CLAY

township

AUGLAIZE

county

OHIO

state

07/24/02

date



0-49

SURVEYOR'S DESCRIPTION  
1.780 ACRE PARCEL

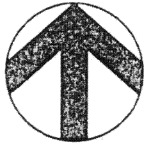

The following described parcel of land is situated in the Southwest Quarter of Section 17, Clay Township, Town-6-South, Range-7-East, Auglaize County, Ohio, and is more particularly described as follows:

Commencing at a Monument Box (found) at the Southwest Corner of the Southwest Quarter of said Section 17, Clay Township, and the PLACE OF BEGINNING;

Thence with a bearing of N. 00°-35'-44" E. along the West Line of the Southwest Quarter of said Section 17, Clay Township, for a distance of 184.51 feet to a P.K. Nail/Shiner (set);

Thence with a bearing of S. 89°-33'-48" E. for a distance of 420.00 feet to an Iron Pin (set), and passing thru an Iron Pin (set) for reference at 25.00 feet;

Thence with a bearing of S. 00°-35'-44" W. and parallel with the West Line of the Southwest Quarter of said Section 17, Clay Township, for a distance of 184.51 feet to an Iron Pin (set);

Thence with a bearing of N. 89°-33'-48" W. along the South Line of the Southwest Quarter of said Section 17, Clay Township, for a distance of 420.00 feet to a Monument Box (found), and passing thru an Iron Pin (set) at a distance of 395.00 feet, said Monument Box being the original PLACE OF BEGINNING.

Containing in all 1.780 Acres of Land, of which, 0.106 Acre being previously dedicated for highway purposes.

The above described parcel of land is subject to a permanent maintenance ditch easement being more particularly described as a 25 foot strip of ground as measured perpendicular from the top and along the Northerly bank of an existing open drainage ditch located in part on said premises, said easement being prescribed to the Board of Commissioners of Auglaize County for the purpose of the permanent maintenance of said open ditch.

Previous Deed References: Deed Volume 255, Page 44, Auglaize County Recorder's Office.

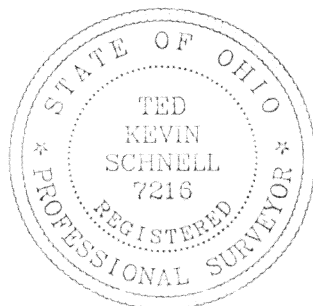
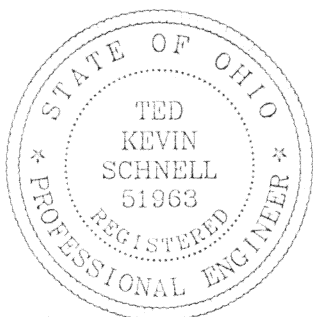

Prepared by:

Ted K. Schnell  
Professional Engineer  
Professional Surveyor

H & S Civil Engineers and Land Surveyors

913 Fieldstone Court Wapakoneta, Ohio 45895

R.C. WIESENMYER  
client

17  
section

CLAY  
township

AUGLAIZE  
county

OHIO  
state

07/24/02  
date

