

WATERCUTTER SURVEY Reference OR 457 Page 1011

SECTION 34 TOWN 5 SOUTH RANGE 5 EAST MOULTON TOWNSHIP
AUGLAIZE COUNTY OHIO

State Route # 33

LEGEND

"A" = Iron Bar Found
"B" = Wood Corner Post Found
"C" = PK Spike Set
"D" = PK Nail Found
"E" = RR Spike Found
"F" = County Monument Box
"G" = Steel Corner Post

Basis of Bearings ~ See Survey Book "L" Page 325

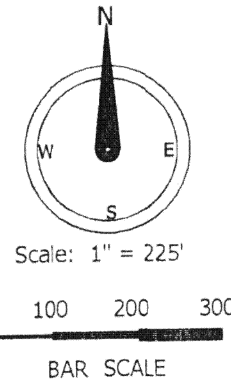
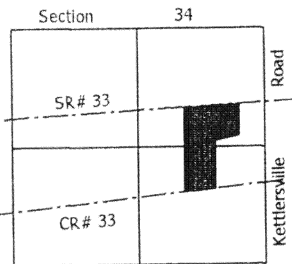

18.371 Acres
(0.535 Ac in existing road R/W)

(12.388 Ac North East
Quarter Section 34)

(5.983 Ac South East
Quarter Section 34)

Error of Closure N 87° 26' E 4.82'
OR 242/404

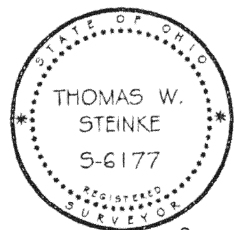

Thomas W. Steinke
Thomas W. Steinke

County Road # 33-A

Prepared by:
Thomas W. Steinke
Registered Surveyor # 6177
16454 CR# 25-A
Anna, Ohio 45302
Phone: 937-693-6538

SE Corner
Section 34
Section Line

Kettlersville Road

NE Corner
SE Quarter
Section 34

"D"

"F"

"G"

"C"

"B"

"A"

"E"

"C"

"E"

"C"

"E"

"C"

"E"

"C"

"E"

"C"

"E"

"C"

"E"

"C"

"E"

"C"

"E"

"C"

"E"

"C"

"E"

"C"

"E"

"C"

"E"

"C"

"E"

"C"

"E"

"C"

"E"

"C"

"E"

"C"

"E"

"C"

"E"

"C"

"E"

"C"

"E"

"C"

"E"

"C"

"E"

"C"

"E"

"C"

"E"

"C"

"E"

"C"

"E"

"C"

"E"

"C"

"E"

"C"

"E"

"C"

"E"

"C"

"E"

"C"

"E"

"C"

"E"

"C"

"E"

"C"

"E"

"C"

"E"

"C"

"E"

"C"

"E"

"C"

"E"

"C"

"E"

"C"

"E"

"C"

"E"

"C"

"E"

"C"

"E"

"C"

"E"

"C"

"E"

"C"

"E"

"C"

"E"

"C"

"E"

"C"

"E"

"C"

"E"

"C"

"E"

"C"

"E"

"C"

"E"

"C"

"E"

"C"

"E"

"C"

"E"

"C"

"E"

"C"

"E"

"C"

"E"

"C"

"E"

"C"

"E"

"C"

"E"

"C"

"E"

"C"

"E"

"C"

"E"

"C"

"E"

"C"

"E"

"C"

"E"

"C"

"E"

"C"

"E"

"C"

"E"

"C"

"E"

"C"

"E"

"C"

"E"

"C"

"E"

"C"

"E"

"C"

"E"

"C"

"E"

"C"

"E"

"C"

"E"

"C"

"E"

"C"

"E"

"C"

"E"

"C"

"E"

"C"

"E"

"C"

"E"

"C"

"E"

"C"

"E"

"C"

"E"

"C"

"E"

"C"

"E"

"C"

"E"

"C"

"E"

"C"

"E"

"C"

"E"

"C"

"E"

"C"

"E"

"C"

"E"

"C"

"E"

"C"

"E"

"C"

"E"

"C"

"E"

"C"

"E"

"C"

"E"

"C"

"E"

"C"

"E"

"C"

"E"

"C"

"E"

"C"

"E"

"C"

"E"

"C"

"E"

"C"

"E"

Thomas W. Steinke
Registered Surveyor # 6177

16454 CR# 25-A

Anna, Ohio 45302

Phone: (937) 693 – 6538

E-mail: tssurvey@bright.net

Fax: (937) 693 – 2068

Date: September 24, 2002

Being 18.371 Acres located in the east half of Section 34, Town 5 South, Range 5 East, Moulton Township, Auglaize County, Ohio and being further described as follows:

Commencing at a monument box located at the Northeast corner of the Southeast quarter of Section 34;

Thence South $00^{\circ} 00'$ West along the east line of Section 34 and centerline of Kettlersville Road, a distance of 282.15 feet to a PK Nail found in the centerline of CR# 33-A;

Thence South $80^{\circ} 04' 35''$ West along the centerline of CR# 33-A (See SH 165 Sec A1-A2-A3-B1-B2 State of Ohio R/W Plans), a distance of 784.53 feet to a PK Spike set and PLACE OF BEGINNING for the parcel herein described;

Thence continuing south $80^{\circ} 04' 35''$ West along the centerline of CR# 33-A, a distance of 582.49 feet to a PK Spike set;

Thence North $00^{\circ} 10' 04''$ East, a distance of 1157.07 feet to an iron bar found in the south R/W Line of US Route # 33 (See Auglaize 33 6.25 state of Ohio r/W Plans);

Thence North $82^{\circ} 53' 28''$ East along said R/W Line, a distance of 897.53 feet to a point, passing through an iron bar found at 886.03 feet;

Thence South $01^{\circ} 09' 33''$ East, a distance of 92.96 feet to a wood corner post;

Thence south $00^{\circ} 20' 34''$ East, a distance of 355.30 feet to an iron bar found;

Thence South $80^{\circ} 24'$ West, a distance of 330.00 feet to an iron bar found;

Thence South $00^{\circ} 05' 50''$ East, a distance of 664.49 feet to the PLACE OF BEGINNING.

Containing in all 18.371 Acres (of which 0.535 acre in road right of way) (12.388 Ac in NE Qtr. Section 34 & 5.983 Ac in SE Qtr. Section 34). Survey and description prepared by Thomas W. Steinke, Registered Surveyor # 6177 on this 21st day of September, 2002 and based upon existing recorded documents. Basis of bearings ~ see Survey Book "L" Page 325

0-92