

# SURVEY FOR JEFF OTT

1.106 Acres being a part of the West Half of the Southwest Quarter of  
of Section 29, Pusheta Township, Town-6-South, Range-6-East,  
County of Auglaize, State of Ohio



West Line of the Southwest Quarter of  
Section 29, Pusheta Township

## PREVIOUS DEED REFERENCES

Volume 260

Page 655

## LEGEND

- Iron Pin (set)
- Iron Pipe (found)
- △ Mag Nail/Shiner (set)
- ▲ Railroad Spike (found)
- Monument Box

## LOCATION PLAN

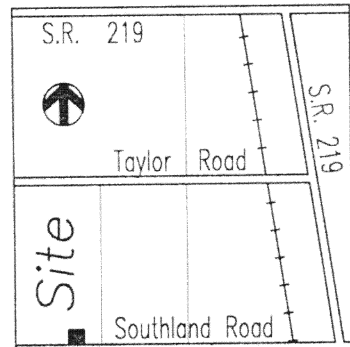

Section 29, Pusheta Twp.  
Auglaize County, Ohio

## ATTEST

*Ted K. Schnell*

Ted K. Schnell  
Professional Engineer  
Professional Surveyor

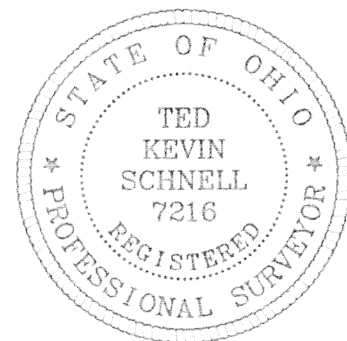

## SCALE



## NOTES

The Basis of Bearings used for this Survey was determined  
from the Auglaize County Engineer's Global Positioning Survey

This Survey Plot and Description is Recorded in Survey Book

0, Page 121, Auglaize County Engineer's Tax  
Map Office.

## H & S Civil Engineers and Land Surveyors

913 Fieldstone Court Wapakoneta, Ohio 45895

JEFF OTT  
client

29  
section

PUSHETA  
township

AUGLAIZE  
county

OHIO  
state

11/14/02  
date



0-121

# H & S Civil Engineers and Land Surveyors

913 Fieldstone Court  
Wapakoneta, Ohio 45895  
Phone (419) 738-4758  
Fax (419) 739-7631  
E-Mail hscivil@bright.net

Ted K. Schnell P.E., P.S.  
Gregory B. Huber P.E.

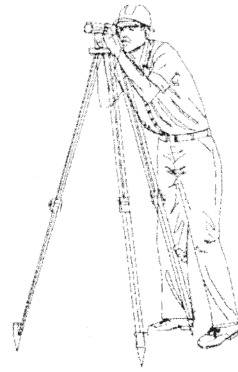

11/14/02

## SURVEYOR'S DESCRIPTION FOR 1.106 ACRE PARCEL SPLIT

The following described tract of land is situated in the West Half of the Southwest Quarter of Section 29, Pusheta Township, Town-6-South, Range-6-East, Auglaize County, Ohio, and is more particularly described as follows:

Commencing for reference at a Monument Box located at the Southwest Corner of the Southwest Quarter of said Section 29, Pusheta Township;

Thence with a bearing of S. 89°-05'-42" E. along the South Line of the Southwest Quarter of said Section 29, Pusheta Township, and the centerline of Southland Road, (Township Road #90), for a distance of 882.53 feet to a Mag Nail/Shiner (set) and the PLACE OF BEGINNING;

Thence with a bearing of N. 01°-05'-38" E. for a distance of 208.27 feet to an Iron Pin (set), and passing thru an Iron Pin (set) for reference at 20.00 feet;

Thence with a bearing of S. 89°-05'-42" E. and parallel with the South Line of the Southwest Quarter of said Section 29, Pusheta Township, and the centerline of Southland Road, (Township Road #90), for a distance of 231.37 feet to an Iron Pipe (found);

Thence with a bearing of S. 01°-05'-38" W. for a distance of 208.27 feet to a Mag Nail/Shiner (set), and passing thru an Iron Pin (set) for reference at 188.27 feet, said Mag Nail/Shiner (set) also being referenced by a Railroad Spike (found) at S. 01°-05'-38" W. and 0.44 feet;

Thence with a bearing of N. 89°-05'-42" W. along the South Line of the Southwest Quarter of said Section 29, Pusheta Township, and the centerline of Southland Road, (Township Road #90), for a distance of 231.37 feet to a Mag Nail/Shiner (set) and the original PLACE OF BEGINNING.

Containing in all 1.106 Acres of land, of which, 0.106 Acre being previously dedicated for highway purposes. The above described tract of land is also subject to all other legal easements, reservations, or restrictions, if any, upon said premises.

Previous Deed References: DEED VOLUME 260, PAGE 655, Auglaize County Recorder's Office.

PREPARED BY:

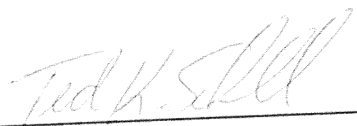
  
Ted K. Schnell  
Professional Engineer  
Professional Surveyor

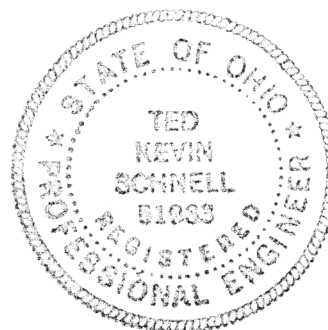

0-122