

SURVEYED BY

James W. Geeslin
JAMES W. GEESLIN
P.S. No. 7764

LEGEND

- = IRON BAR IN MON. BOX FOUND.
- ⌘ = P.K. NAIL FOUND.
- = 5/8 INCH IRON BAR FOUND.
- ⌘ = SPINDLE SET.
- ⊙ = 5/8 INCH IRON BAR SET.

N.W. COR.
N.E. 1/4
SEC. 30

N. LINE - N.E. 1/4 - SEC. 30 & STATE ROUTE 119

N 89°41'30" E 2668.05'

244.60'

192.88'

349.61'

1880.96'

N.E. 1/4
SEC. 30

55.00'

55.00'

26.99'
10.00'

45.00'
126.31'

R/W LINE

TRACT ONE
1.787 TOTAL ACRES
(0.309 AC. IN R/W)

TRACT TWO
1.304 TOTAL ACRES
(0.238 AC. IN R/W)

LOCATION SKETCH

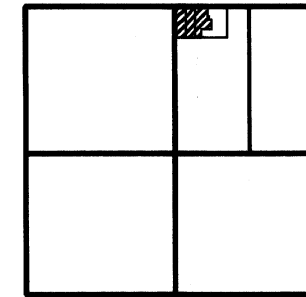

SECTION 30

S 01°13'09" W 41.51'

S 89°57'49" E 21.56'

S 89°46'34" E 23.85'

S 01°40'14" W 52.60'

S 00°42'44" V 99.45'

N 89°25'54" W 125.59'

O. & P. HEITKAMP
V. 238 PG. 159
(2.659 ACRES REMAINING)

244.60'

111.27'

431.22'

S 89°41'30" W 787.09'

HEITKAMP SURVEY

PART OF THE W. 1/2 OF THE N.E. 1/4 OF SECTION 30, TOWN 7 SOUTH, RANGE 4 EAST,
(JACKSON TOWNSHIP), AUGLAIZE COUNTY, OHIO.

OCTOBER 15, 2003



SCALE 1" = 60'

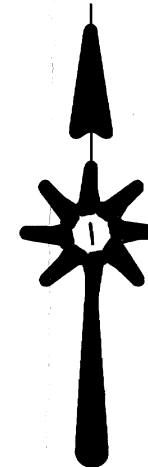

PERMANENT
PARCEL No.

Part of: Sec. T R Township

Grantor: Area Retained: Acres

Grantee: Area Transferred: Acres

Deed References:

APPROVALS
DATE

Board of Health

Township Zoning Officer

County Engineer

GEESLIN
LAND SURVEYING

P.O. BOX 422
CELINA, OHIO
PHONE (419) 586-6155
FAX (419) 678-9332

0-412

October 15, 2003

HEITKAMP SURVEY DESCRIPTION (TRACT ONE)

Being a parcel of land situated in Jackson Township, Auglaize County, Ohio, in the west half of the northeast quarter of Section 30, Township 7 South, Range 4 East. Being more particularly described as follows :

Beginning at a P.K. nail at the northwest corner of the northeast quarter of said Section 30 -

Thence, North 89°41'30" East, along the north line of the northeast quarter of said Section 30 and the centerline of State Route 119, a distance of 244.60 feet to a spindle -

Thence, South 00°10'06" West, a distance of 318.25 feet to a 5/8 inch iron bar -

Thence, South 89°41'30" West, a distance of 244.60 feet to a 5/8 inch iron bar -

Thence, North 00°10'06" East, along the west line of the northeast quarter of said Section 30, a distance of 318.25 feet to the place of beginning.

Containing 1.787 acres of land more or less.

Subject to all easements and right-of-way of record.

Reference is made to a survey of this area by James W. Geeslin, Professional Surveyor 7764, dated October 15, 2003. On file in the County Engineer's Office.

Surveyed by

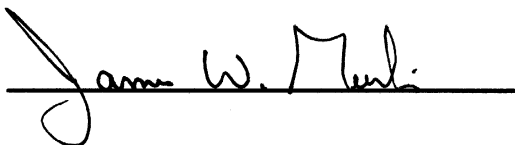

James W. Geeslin
P.S. 7764

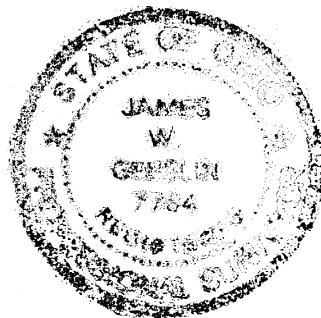

**GEESLIN
LAND SURVEYING**

P.O. BOX 422
CELINA, OHIO 45822
PHONE: (419) 586-6155
FAX: (419) 678-9332

PERMANENT
PARCEL No.

Part of _____ Sec. _____ T. _____ R. _____ Township

Grantor: _____ Area Retained: _____ Acres

Grantee: _____ Area Retained: _____ Acres

Deed References: _____

APPROVALS
AGENCY

Board of Health

Date

Township Zoning Officer

Date

County Engineer

Date

0-413

* Douglas Heitkamp tract

October 15, 2003

HEITKAMP SURVEY DESCRIPTION (TRACT TWO)

Being a parcel of land situated in Jackson Township, Auglaize County, Ohio, in the west half of the northeast quarter of Section 30, Township 7 South, Range 4 East. Being more particularly described as follows :

Commencing for reference at a P.K. nail at the northwest corner of the northeast quarter of said Section 20 -

Thence, North 89°41'30" East, along the north line of the northeast quarter of said Section 30 and the centerline of State Route 119, a distance of 244.60 feet to a spindle. Said point being the place of beginning for the parcel of land to be conveyed by this instrument -

Thence, continuing, North 89°41'30" East, along the last described line, a distance of 192.88 feet to a P.K. nail -

Thence, South 00°34'54" East, a distance of 126.31 feet to a 5/8 inch iron bar -

Thence, South 89°57'49" East, a distance of 21.56 feet to a 5/8 inch iron bar -

Thence, South 01°13'09" West, a distance of 41.51 feet to a 5/8 inch iron bar -

Thence, South 89°46'34" East, a distance of 23.85 feet to a 5/8 inch iron bar -

Thence, South 01°40'14" West, a distance of 52.60 feet to a 5/8 inch iron bar -

Thence, North 89°25'54" West, a distance of 125.59 feet to a 5/8 inch iron bar -

Thence, South 00°42'44" West, a distance of 99.45 feet to a 5/8 inch iron bar -

Thence, South 89°41'30" West, a distance of 111.27 feet to a 5/8 inch iron bar -

Thence, North 00°10'06" East, a distance of 318.25 feet to the place of beginning.

Containing 1.304 acres of land more or less.

Subject to all easements and right-of-way of record.

Reference is made to a survey of this area by James W. Geeslin, Professional Surveyor 7764, dated October 15, 2003. On file in the County Engineer's Office.

Surveyed by James W. Geeslin
James W. Geeslin
P.S. 7764



**GEESLIN
LAND SURVEYING**

P.O. BOX 422
CELINA, OHIO 45822

PHONE: (419) 586-6155
FAX: (419) 678-9332

PERMANENT PARCEL No. _____			
Part of _____ Sec. _____ T. _____ R. _____ Township _____			
Grantor: _____		Area Retained: _____ Acres	
Grantee: _____		Area Retained: _____ Acres	
Deed References: _____			
APPROVALS AGENCY: _____		APPROVALS AGENCY: _____	
Board of Health _____ Date _____		Township Zoning Officer _____ Date _____	
		County Engineer _____ Date _____	

0-414

April 5, 2004

HEITKAMP SURVEY DESCRIPTION (REMAINING ACREAGE)

Being a parcel of land situated in Jackson Township, Auglaize County, Ohio, in the west half of the northeast quarter of Section 30, Township 7 South, Range 4 East. Being more particularly described as follows :

Commencing for reference at a P.K. nail at the northwest corner of the northeast quarter of said Section 20 -

Thence, North 89°41'30" East, along the north line of the northeast quarter of said Section 30 and the centerline of State Route 119, a distance of 437.48 feet to a p.k. nail. Said point being the place of beginning for the parcel of land to be conveyed by this instrument -

Thence, South 00°34'54" East, a distance of 126.31 feet to a 5/8 inch iron bar -

Thence, South 89°57'49" East, a distance of 21.56 feet to a 5/8 inch iron bar -

Thence, South 01°13'09" West, a distance of 41.51 feet to a 5/8 inch iron bar -

Thence, South 89°46'34" East, a distance of 23.85 feet to a 5/8 inch iron bar -

Thence, South 01°40'14" West, a distance of 52.60 feet to a 5/8 inch iron bar -

Thence, North 89°25'54" West, a distance of 125.59 feet to a 5/8 inch iron bar -

Thence, South 00°42'44" West, a distance of 99.45 feet to a 5/8 inch iron bar -

Thence, North 89°41'30" East, a distance of 431.22 feet to a point -

Thence, North 01°10'06" East, a distance of 318.25 feet to a point -

Thence, South 89°41'30" West, along the north line of the northeast quarter of said Section 30 and the centerline of State Route 119, a distance of 349.61 feet to the place of beginning.

Containing 2.659 acres of land more or less.

Subject to all easements and right-of-way of record.

Reference is made to a survey of this area by James W. Geeslin, Professional Surveyor 7764, dated April 5, 2004. On file in the County Engineer's Office.

Surveyed by

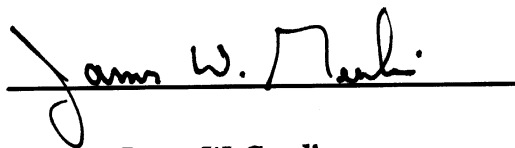

James W. Geeslin
P.S. 7764

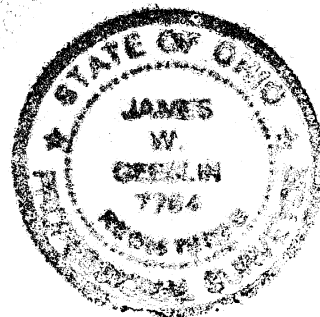

**GEESLIN
LAND SURVEYING**

P.O. BOX 422
CELINA, OHIO 45822
PHONE: (419) 586-6155
FAX: (419) 678-9332

PERMANENT
PARCEL No.

Part of _____ Sec. _____ T. _____ R. _____ Township _____

Grantor: _____ Area Retained: _____ Acres
Grantee: _____ Area Retained: _____ Acres

Deed References: _____

APPROVALS
AGENCY:

Board of Health

Date

Township Zoning Officer

Date

County Engineer

Date

0-414A