

BOUNDARY SURVEY OF PART OF PARCEL # B05-006-006-00 AS DESCRIBED IN VOL. 272, PG. 171 OF THE AUGLAIZE COUNTY OFFICIAL RECORD OF DEEDS. SITUATED IN THE SE 1/4 OF THE NORTHWEST FRACTIONAL QUARTER OF SECTION 6, TOWN 5S, RANGE 6E, DUCHOUQUET TOWNSHIP, AUGLAIZE COUNTY, OHIO.

Note 1: Basis of Bearings assumes the West line of the SW 1/4 of the Northwest Fractional Quarter of Section 6, also being the centerline of Short Line Road (T.R. 131), as S 00°-37'-25" W.
 Note 2: The West Line of the SE 1/4 of the Northwest Fractional Quarter of Section 6 was established by proration of the original government survey of said Section.

- LEGEND**
- A - SET #5 REBAR
 - B - RAILROAD SPIKE FOUND
 - C - #5 REBAR (PS 6470) FOUND
 - D - CONCRETE POST FOUND
 - E - ANGLE IRON CORNER POST FOUND

Eric R. Pfennig
 ERIC R. PFENNING P.S. #8129
 THIS SURVEY REPRESENTS AN ACTUAL FIELD SURVEY PREFORMED UNDER MY SUPERVISION ON DECEMBER 17, 2003.

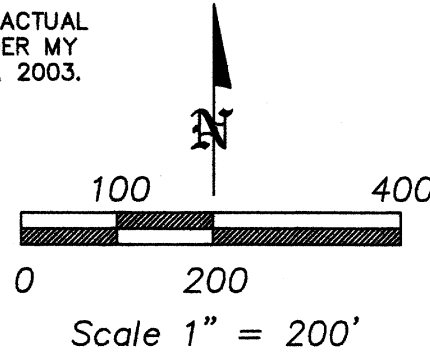
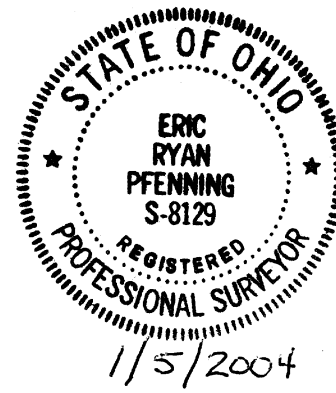

ANGLE RIGHT, LTD	
1105 POPPY DRIVE WAPAKONETA, OHIO 45895 (419) 738-6264	
CLIENT: NICK HEITZ	
OWNER: DORIS I. SUNDERLAND, TRUST	
DATE: DECEMBER 17, 2003	
COUNTY: AUGLAIZE	SECTION: 6
TOWNSHIP: DUCHOUQUET	
SCALE: 1" = 200'	SHEET 1 OF 2

This Plat is recorded in Survey Book 0, Page 455 in the Auglaize County Engineer's Office.

0-455

PARCEL 1
LEGAL DESCRIPTION

Being part of Parcel #B05-006-006-00 as described in Volume 272, Page 171 of the Auglaize County Official Record of Deeds. Situated in the SE ¼ of the Northwest Fractional Quarter of Section 6, T 5 S, R 6 E, Duchouquet Township, County of Auglaize, State of Ohio a tract of land bounded and described as follows:

Commencing at a railroad spike found at the northwest corner of the SW ¼ of the Northwest Fractional Quarter of Section 6, in the intersection of Short Line Road (T.R. 131) and Ritchie Road (T.R. 198); Thence along the west line of said SW ¼ of the Northwest Fractional Quarter of Section 6, also being the centerline of Short Line Road (T.R. 131), S 00°-37'-25" W (basis of bearing), a distance of 1,327.44 feet to a railroad spike found at the southwest corner of said SW ¼ of the Northwest Fractional Quarter of Section 6;

thence along the south line of said Northwest Fractional Quarter of Section 6, N 89°-37'-07" E, a distance of 1,242.43 feet to a set #5 rebar marking the southwest corner of said SE ¼ of the Northwest Fractional Quarter of Section 6, also being the POINT OF BEGINNING for the tract of land herein described;

thence along the west line of said SE ¼ of the Northwest Fractional Quarter, N 00°-38'-53" E, a distance of 663.39 feet to a set #5 rebar;

thence, N 89°-38'-02" E, a distance of 668.07 feet to a set #5 rebar;

thence along the east line of the SW ¼ of said SE ¼ of the Northwest Fractional Quarter, S 00°-50'-57" W, a distance of 663.26 feet to set #5 rebar on the south line of said Northwest Fractional Quarter, marking the southeast corner of the SW ¼ of said SE ¼ of the Northwest Fractional Quarter of Section 6;

thence along said south line of the Northwest Fractional Quarter of Section 6, S 89°-37'-07" W, a distance of 665.75 feet to the POINT OF BEGINNING.

The above described parcel contains 10.154 acres of land, subject to all legal highways and easements of record at the time of recording of this instrument.

Basis of bearing for this legal description assumes the west line of the SW ¼ of the Northwest Fractional Quarter of Section 6, also being the centerline of Short Line Road (T.R. 131) as being S 00°-37'-25" W. This legal description and accompanying plat represents an actual boundary survey performed by Eric R. Pfenning, PS # 8129 on December 17, 2003. All set #5 rebar are marked with a yellow plastic cap stamped "Eric Pfenning PS # 8129".



This legal description is recorded in
Survey Book 0, Page 456 in the
Auglaize County Engineer's Office

Eric R. Pfenning
Eric R. Pfenning, PS # 8129

Angle Right, Ltd.
1105 Poppy Drive
Wapakoneta, Ohio 45895