

School Street
(50')

SURVEY FOR DAVID WHITAKER

1.177 Acres being a part of the Northwest Quarter
of Section 4, Goshen Township, Town-6-South, Range-8-East,
County of Auglaize, State of Ohio

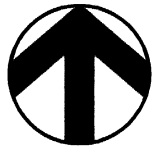

LOCATION PLAN

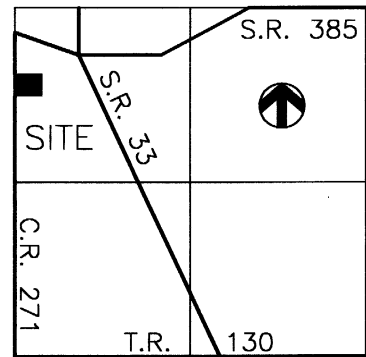

Section 4
Goshen Township

This Survey Plat and Description is Recorded in Survey Book

0, Page 612, Auglaize County Engineer's Tax Map Office.

SCALE



DP&L
SubStation
Vol 139
Page 274

See
NOTE #3

N. 83°-52' E.
84.82'

N. 83°-52' E.
212.00'

NOTES

- #1 Mag Nail set on line, 0.21' West of Iron Bar found
- #2 Reference to property corner Iron Bar (found) at a bearing S. 83°-54'-17" W. at 0.34'
- #3 P.K. Nail found on line 0.51' West of Iron Bar found

LEGEND

- Iron Pin (found)
- Iron Pin (set)
- ▲ Mag Nail/Shiner (set)
- △ P.K. Nail/Shiner (found)
- Monument Box

ATTEST

Ted K. Schnell

Ted K. Schnell
Professional Engineer
Professional Surveyor

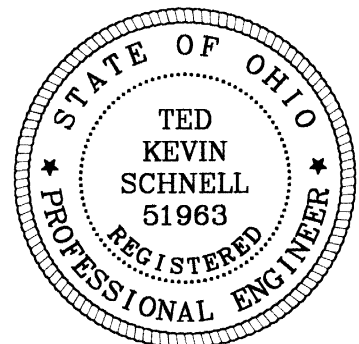

1.177 Acres
(0.101 Ac. R/W)

N. 83°-54'-17" E.
193.12'

Iron Pin
at 20.00'

N. 05°-35' W.
220.40'

Iron Pin
at 20.84'

S. 83°-54'-17" W.
272.00'

See NOTE #2

See NOTE #1

Southwest Corner,
Northwest Quarter,
Section 4
Goshen Twp.

BASIS OF BEARINGS

The Basis of Bearings used for this Survey was determined from previous surveys
of record and on file with the Auglaize County Engineer's Tax Map Office.

H & S Civil Engineers and Land Surveyors

913 Fieldstone Court Wapakoneta, Ohio 45895

DAVID WHITAKER
client

4
section

GOSHEN
township

AUGLAIZE
county

OHIO
state

08/08/04
date



0-612

H & S Civil Engineers and Land Surveyors

913 Fieldstone Court

Wapakoneta, Ohio 45895

Phone (419) 738-4758

Fax (419) 739-7631

email: hscivil@bright.net

Ted K. Schnell P.E., P.S.

Gregory B. Huber P.E.

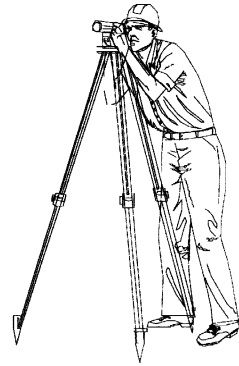

08/08/04

SURVEYOR'S DESCRIPTION FOR 1.177 ACRE PARCEL SPLIT

The following described Parcel of land is a part of the Northwest Quarter of Section 4, Goshen Township, Town-6-South, Range-8-East, Auglaize County, Ohio, and is more particularly described as follows:

Commencing for reference at a Monument Box (found) located at the Southwest Corner of the Northwest Quarter of said Section 4, Goshen Township;

Thence with a bearing of N. 05°-35' W. along the West Line of the Northwest Quarter of said Section 4, Goshen Township, and the centerline of McBeth Road (C.R. 271), for a distance of 634.56 feet to a Mag Nail/Shiner (set) and the PLACE OF BEGINNING;

Thence continuing with a bearing of N. 05°-35' W. along the West Line of the Northwest Quarter of said Section 4, Goshen Township, and the centerline of McBeth Road (C.R. 271), for a distance of 220.40 feet to a Mag Nail/Shiner (set);

Thence with a bearing of N. 83°-54'-17" E. for a distance of 193.12 feet to an Iron Pin (set), and passing thru an Iron Pin (set) for reference on the Westerly Right-of-Way Line of McBeth Road (C.R. 271) at a distance of 20.00 feet;

Thence with a bearing of S. 25°-20' E. along the Westerly Line of the former Indiana, Columbus, and Eastern Railroad Traction Line, for a distance of 233.43 feet to a Point, said Point being referenced by an Iron Bar (found) at S. 83°-54'-17" W. and 0.34 feet;

Thence with a bearing of S. 83°-54'-17" W. for a distance of 272.00 feet to a Mag Nail/Shiner (set), and passing thru an Iron Bar (found) at 0.34 feet, and also an Iron Bar (found) at 251.16 feet, said Mag Nail/Shiner (set) being the original PLACE OF BEGINNING.

Containing in all 1.177 Acres of land, of which, 0.101 Acre being previously dedicated for highway purposes. The above described Parcel of land is also subject to all other legal easements, reservations, or restrictions, if any, upon said premises. Previous Deed References: DEED VOLUME OR 462, PAGE 980, Auglaize County Recorder's Office. Bearings were based upon previous surveys of record and on file with the Auglaize County Engineer's Tax Map Office.

PREPARED BY:

Ted K. Schnell
Professional Engineer
Professional Surveyor

0-613