

SURVEY FOR DON MACK

8.000 Acres being a part of the Northeast and Northwest Quarters of  
Section 33, Logan Township, Town-4-South, Range-5-East,  
County of Auglaize, State of Ohio

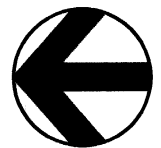

CONANT  
ROAD

Northeast Corner,  
Northeast Quarter,  
Section 33,  
Logan Twp.

ACREAGE DIVISION

1.064 Acres in the Northeast Quarter  
6.936 Acres in the Northwest Quarter

Volume: 166  
Page: 29

LOCATION PLAN

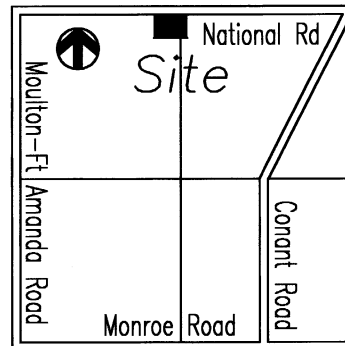

Section 33, Logan Twp.  
Auglaize County, Ohio

PLACE  
OF  
BEGINNING

S. 00°-36'-19" W.

670.17'

West line of the Northeast Quarter of Section 33, Logan Township

8.000 Acres  
(0.30 Acre R/W)

LEGEND

- Iron Pin (set)
- Monument Box
- △ Mag Nail/Shiner (set)

SCALE

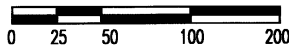

NOTES

The Basis of Bearings used for this Survey was determined  
from the Auglaize County Engineer's Global Positioning Survey

This Survey Plat and Description is Recorded in Survey Book  
0, Page 685, Auglaize County Engineer's Tax  
Map Office.

670.17'

N. 00°-36'-19" E.

Volume: 166  
Page: 29

ATTEST

Ted K. Schnell  
Professional Engineer  
Professional Surveyor

Northwest Corner,  
Northwest Quarter,  
Section 33,  
Logan Twp.

MOULTON -

F.T. AMANDA RD

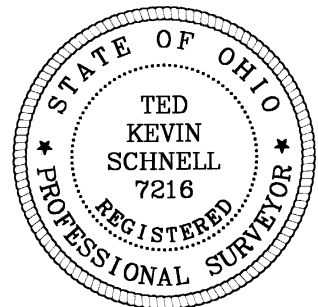
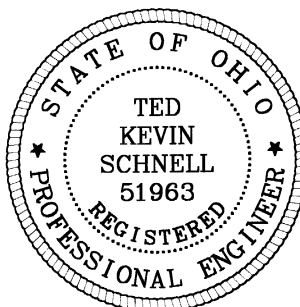

H & S Civil Engineers and Land Surveyors

913 Fieldstone Court Wapakoneta, Ohio 45895

DON MACK

client

33

section

LOGAN

township

AUGLAIZE

county

OHIO

state

11/14/04

date



0-685

# H & S Civil Engineers and Land Surveyors

913 Fieldstone Court  
Wapakoneta, Ohio 45895  
Phone (419) 738-4758  
Fax (419) 739-7631  
e-mail: hscivil@bright.net

Ted K. Schnell P.E., P.S.  
Gregory B. Huber P.E.

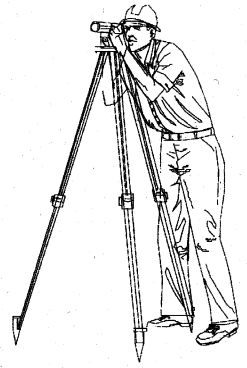

11/14/04

## SURVEYOR'S DESCRIPTION FOR 8.000 ACRE PARCEL SPLIT

The following described tract of land is situated in the Northeast Quarter and in the Northwest Quarter of Section 33, Logan Township, Town-4-South, Range-5-East, Auglaize County, Ohio, and is more particularly described as follows:

Commencing for reference at a Monument Box located at the Northeast Corner of the Northeast Quarter of said Section 33, Logan Township;

Thence with a bearing of N. 88°-59'-41" W. along the North Line of the Northeast Quarter of said Section 33, Logan Township, and the centerline of National Road, (County Road #210), for a distance of 2,587.79 feet to a Mag Nail/Shiner (set) and the PLACE OF BEGINNING;

Thence with a bearing of S. 00°-36'-19" W. for a distance of 670.17 feet to an Iron Pin (set), and passing thru an Iron Pin (set) for reference at 30.00 feet;

Thence with a bearing of N. 88°-59'-41" W. for a distance of 520.00 feet to an Iron Pin (set), and passing thru a point on the East Line of the Northeast Quarter of said Section 33, Logan Township, at a distance of approximately 72.08 feet

Thence with a bearing of N. 00°-36'-19" E. for a distance of 670.17 feet to a Mag Nail/Shiner (set), and passing thru an Iron Pin (set) for reference at 640.17 feet;

Thence with a bearing of S. 88°-59'-41" E. along the North Line of the Northwest Quarter of said Section 33, Logan Township, and the centerline of National Road, (County Road #210), for a distance of 453.61 feet to a Monument Box located at the Northwest Corner of the Northeast Quarter of said Section 33, Logan Township;

Thence continuing with a bearing of S. 88°-59'-41" E. along the North Line of the Northeast Quarter of said Section 33, Logan Township, and the centerline of National Road, (County Road #210), for a distance of 66.39 feet to a Mag Nail/Shiner (set) and the original PLACE OF BEGINNING.

Containing in all 8.000 Acres of land, of which, 1.064 Acres being situated in the Northeast Quarter of said Section 33, and 6.936 Acres being situated in the Northwest Quarter of said Section 33, Logan Township. Also, approximately 0.30 Acre has been previously dedicated for highway purposes. The above described tract of land is also subject to all other legal easements, reservations, or restrictions, if any, upon said premises. Basis of Bearings used were from the Auglaize County Engineer's Global Positioning Survey. Previous Deed References: DEED VOLUME 166, PAGE 29, Auglaize County Recorder's Office.

PREPARED BY:

A handwritten signature in black ink, appearing to read "Ted K. Schnell", written over a horizontal line.

Ted K. Schnell  
Professional Engineer  
Professional Surveyor

0-686