

NW Corner,
SE 1/4, NW 1/4,
Section 15

NE Corner,
SE 1/4, NW 1/4,
Section 15

Easterly Road

S01°05'41"W
1325.58'

5.5'

Ronald Rohrbach Survey

A subdivision of the southeast quarter
of the northwest quarter of Section 15,
Town-5-South, Range-4-East,
Noble Township, Auglaize County,
as evidenced by OR Volume 355, Page 256.

TRACT THREE
25.466 ACRES
(0.323 acres right-of-way)

(N)S88°52'56"E(W)
635.98'
TRACT TWO
3.650 ACRES
(0.143 acres right-of-way)

TRACT ONE
11.350 ACRES
(0.331 acres right-of-way)

ST. MARYS - RIVER ROAD (50' RW)

SW Corner,
SE 1/4, NW 1/4,
Section 15

ARNOLD ROAD

GRAPHIC SCALE

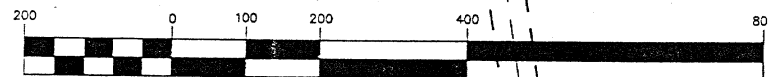

(IN FEET)
1 inch = 200 ft.

Basis of bearings per Auglaize County GPS depicting
the west line of the northwest quarter of Section 15
as N 01° 11' 41" E.

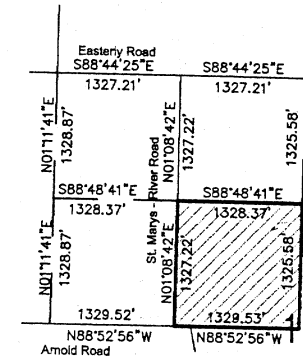
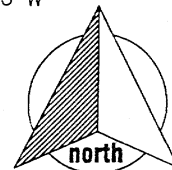

VICINITY MAP
NW 1/4 SECTION 15

LEGEND

- ☐ Monument Box (found) at the north quarter corner, Section 15
- 4" Diameter Steel Post (found)
- 5/8" re-rod w/cap (found) {Geeslin}
- ☆ Cotton Gin Spindle (set)
- ⊙ 5/8" Re-Rod w/cap (set)
*see "Schwartz Survey" by Gordon
Geeslin, PS 5372 (NOB-15-3)

I hereby certify that this plat is an accurate
representation of a field survey performed
under my direct supervision.

JAMES M. KENT, PS 6792

kent surveying, inc.

acad ~ rohbach
drawing #4680
December 19, 2005
corrected December 22, 2005



7240

Rohrbach Survey
Tract One

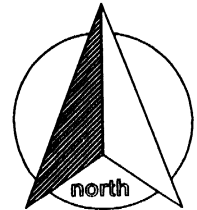

SURVEYOR'S DESCRIPTION

scale:

Being a part of the southeast quarter of the northwest quarter of Section 15, Town-5-South, Range-4-East, Noble Township, Auglaize County, Ohio as evidenced by Official Record Volume 355, Page 256 and more particularly described as follows;

Commencing for reference at a monument box (found) at the northeast corner of the northwest quarter of Section 15, and the centerline of Easterly Road; thence, S 01 degree 05' 41" W along the east line of the northwest quarter of Section 15, for a distance of 2279.24 feet to a 5/8" re-rod w/cap (set), said re-rod being the **POINT OF BEGINNING** for the tract herein described;

thence continuing along the aforesaid east line S 01 degree 05' 41" W for a distance of 371.92 feet to a 5/8" re-rod w/cap (found) at the southeast corner of the northwest quarter of Section 15;

thence, N 88 degrees 52' 56" W along the south line of the southeast quarter of the northwest quarter of Section 15 (passing through a 5/8" re-rod w/cap set on the easterly right-of-way line of St. Marys-River Road at distance of 1098.04 feet) for a total distance of 1329.53 feet to a cotton gin spindle (set) at the southwest corner of the southeast quarter of the northwest quarter of Section 15, and the centerline intersection of Arnold Road and St. Marys-River Road;

thence, N 01 degree 08' 42" E along the west line of the southeast quarter of the northwest quarter of Section 15, and the legal centerline of St. Marys-River Road for a distance of 371.92 feet to a cotton gin spindle (set);

thence, S 88 degrees 52' 56" E (passing through a 5/8" re-rod w/cap set on the east right-of-way line of St. Marys-River Road at a distance of 25.00 feet) for a total distance of 1329.20 feet to the **POINT OF BEGINNING**, containing therein 11.350 acres, of which 0.331 acres is road right-of-way. Subject to all easements and right-of-way of record at the time of the recording of this instrument.

Prepared by James M. Kent, PS 6792 with reference hereby made to a plat of survey; Kent Surveying, Inc., drawing #4680 dated December 19, 2005. Basis of bearings is per Auglaize County GPS depicting the west line of the northwest quarter of Section 15 as N 01 degree 11' 41" E.

Corrected 12/22/05

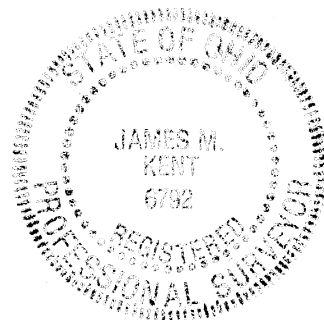

James M. Kent, PS 6792



CLIENT RON ROHRBACH DATE 12-22-05
COUNTY AUGLAIZE TOWNSHIP NOBLE
SECTION 15 T-5-S; R-4-E DRAWN BY JMK
SHEET 1 OF 3 DWG. #

kent surveying, inc.
P.O. Box 96 - 1750 Bellefontaine Street
Wapakoneta, OH 45895
419-738-5677 fax 419-738-7894

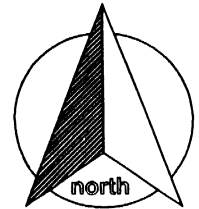
Rohrbach Survey
Tract Two



SURVEYOR'S DESCRIPTION

scale:

Being a part of the southeast quarter of the northwest quarter of Section 15, Town-5-South, Range-4-East, Noble Township, Auglaize County, Ohio as evidenced by Official Record Volume 355, Page 256 and more particularly described as follows;

Commencing for reference at a cotton gin spindle (set) at the southwest corner of the southeast quarter of the northwest quarter of Section 15 and the centerline intersection of Arnold Road and St. Marys-River Road; thence, N 01 degree 08' 42" E along the west line of the southeast quarter of the northwest quarter of Section 15 and the legal centerline of St. Marys-River Road, for a distance of 371.92 feet to a cotton gin spindle (set), said spindle being the **POINT OF BEGINNING** for the tract herein described;

thence, continuing along the aforesaid west line and legal centerline, N 01 degree 08' 42" E for a distance of 250.00 feet to a cotton gin spindle (set);

thence, S 89 degrees 52' 56" E (passing through a 5/8" re-rod w/cap set on the east right-of-way line of St. Marys-River Road at a distance of 25.00 feet) for a total distance of 635.98 feet to a 5/8" re-rod w/cap (set);

thence, S 01 degree 08' 42" W for a distance of 250.00 feet to a 5/8" re-rod w/cap (set);

thence, N 88 degrees 52' 56" W (passing through a 5/8" re-rod w/cap set on the east right-of-way line of St. Marys-River Road at a distance of 610.98 feet) for a total distance of 635.98 feet to the **POINT OF BEGINNING**, containing therein 3.650 acres, of which 0.143 acres is road right-of-way.

Subject to all easements and right-of-way of record at the time of the recording of this instrument.

Prepared by James M. Kent, PS 6792 with reference hereby made to a plat of survey; Kent Surveying, Inc., drawing #4680 dated December 19, 2005. Basis of bearings is per Auglaize County GPS depicting the west line of the northwest quarter of Section 15 as N 01 degree 11' 41" E.

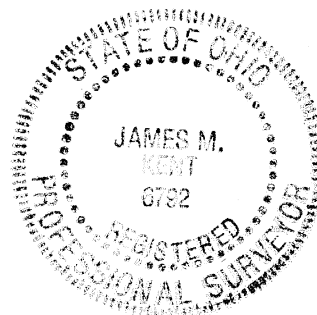
James M. Kent, PS 6792

CLIENT RON ROHRBACH DATE 12-19-05
COUNTY AUGLAIZE TOWNSHIP NOBLE
SECTION 15 T- 5-S; R- 4-E DRAWN BY JMK
SHEET 2 OF 3 DWG. # 4680

kent surveying, inc.
P.O. Box 96 - 1750 Bellefontaine Street
Wapakoneta, OH 45895
419-738-5677 fax 419-738-7894

P-292

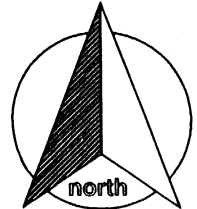

SURVEYOR'S DESCRIPTION

scale:

Being a part of the southeast quarter of the northwest quarter of Section 15, Town-5-South, Range-4-East, Noble Township, Auglaize County, Ohio as evidenced by Official Record Volume 355, Page 256 and more particularly described as follows;

Commencing for reference at a monument box (found) at the northeast corner of the northwest quarter of Section 15, and the centerline of Easterly Road; thence, S 01 degree 05' 41" W along the east line of the northwest quarter of Section 15, for a distance of 1325.58 feet to a 5/8" re-rod w/cap (set), said re-rod being the **POINT OF BEGINNING** for the tract herein described;

thence continuing along the aforesaid east line S 01 degree 05' 41" W for a distance of 953.66 feet to a 5/8" re-rod w/cap (set);

thence, N 88 degrees 52' 56" W for a distance of 693.22 feet to a 5/8" re-rod w/cap (set);

thence, N 01 degree 08' 42" E for a distance of 250.00 feet to a 5/8" re-rod w/cap (set);

thence, N 88 degrees 52' 56" W (passing through a 5/8" re-rod w/cap set on the east right-of-way line of St. Marys-River Road at a distance of 610.98 feet) for a total distance of 635.98 feet to a cotton gin spindle (set) on the west line of the southeast quarter of the northwest quarter of Section 15 and the legal centerline of St. Marys River Road;

thence, N 01 degree 08' 42" E along the aforesaid west line and legal centerline for a distance of 705.30 feet to a cotton gin spindle (set) at the northwest corner of the southeast quarter of the northwest quarter of Section 15;

thence, S 88 degrees 48' 41" E (passing through a 5/8" re-rod w/cap set on the east right-of-way line of St. Marys-River Road at a distance of 25.00 feet) for a total distance of 1328.37 feet to the **POINT OF BEGINNING**, containing therein 25.466 acres, of which 0.323 acres is road right-of-way.

Subject to all easements and right-of-way of record at the time of the recording of this instrument.

Prepared by James M. Kent, PS 6792 with reference hereby made to a plat of survey; Kent Surveying, Inc., drawing #4680 dated December 19, 2005. Basis of bearings is per Auglaize County GPS depicting the west line of the northwest quarter of Section 15 as N 01 degree 11' 41" E.

James M. Kent, PS 6792

CLIENT RON ROHRBACH DATE 12-19-05
COUNTY AUGLAIZE TOWNSHIP NOBLE
SECTION 15 T-5-S; R-4-E DRAWN BY JMK
SHEET 3 OF 3 DWG. # 4680

 **kent surveying, inc.**
P.O. Box 96 - 1750 Bellefontaine Street
Wapakoneta, OH 45895
419-738-5677 fax 419-738-7894