

Kuck Survey

Reference OR 42, Page 230
Part of the Northeast Quarter
of Section 25
Town 6 South
Range 5 East
Washington Township
Auglaize County, Ohio

LEGEND

"A" = Iron Bar Set
"B" = PK Spike Set
"C" = RR Spike Found
"D" = PK Nail Found
"E" = Monument Box
"F" = Iron Bar Found

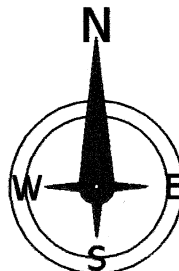
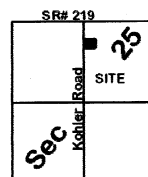

BAR SCALE
0 50 100 150
Scale: 1" = 100'

Prepared by

Thomas W. Steinke
Registered Surveyor # 6177
16454 CR# 25~A
Anna, Ohio 45302

Phone: 937~693~6538
E-Mail: tssurvey@earthlink.net

NOTE: References shown or noted hereon are current at the time of the survey. This survey is based upon existing records and monumentation as shown or noted or referred to hereon.

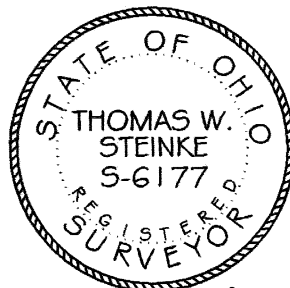

Thomas W. Steinke
Thomas W. Steinke
May 2006

Thomas W. Steinke
Professional Registered Surveyor #6177
Land Surveying

16454 County Road # 25-A Anna, Ohio 45302
Phone: (937) 693-6538 E-mail: tssurvey@earthlink.net



Date: May 27, 2006

Being 0.500 Acres located in the northeast quarter of Section 25, Town 6 South, Range 5 East, Washington Township, Auglaize County and being further described as follows:

Commencing at a PK Nail found at the northwest corner of the northeast quarter of Section 25, said point also being the centerline intersection of Kohler Road and State Route # 219;

Thence South $01^{\circ} 11' 34''$ West along the centerline of Kohler Road and quarter section line, a distance of 208.71 feet to a railroad spike found and the PLACE OF BEGINNING for the parcel herein described;

Thence South $89^{\circ} 09' 57''$ East, a distance of 208.71 feet to an iron bar found, passing through an iron bar found at 25.00 feet;

Thence South $01^{\circ} 11' 34''$ West, a distance of 104.36' feet to an iron bar set;

Thence North $89^{\circ} 09' 57''$ West, a distance of 208.71 feet to a PK Spike set in the centerline of Kohler Road and the quarter section line, passing through an iron bar set at 183.71 feet;

Thence North $01^{\circ} 11' 34''$ East along said centerline and quarter section line, a distance of 104.36' feet to the PLACE OF BEGINNING.

Containing in all 0.500 Acres of which 0.042 acre is located within the existing road right of way. Survey and description prepared by Thomas W. Steinke on this 27th day of May, 2006 and based upon existing recorded documents.
Basis of bearings, see Auglaize County State Plane Coord. System