

I hereby certify the accompanying map and survey, which it represents to be correct to best of my knowledge and belief. All rebar set and called for are topped with a plastic Peramark cap stamped:
KUCK & MORRISSEY L.S. 6470

Date: 11/27/06

Richard D. Morrissey, L.S. 6470 (Ohio)
KUCK & MORRISSEY, Inc.

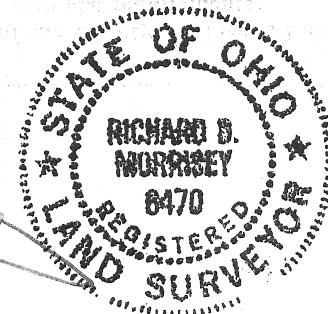

Signature by a representative of the County Health Dept. denotes compliance with Health Regulations.
 Signed: _____ Date: _____

Signature by a representative of the Auglaize County Regional Planning Commission denotes approval of this plat.
 Signed: _____ Date: _____

Signature by a representative of City with 3 mile limit jurisdiction or Twp. Trustees or Village with zoning jurisdiction denotes approval of this plat. Signed: _____ Date: _____
 for political S. D. of: _____

Signature by a representative of the County Engineer's Dept. denotes that this plat meets tax map plat requirements.
 Signed: _____ Date: _____

KUCK AND MORRISSEY, INC.
 CONSULTING ENGINEERS & SURVEYORS
 2807 CHAPEL HILL DRIVE
 LIMA, OHIO 45805 - 228-1735

Client Mr. Joe MACK
 County Auglaize Twp. Salem Sec. 20
 Drawn by J RDM Scale 1"=600' Drwg. No. _____
 Checked by rdm Date 11/27/06
 Sheet 1 of 2 (T-4-S; R-4-E)

DESCRIPTION - PARCEL No. 1

Being a parcel of land situate in the east half of the Northeast quarter of Section 20, T-4-S, R-4-E, Salem Township, Auglaize County, Ohio and more particularly described as follows:

BEGINNING at a iron pin found at the northeast corner of said Northeast quarter; thence S 00°02'16" W with the east line of said Northeast quarter (passing through a 4" square concrete post found at 20.75 feet), 1,351.78 feet to a capped 5/8 inch rebar set; thence N 89°46'30" W, 1,292.06 feet to a capped 5/8 inch rebar set; thence N 00°17'56" E (passing through a 5/8 rebar found at 1,331.78 feet (adjacent to the north side of a 7" diameter steel post)), 1,351.78 feet to a railroad spike found on the north line of said Northeast quarter; thence S 89°46'30" E with said north line (also the centerline of T.R. 230 (Valine Road)), 1,285.89 feet to the **PLACE OF BEGINNING** containing 40.000 acres more or less and subject to all highway and other legal easements of record. Surveyed by: **KUCK and MORRISEY, Inc.**, Richard D. Morrissey, L.S. No. 6470 (Ohio)

DESCRIPTION - PARCEL No. 2

Being a parcel of land situate in the east half of the Northeast quarter and the Southeast quarter of Section 20, T-4-S, R-4-E, Salem Township, Auglaize County, Ohio and more particularly described as follows:

BEGINNING at an iron pin found in a monument box at the intersection of the centerline of State Route 116 and the east line of the Southeast quarter of said Section 20; thence S 88°57'46" W with said centerline of said State Route 116, 1,235.69 feet to a PK nail and shiner set; thence N 02°12'14" W (passing through a capped 5/8 inch rebar set at 20.00 feet), 196.00 feet to a capped 5/8 inch rebar set (reference 3 1/2" steel post found S 11°10'15" E, 0.92 feet); thence S 88°57'46" W, 54.41 feet to a 5" diameter steel post found; thence N 00°17'56" E, 1,271.25 feet to a capped 5/8 inch rebar set; thence S 89°46'30" E, 1,292.06 feet to a capped 5/8 inch rebar set on the east line of said Northeast quarter of said Section 20; thence S 00°02'16" W with said east line of said Northeast quarter, 1,302.15 feet to the calculated southeast corner of said Northeast quarter as calculated during a previous survey; thence S 00°10'00" W with the east line of said Southeast quarter of said Section 20, 136.51 feet to the **PLACE OF BEGINNING** containing 42.943 acres more or less and subject to all highway and other legal easements of record.

Surveyed by: **KUCK and MORRISEY, Inc.**, Richard D. Morrissey, L.S. No. 6470 (Ohio)

I hereby certify the accompanying map and survey, which it represents to be correct to best of my knowledge and belief. All rebar set and called for are topped with a plastic Peramark cap stamped:
KUCK & MORRISEY - L.S. 6470

Date: 11/27/06

Richard D. Morrissey, L.S. 6470 (Ohio)
KUCK & MORRISEY, Inc.

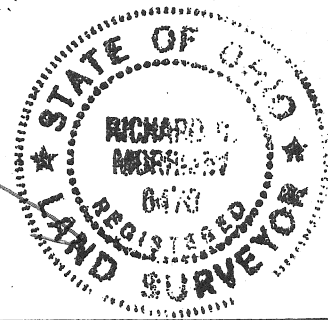

Signature by a representative of the County Health Dept. denotes compliance with Health Regulations.
Signed: _____ Date _____

Signature by a representative of the Auglaize County Regional Planning Commission denotes approval of this plat.
Signed: _____ Date _____

Signature by a representative of City with 3 mile limit jurisdiction or Twp. Trustees or Village with zoning jurisdiction denotes approval of this plat. Signed: _____ Date _____
for political S. D. of: _____

Signature by a representative of the County Engineer's Dept. denotes that this plat meets tax map plat requirements.
Signed: _____ Date _____

KUCK AND MORRISEY, INC.
CONSULTING ENGINEERS & SURVEYORS
2807 CHAPEL HILL DRIVE
LIMA, OHIO 45805 - 228-1735

Client Mr. Joe MACK
County Auglaize Twp. Salem Sec. 20
Drawn by J RDM Scale 1" = 600' Drwg. No. _____
Checked by rdm Date 11/27/06
Sheet 2 of 2 (T-4-S; R-4-E)