

WAPAK-CRIDERSVILLE ROAD

NW Corner,
SW 1/4 Sec. 21

INFIRMARY ROAD (50' R/W)

N89°28'36"W
1953.85'

S89°28'36"E
85.00'

N89°28'36"W
615.00'

15.01'
25.01'

NE Corner,
East 1/2, SW 1/4,
Section 21

Doris H. Miller
OR 544, Page 1703

Charles & Joyce Anthony
OR 112, Page 873

N01°29'03"E
300.00'

S01°29'03"W
300.00'

85.00'
N89°28'36"W

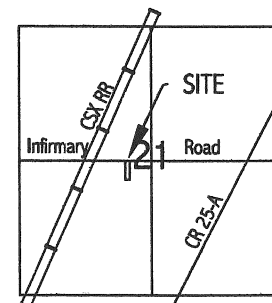

VICINITY MAP ~ SECTION 21

LEGEND

- monument box (found)
- mag-nail (set)
- 5/8" X 30" re-rod w/cap (set)

I hereby certify that this plat is
representative of a field survey
performed under my direct
supervision

JAMES M. KENT, PS 6892

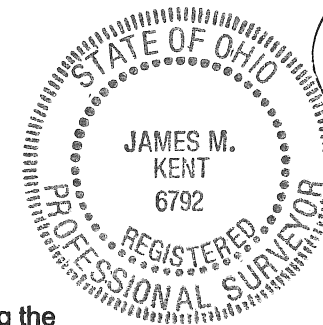

kent surveying, inc.
acad ~ van horn
drawing #4664
January 26, 2006

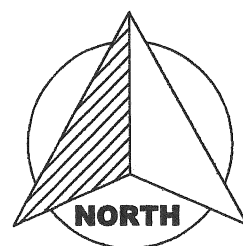

GRAPHIC SCALE

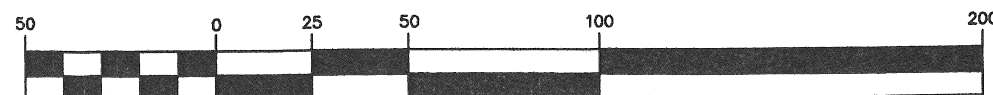

(IN FEET)
1 inch = 50 ft.

Basis of bearings is per survey performed by Richard Morrissey, PS 6570 in March of 1981 depicting the
centerline of Infirmary Road as N 89° 28'36" W. Filed in Book "G" Page 447

P-554



scale:

SURVEYOR'S DESCRIPTION

Being a part of the southwest quarter of Section 21, Town-5-South, Range-6-East, Duchouquet Township, Auglaize County, Ohio as evidenced by Official Record Volume 544, Page 1703 and more particularly described as follows:

Commencing for reference at a monument box (found) at the northeast corner of the east one-half of the southwest quarter of Section 21; thence, along the north line of said east one-half of the southwest quarter and the legal centerline of Infirmary Road, N 89° 28' 36" W for a distance of 615.00 feet to a mag-nail (set), said nail being the **POINT OF BEGINNING** for the tract herein described;

thence, S 01° 29' 03" W (passing through a 5/8" re-rod w/cap set on the south right-of-way line of Infirmary Road at a distance of 25.00 feet) for a total distance of 300.00 feet to a 5/8" re-rod w/cap (set);

thence, N 89° 28' 36" W for a distance of 85.00 feet to a 5/8" re-rod w/cap (set);

thence, N 01° 29' 03" E (passing through a 5/8" re-rod w/cap set on the south right-of-way line at a distance of 275.00 feet) for a total distance of 300.00 feet to a mag-nail (set) on the north line of the east one-half of the southwest quarter of Section 21 and the legal centerline of Infirmary Road;

thence, S 89° 28' 36" E along the aforesaid north line and legal centerline for a distance of 85.00 feet to the **POINT OF BEGINNING**, containing therein **0.585 acres**, of which 0.049 acres is road right-of-way. Subject to all easements and right-of-way of record at the time of the recording of this instrument. Prepared by James M. Kent, Professional Surveyor No. 6792 with reference herein made to a plat of survey; Kent Surveying, Inc., drawing #4664 dated January 26, 2006. Basis of bearings is per survey performed in March of 1981 by Richard Morrissey, PS 6570, depicting the centerline of Infirmary Road and the north line of the southwest quarter of Section 21 as N 89° 28' 36" W and filed in Book "G", Page 447.



James M. Kent, PS 6792

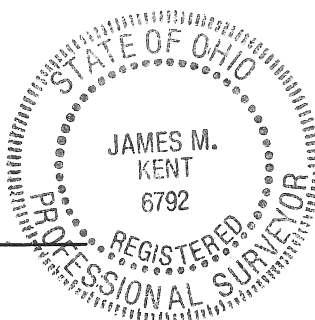

CLIENT MILLER ESTATE DATE 1-3-07
 COUNTY AUGLAIZE TOWNSHIP DUCHOUQUET
 SECTION 21 T-5-S; R-6-E DRAWN BY JMK
 SHEET 1 OF 1 DWG. # 4664

kent surveying, inc.
 P.O. Box 96 - 1750 Bellefontaine Street
 Wapakoneta, OH 45895
 419-738-5677 fax 419-738-7894