

SURVEYED BY

JAMES W. GEESLIN
P.S. No. 7764

HESSE SURVEY

PART OF THE E. 1/2 - N.W. 1/4 - SEC. 31, TOWN 4 SOUTH, RANGE 4 EAST, (SALEM TOWNSHIP), AUGLAIZE COUNTY, OHIO.

APRIL 16, 2007

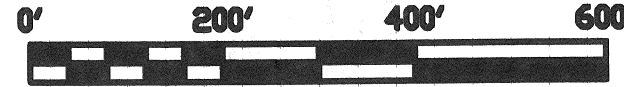

SCALE 1" = 200'

N.W. COR. -
SEC. 31

N. LINE - N.W. 1/4 - SEC. 31 &  HESSE RD. (40' R/W AS OCCUPIED)

N 90°00'00" W 3189.50' (ASSUMED BEARING)

2149.86'

1039.64'

20' R/W LINE

N.E. COR. -
N.W. 1/4 -
SEC. 31

COR. STONE IN
MON. BOX FOUND

LOCATION SKETCH

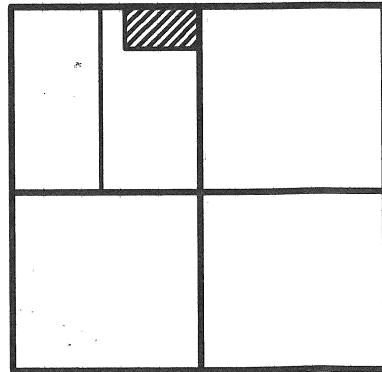

SECTION 31

11.000 TOTAL ACRES

0.477 AC. IN R/W

10.523 ACRES NET

N 90°00'00" E 1039.64'





460.90'

N 00°17'23" E 2675.00'
E. LINE - N.W. 1/4 - SEC. 31

MARK & BETH NOLAN
O.R. 122 PG. 595

CENTER -
SEC. 31

LEGEND

-  = CORNERSTONE FOUND.
-  = CONCRETE MONUMENT FOUND.
-  = BOLT SET.
-  = 5/8 INCH IRON BAR SET.

RICK & PEGGY HESSE
O.R. 531 PG. 267

PERMANENT
PARCEL No.

Part of Sec. T. R.

Grantee Acres

Grantee Acres

Deed References

APPROVALS
AGENCY

Board of Health Date

Township Zoning Officer Date

County Engineer Date

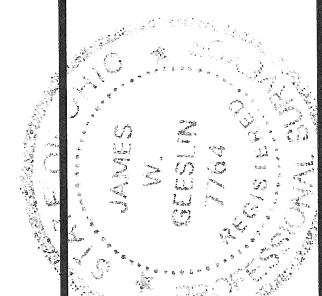

**GEESLIN
LAND SURVEYING**

107 N. CEDAR STREET
COLDWATER, OHIO 45828
PHONE: (419) 586-6155
FAX: (419) 678-9332

P-615

April 16, 2007

HESSE SURVEY DESCRIPTION (11.000 ACRE PARCEL)

Being a parcel of land situated in Salem Township, Auglaize County, Ohio, in the east half of the northwest quarter of Section 31, Township 4 South, Range 4 East. Being more particularly described as follows :

Beginning at the cornerstone at the northeast corner of the northwest quarter of said Section 31 -

Thence, West, along the north line of the northwest quarter of said Section 31 and the centerline of Hesse Road, a distance of 1039.64 feet to a Bolt set -

Thence, South 00°17'23" West, a distance of 460.90 feet to a 5/8 inch iron bar -

Thence, East, a distance of 1039.64 feet to a 5/8 inch iron bar -

Thence, North 00°17'23" East, along the east line of the northwest quarter of said Section 31, a distance of 460.90 feet to the place of beginning.

Containing 11.000 acres of land more or less.

Subject to all easements and right-of-way of record.

Reference is made to a survey of this area by James W. Geeslin, Professional Surveyor 7764, dated April 16, 2007. On file in the County Engineer's Office.

Surveyed by

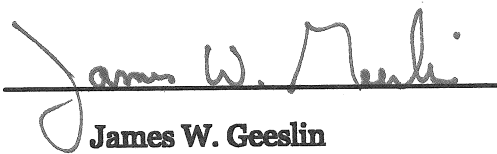
James W. Geeslin
P.S. 7764

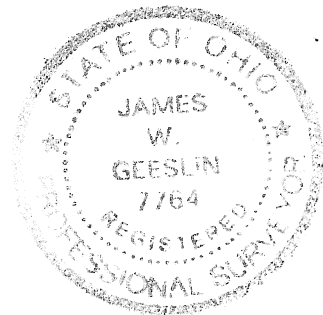

**GEESLIN
LAND SURVEYING**

107 N. CEDAR STREET
COLDWATER , OHIO 45828
PHONE: (419) 586-6155
FAX: (419) 678-9332

PERMANENT
PARCEL No. _____

Part of _____ Sec. _____ T. _____ R. _____ Township

Grantor: _____ Area Retained: _____ Acres

Grantee: _____ Area Retained: _____ Acres

Deed References: _____

APPROVALS:
AGENCY: _____

Board of Health Date

Township Zoning Officer Date

County Engineer Date

P-616