

Mike Kuck Boundary Survey

Part of the southeast quarter of Section 29,
Town-6-South, Range-5-East, Washington Township,
Auglaize County, Ohio as evidenced by
OR Volume 65, Page 232

Jerry & Lucille Merges
OR Volume 550, Page 1479

Tract One
7.284 acres
(0.318 acres right-of-way)

Phyllis J. Kuck
OR Volume 360, Page 534

Tract Two
13.951 acres
(0.819 acres right-of-way)

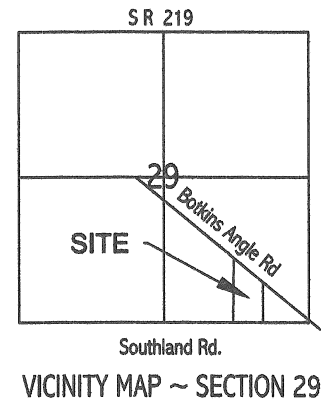

LEGEND

- monument box (found)
- 5/8" re-rod (found)
- 5/8" re-rod w/cap (set)
- mag nail (set)

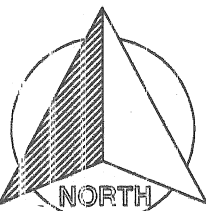

GRAPHIC SCALE

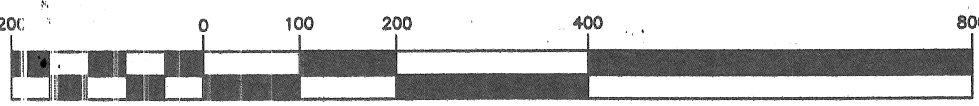

(IN FEET)
1 inch = 200 ft.

Basis of bearings is per Auglaize County GPS depicting the
south line of the southeast quarter of Section 29 as S 89° 33' 15" E.

SOUTHLAND ROAD (40' RW)

I hereby certify that this plat is representative of a field survey,
performed under my direct supervision.

James M. Kent

James M. Kent, Professional Surveyor No. 6792

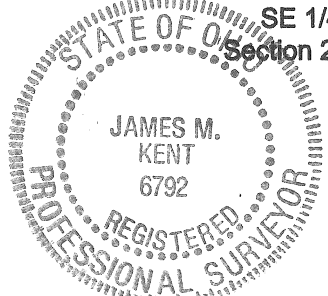

kent surveying, inc.
AutoCAD ~ Kuck, Mike
drawing #4900
June 29, 2007

P-651

Michael Kuck Survey
Tract One

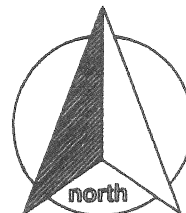

scale:

SURVEYOR'S DESCRIPTION

Being a part of the southeast quarter of Section 29, Town-6-South, Range-5-East, Washington Township, Auglaize County, Ohio as evidenced by Official Record Volume 65, Page 232 and more particularly described as follows:

Commencing for reference at a monument box (found) at the southwest corner of the southeast quarter of Section 29 and the centerline of Southland Road; thence, S 89° 33' 15" E along the south line of the southeast quarter of Section 29 and the centerline of Southland Road for a distance of 1029.99 feet to a mag nail (set), said nail being the **POINT OF BEGINNING** for the tract herein described;

thence, N 01° 19' 01" E (passing through a 5/8" re-rod w/cap set on the north right-of-way line of Southland Road at a distance of 20.00 feet and a 5/8" re-rod found on the south right-of-way line of Botkins Angle Road at a distance of 1391.13 feet) for a total distance of 1429.33 feet to a mag nail (set) on the centerline of Botkins Angle Road;

thence, S 50° 26' 43" E along the centerline of Botkins Angle Road for a distance of 302.88 feet to a mag nail (set);

thence, S 01° 19' 01" W (passing through a 5/8" re-rod w/cap set on the south right-of-way line of Botkins Angle Road at a distance of 38.20 feet and a 5/8" re-rod w/cap set on the north right-of-way line of Southland Road at a distance of 1218.25 feet) for a total distance of 1238.25 feet to a mag nail (set) on the south line of the southeast quarter of Section 29 and the centerline of Southland Road;

thence, N 89° 33' 15" W along the aforesaid south line of the southeast quarter and the aforesaid centerline for a distance of 237.92 feet to the **POINT OF BEGINNING**, containing therein **7.284 acres**, of which 0.318 acres is road right-of-way. Subject to all easements and right-of-ways of record at the time of the recording of this instrument. Prepared by James M. Kent, PS 6792 with reference herein made to a plat of survey; Kent Surveying, Inc. drawing #4900 dated 6/29/07. Basis of bearings is per Auglaize County GPS depicting the south line of the southeast quarter of Section 29 as N 89° 33' 15" W.

corrected July 2nd & 3rd 2007

James M. Kent, PS 6792

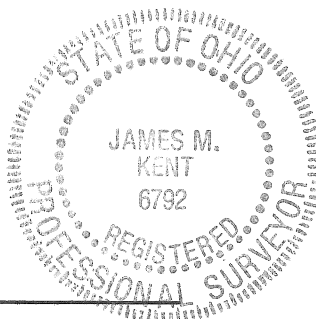

CLIENT MIKE KUCK DATE 7.3.07
COUNTY AUGLAIZE TOWNSHIP WASHINGTON
SECTION 29 T-6-S; R-5-E DRAWN BY JMK
SHEET 1 OF 2 DWG. # 4900

 **kent surveying, inc.**
P.O. Box 96 - 1750 Bellefontaine Street
Wapakoneta, OH 45895
419-738-5677 fax 419-738-7894

P-65C

Michael Kuck Survey
Tract Two



scale:

SURVEYOR'S DESCRIPTION

Being a part of the southeast quarter of Section 29, Town-6-South, Range-5-East, Washington Township, Auglaize County, Ohio as evidenced by Official Record Volume 65, Page 232 and more particularly described as follows:

Commencing for reference at a monument box (found) at the southwest corner of the southeast quarter of Section 29 and the centerline of Southland Road; thence, S 89° 33' 15" E along the south line of the southeast quarter of Section 29 and the centerline of Southland Road for a distance of 1267.91 feet to a mag nail (set), said nail being the **POINT OF BEGINNING** for the tract herein described;

thence, N 01° 19' 01" E (passing through a 5/8" re-rod w/cap set on the north right-of-way line of Southland Road at a distance of 20.00 feet and a 5/8" re-rod w/cap set on the south right-of-way line of Botkins Angle Road at a distance of 1200.05 feet) for a total distance of 1238.25 feet to a mag nail (set) on the centerline of Botkins Angle Road;

thence, S 50° 26' 43" E along the centerline of Botkins Angle Road for a distance of 780.72 feet to a 5/8" re-rod (found) at the northwest corner of the Union Station Subdivision;

thence, S 01° 26' 20" W, along the west line of the aforesaid subdivision (passing through a 5/8" re-rod w/cap set on the south right-of-way line of Botkins Angle Road at a distance of 38.13 feet and a 5/8" re-rod w/cap set on the north right-of-way line of Southland Road at a distance of 725.75 feet) for a total distance of 745.75 feet to a mag nail (set) on the south line of the southeast quarter of Section 29 and the centerline of Southland Road;

thence, N 89° 33' 15" W along the aforesaid south line of the southeast quarter and the aforesaid centerline for a distance of 611.70 feet to the **POINT OF BEGINNING**, containing therein **13.951 acres**, of which 0.819 acres is road right-of-way. Subject to all easements and right-of-ways of record at the time of the recording of this instrument. Prepared by James M. Kent, PS 6792 with reference herein made to a plat of survey; Kent Surveying, Inc. drawing #4900 dated 6/29/07. Basis of bearings is per Auglaize County GPS depicting the south line of the southeast quarter of Section 29 as N 89° 33' 15" W.

corrected July 2, 2007

James M. Kent, PS 6792

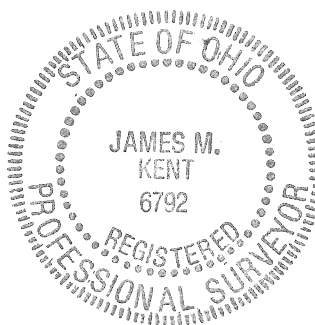

CLIENT MIKE KUCK DATE 7-2-07
COUNTY AUGLAIZE TOWNSHIP WASHINGTON
SECTION 29 T-6-S; R-5-E DRAWN BY JMK
SHEET 2 OF 2 DWG. # 4900

 **kent surveying, inc.**
P.O. Box 96 - 1750 Bellefontaine Street
Wapakoneta, OH 45895
419-738-5677 fax 419-738-7894

P-653