

# Mike Kuck Boundary Survey No. 2

Part of the southeast quarter of Section 29,  
Town-6-South, Range-5-East, Washington Township,  
Auglaize County, Ohio as evidenced by  
OR Volume 65, Page 232

Jerry & Lucille Merges  
OR Volume 550, Page 1479

**Tract One**  
**7.284 acres**  
(0.318 acres right-of-way)

**Tract Two 'A'**  
**8.943 acres**  
(0.313 acres right-of-way)

**Tract Two 'B'**  
**2.504 acres**  
(0.225 acres right-of-way)

**Tract Two 'C'**  
**2.504 acres**  
(0.118 acres right-of-way)

Phyllis J. Kuck  
OR Volume 360, Page 534

SW Corner,  
SE 1/4,  
Section 29

Gary & Pamela Grew  
Volume 240, Page 488

Douglas & Sherri Cain  
OR Volume 309, Page 40

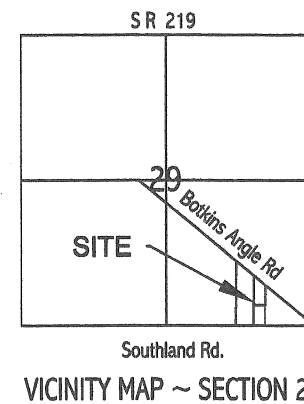

## LEGEND

- monument box (found)
- 5/8" re-rod (found)
- 5/8" re-rod w/cap (set)
- ⦿ mag nail (set)

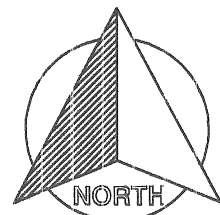

## GRAPHIC SCALE

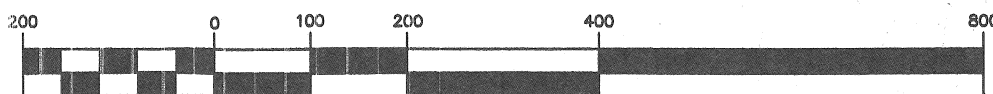

( IN FEET )  
1 inch = 200 ft.

Basis of bearings is per Auglaize County GPS depicting the  
south line of the southeast quarter of Section 29 as S 89° 33' 15" E.

## SOUTHLAND ROAD (40' R/W)

I hereby certify that this plat is representative of a field survey,  
performed under my direct supervision.

*James M. Kent*  
James M. Kent, Professional Surveyor No. 6792

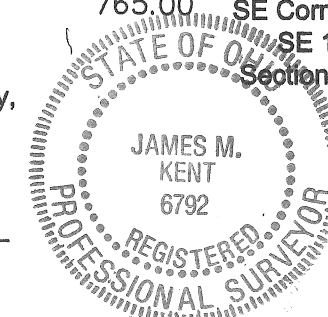

**kent surveying, inc.**  
AutoCAD ~ Kuck, Mike  
drawing #4900-2  
July 25, 2007

P-667

Michael Kuck Survey  
Tract Two "A"

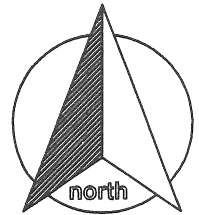

scale:

### SURVEYOR'S DESCRIPTION

Being a part of the southeast quarter of Section 29, Town-6-South, Range-5-East, Washington, Township, Auglaize County, Ohio as evidenced by Official Record Volume 65, Page 232 and more particularly described as follows:

Commencing for reference at a monument box (found) at the southeast corner of the southeast quarter of Section 29 and the centerline of Southland Road; thence, N 89° 33' 15" W along the south line of the southeast quarter of Section 29 and the centerline of Southland Road for a distance of 1022.04 feet to a mag nail (set), said mag nail being the **POINT OF BEGINNING** for the tract herein described;

thence, continuing along the aforesaid south line of the southeast quarter and the centerline of Southland Road N 89° 33' 15" W for a distance of 354.66 feet to a mag nail (set);

thence, N 01° 19' 01" E (passing through a 5/8" re-rod w/cap set on the north right-of-way line of Southland Road and a 5/8" re-rod w/cap set on the south right-of-way line of Botkins-Angle Road at a distance of 20.00 feet and 1200.05 feet respectively) for a total distance of 1238.25 feet to a mag-nail (set);

thence, S 50° 26' 43" E along the centerline of Botkins-Angle Road for a distance of 454.07 feet to a mag nail (set);

thence, S 01° 26' 20" W (passing through a 5/8" re-rod w/cap set on the south right-of-way line of Botkins-Angle Road and a 5/8" re-rod w/cap set on the north right-of-way line of Southland Road at a distance of 38.20 feet and 931.83 feet respectively) for a total distance of 951.83 feet to the **POINT OF BEGINNING**, containing therein **8.943 acres**, of which 0.313 acres is road right-of-way. Subject to all easements and right-of-ways of record at the time of the recording of this instrument. Prepared by James M. Kent, PS 6792 with reference herein made to a plat of survey; Kent Surveying, Inc. drawing #4900-2 dated 7/25/07. Basis of bearings is per Auglaize County GPS depicting the south line of the southeast quarter of Section 29 as N 89° 33' 15" W.

**Corrected 7/27/07**

  
James M. Kent, PS 6792



CLIENT KUCK DATE 7/25/07  
COUNTY \_\_\_\_\_ TOWNSHIP \_\_\_\_\_  
SECTION \_\_\_\_\_ T-\_\_\_\_-S; R-\_\_\_\_-E DRAWN BY \_\_\_\_\_  
SHEET \_\_\_\_\_ OF \_\_\_\_\_ DWG. # \_\_\_\_\_

 **kent surveying, inc.**  
P.O. Box 96 - 1750 Bellefontaine Street  
Wapakoneta, OH 45895  
419-738-5677 fax 419-738-7894

P-668

Michael Kuck Survey  
Tract Two "B"

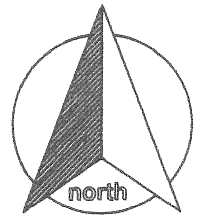

scale:

### SURVEYOR'S DESCRIPTION

Being a part of the southeast quarter of Section 29, Town-6-South, Range-5-East, Washington Township, Auglaize County, Ohio as evidenced by Official Record Volume 65, Page 232 and more particularly described as follows:

Commencing for reference at a monument box (found) at the southwest corner of the southeast quarter of Section 29 and the centerline of Southland Road; thence, S 89° 33' 15" E along the south line of the southeast quarter of Section 29 and the centerline of Southland Road for a distance of 1622.57 feet to a mag nail (set); thence, N 01° 26' 20" E for a distance of 424.39 feet to a 5/8" re-rod w/cap (set), said re-rod being the **POINT OF BEGINNING** for the tract herein described;

thence, continuing N 01° 26' 20" E (passing through a 5/8" re-rod w/cap set on the south right-of-way line of Botkins Angle Road at a distance of 489.31 feet) for a total distance of 527.44 feet to a mag-nail (set) on the centerline of Botkins Angle Road;

thence, S 50° 26' 43" E along the centerline of Botkins Angle Road for a distance of 326.65 feet to a 5/8" re-rod (found);

thence, S 01° 26' 20" W (passing through a 5/8" re-rod w/cap set on the south right-of-way line of Botkins Angle Road at a distance of 38.13 feet) for a total distance of 321.25 feet to a 5/8" re-rod w/cap (set);

thence, N 89° 33' 15" W for a distance of 257.04 feet to the **POINT OF BEGINNING**, containing therein **2.504 acres**, of which 0.225 acres is road right-of-way. Subject to all easements and right-of-ways of record at the time of the recording of this instrument. Prepared by James M. Kent, PS 6792 with reference herein made to a plat of survey; Kent Surveying, Inc. drawing #4900-2 dated 7/25/07. Basis of bearings is per Auglaize County GPS depicting the south line of the southeast quarter of Section 29 as N 89° 33' 15" W.

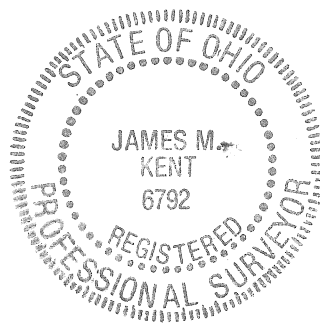

  
James M. Kent, PS 6792

CLIENT MIKE KUCK DATE 7-25-07  
COUNTY AUGLAIZE TOWNSHIP WASHINGTON  
SECTION 29 T-6-S; R-5-E DRAWN BY JMK  
SHEET 1 OF 1 DWG. # 4900-2

 **kent surveying, inc.**  
P.O. Box 96 - 1750 Bellefontaine Street  
Wapakoneta, OH 45895  
419-738-5677 fax 419-738-7894

Michael Kuck Survey  
Tract Two "C"

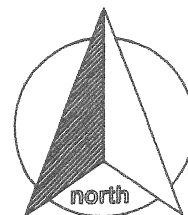

scale:

### SURVEYOR'S DESCRIPTION

Being a part of the southeast quarter of Section 29, Town-6-South, Range-5-East, Washington Township, Auglaize County, Ohio as evidenced by Official Record Volume 65, Page 232 and more particularly described as follows:

Commencing for reference at a monument box (found) at the southeast corner of the southeast quarter of Section 29 and the centerline of Southland Road; thence, N 89° 33' 15" W along the south line of the southeast quarter of Section 29 and the centerline of Southland Road for a distance of 765.00 feet to a mag nail (set), said mag nail being the **POINT OF BEGINNING** for the tract herein described;

thence, continuing along the aforesaid south line of the southeast quarter and the centerline of Southland Road N 89° 33' 15" W for a distance of 257.04 feet to a mag nail (set);

thence, N 01° 26' 20" E (passing through a 5/8" re-rod w/cap set on the north right-of-way line of Southland Road at a distance of 20.00 feet) for a total distance of 424.39 feet to a 5/8" re-rod w/cap (set);

thence, S 89° 33' 15" E for a distance of 257.04 feet to a 5/8" re-rod w/cap (set);

thence, S 01° 26' 20" W (passing through a 5/8" re-rod w/cap set on the north right-of-way line of Southland Road at a distance of 404.39 feet) for a total distance of 424.39 feet to the **POINT OF BEGINNING**, containing therein **2.504 acres**, of which 0.118 acres is road right-of-way. Subject to all easements and right-of-ways of record at the time of the recording of this instrument. Prepared by James M. Kent, PS 6792 with reference herein made to a plat of survey; Kent Surveying, Inc. drawing #4900-2 dated 7/25/07. Basis of bearings is per Auglaize County GPS depicting the south line of the southeast quarter of Section 29 as N 89° 33' 15" W.

  
James M. Kent, PS 6792

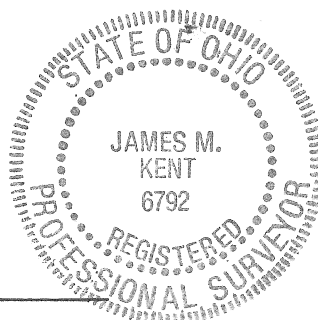

CLIENT MIKE KUCK DATE 7-25-07  
COUNTY AUGLAIZE TOWNSHIP WASHINGTON  
SECTION 29 T-6-S; R-5-E DRAWN BY JMK  
SHEET 3 OF 3 DWG. # 4900-2

**kent surveying, inc.**  
P.O. Box 96 - 1750 Bellefontaine Street  
Wapakoneta, OH 45895  
419-738-5677 fax 419-738-7894

7-669A