

LEGEND
 • A ~ PK nail set
 • B ~ Capped 5/8" rebar set

Scale:
 1" = 300'

DESCRIPTION

Being a parcel of land situate in the west half of the east half of the Southeast quarter of Section 20, T-4-S, R-5-E, Logan Township, Auglaize County, Ohio and more particularly described as follows:

Commencing at a monument box found at the southeast corner of said Southeast quarter of said Section 20; thence N 88°54'53" W with the south line of said Southeast quarter (also the centerline of Burnfield Road), 662.87 feet to a P.K. nail and shinner set at the southeast corner of the west half of the east half of said Southeast quarter and the **PLACE OF BEGINNING** thence continuing N 88°54'53" W with said south line and centerline, 662.87 feet to a P.K. nail and shinner set at the southwest corner of the east half of said Southeast quarter; thence N 00°53'12" E with the west line of said east half, 2,353.09 feet to a P.K. nail and shinner set on the centerline of Kossuth-Amanda Road; thence N 66°35'06" E with said centerline, 386.87 feet to a P.K. nail and shinner set; thence S 01°08'29" W (passing through a capped 5/8 inch rebar set at 32.84 feet), 334.20 feet to a capped 5/8 inch rebar set; thence S 89°08'18" E, 310.72 feet to a capped 5/8 inch rebar set on the east line of said west half of said east half of said Southeast quarter; thence S 00°51'32" W with said east line (passing through a capped 5/8 inch rebar set at 2,160.54 feet), 2,180.54 feet to the **PLACE OF BEGINNING** containing 35.192 acres more or less and subject to all highway and other legal easements of record.

I hereby certify the accompanying map and survey which it represents to be correct to the best of my knowledge and belief. All rebar set and called for are topped with a plastic Peramark cap stamped:
 KUCK & MORRISEY L.S. 6470

Date: 5/20/98
 Richard D. Morrissey, L.S. 6470
 KUCK and MORRISEY, Inc.

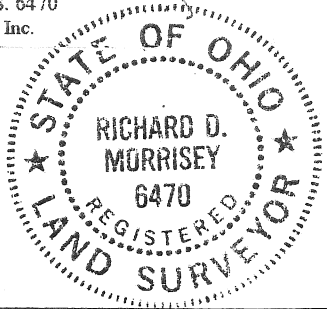

Signature by a representative of the County Health Dept. denotes compliance with Health Regulations.
 Signed: _____ Date: _____

Signature by a representative of the Auglaize County Regional Planning Commission denotes approval of this plat.
 Signed: _____ Date: _____

Signature by a representative of City with 3 mile limit jurisdiction or Twp. Trustees or Village with zoning jurisdiction denotes approval of this plat. Signed: _____ Date: _____
 for political S. D. of: _____

Signature by a representative of the County Engineer's Dept. denotes that this plat meets tax map plat requirements.
 Signed: _____ Date: _____

KUCK and MORRISEY, INC.
 CONSULTING ENGINEERS & SURVEYORS
 LIMA, OHIO 45805
 TELEPHONE 228-1735 - AREA CODE 419
 2807 CHAPEL HILL DRIVE

Client Mr. Marc WILKINS
 County Auglaize Twp. Logan Sec. 20
 Drawn by RDM Scale 1"=300 Drwg. No. _____
 Checked by rdm Date 5/20/98
 Sheet 1 of 1 P-681 (T-4-S; R-5-E)