

DESCRIPTION - PARCEL 1

Being a parcel of land situate in the Northeast quarter of Section 35, T-4-S, R-6-E, Duchouquet Township, Auglaize County, Ohio and more particularly described as follows:

Commencing at a PK nail found at the intersection of the north line of said Northeast quarter of said Section 35 with the centerline of County Road 25-A (South Dixie Highway); thence S 00°49'33" W with said centerline of said County Road 25-A (passing through a railroad spike found at 1,098.61 feet at the intersection of said centerline with the centerline of Main Street), 1,323.23 feet to a point; thence S 89°10'27" E, 40.00 feet to a three (3) inch steel post found on the east right-of-way line of said County Road 25-A and the **PLACE OF BEGINNING** thence S 89°11'57" E (passing through a 5/8 inch rebar found at 383.48 feet), 384.62 feet to a capped 5/8 inch rebar set on the west limited access right-of-way line of Interstate 75; thence S 25°40'48" E with said west limited access right-of-way line, 348.37 feet to a capped 5/8 inch rebar set; thence S 89°33'29" W, 322.67 feet to a capped 5/8 inch rebar set; thence N 01°47'24" W, 87.95 feet to a PK nail and shiner set; thence N 80°51'14" E, 72.06 feet to a PK nail and shiner set; thence N 07°02'41" W, 42.01 feet to a capped 5/8 inch rebar set; thence S 82°57'20" W, 105.00 feet to a capped 5/8 inch rebar set; thence N 00°49'33" E, 77.83 feet to a capped 5/8 inch rebar set; thence N 89°11'57" W, 174.69 feet to a capped 5/8 inch rebar set on the east right-of-way line of said County Road 25-A; thence N 00°49'33" E with said east right-of-way line, 113.39 feet to the **PLACE OF BEGINNING** containing 2.358 acres more or less and subject to all legal easements of record.

Surveyed by: **KUCK and MORRISEY, Inc.**, Richard D. Morrissey, L.S. No. 6470 (Ohio)

DESCRIPTION - PARCEL 4

Being a parcel of land situate in the Northeast quarter of Section 35, T-4-S, R-6-E, Duchouquet Township, Auglaize County, Ohio and more particularly described as follows:

Commencing at a PK nail found at the intersection of the north line of said Northeast quarter of said Section 35 with the centerline of County Road 25-A (South Dixie Highway); thence S 00°49'33" W with said centerline of said County Road 25-A (passing through a railroad spike found at 1,098.61 feet at the intersection of said centerline with the centerline of Main Street), 1,641.96 feet to a point; thence S 89°10'27" E, 40.00 feet to a capped 5/8 inch rebar set on the east right-of-way line of said County Road 25-A and the **PLACE OF BEGINNING** thence S 89°10'27" E, 217.50 feet to a capped 5/8 inch rebar set; thence N 89°33'29" E, 322.67 feet to a capped 5/8 inch rebar set on the west limited access right-of-way line of Interstate 75; thence S 25°40'48" E with said west limited access right-of-way line, 90.00 feet to a concrete right-of-way monument found; thence S 00°55'00" W continuing with said west limited access right-of-way line, 433.60 feet to a capped 5/8 inch rebar set; thence N 89°10'27" W, 579.57 feet to a capped 5/8 inch rebar set on the east right-of-way line of said County Road 25-A; thence N 00°49'33" E with said east right-of-way line, 507.00 feet to the **PLACE OF BEGINNING** containing 6.746 acres more or less and subject to all legal easements of record.

Surveyed by: **KUCK and MORRISEY, Inc.**, Richard D. Morrissey, L.S. No. 6470 (Ohio)

LEGEND:

- A - Capped 5/8 inch rebar (set)
- B - PK nail and shiner (set)
- C - Concrete of an existing concrete step
- D - Railroad spike (found) at intersection of County Road 25-A and Main Street,
- E - PK nail (found) at intersection of County Road and the south line of N.E. 1/4, Section 35,
- F - PK nail (found) at intersection of County Road and the north line of N.E. 1/4, Section 35,
- G - three (3) inch steel post (found) on the east right-of-way line of said County Road 25-A,
- H - 5/8 inch rebar (found),
- I - Concrete right-of-way monument (found).

I hereby certify the accompanying map and survey, which it represents to be correct to best of my knowledge and belief. All rebar set and called for are topped with a plastic Peramark cap stamped:
KUCK & MORRISEY L.S. 6470

Date: 10/10/09
Richard D. Morrissey, L.S. 6470 (Ohio)
KUCK & MORRISEY, Inc.

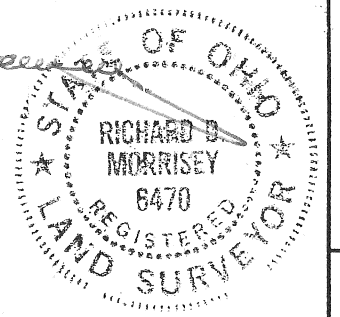

KUCK and MORRISEY, INC.
CONSULTING ENGINEERS & SURVEYORS - LIMA, OHIO
2807 Chapel Hill Drive, Lima, Ohio
(419) 228-1735 Phone & Fax

Surveyed By: RDM
Date: 10/10/09

Dr. George F. Ryan
109 S. Dixie
Cridersville, Ohio

Part of N.E. 1/4, Section 35, T-4-S,
R-6-E, Duchouquet Township,
Auglaize County, Ohio



