

Springer to Sawmiller Boundary Survey

Part of the NE 1/4 of Section 21,
Town-5-South, Range-6-East,
Duchouquet Township,
Auglaize County, Ohio

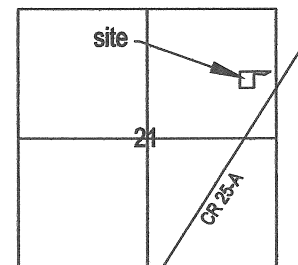

VICINITY MAP ~ SECTION 21
DUCHOUQUET TOWNSHIP

LEGEND

- 5/8" re-rod w/cap (found)
- △ monument box (found)
- ⊙ railroad spike (found)
- fence post (found)
- ⊙ 5/8" re-rod w/cap (set)

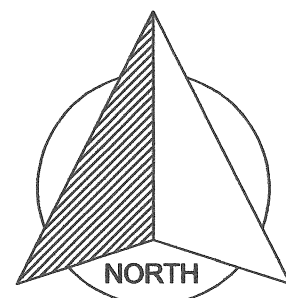

GRAPHIC SCALE

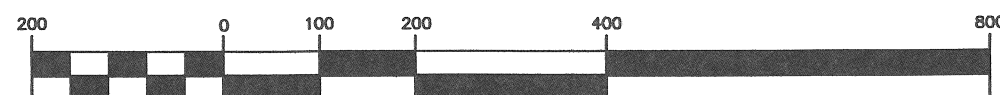

(IN FEET)
1 inch = 200 ft.

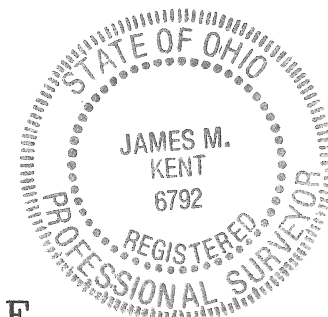
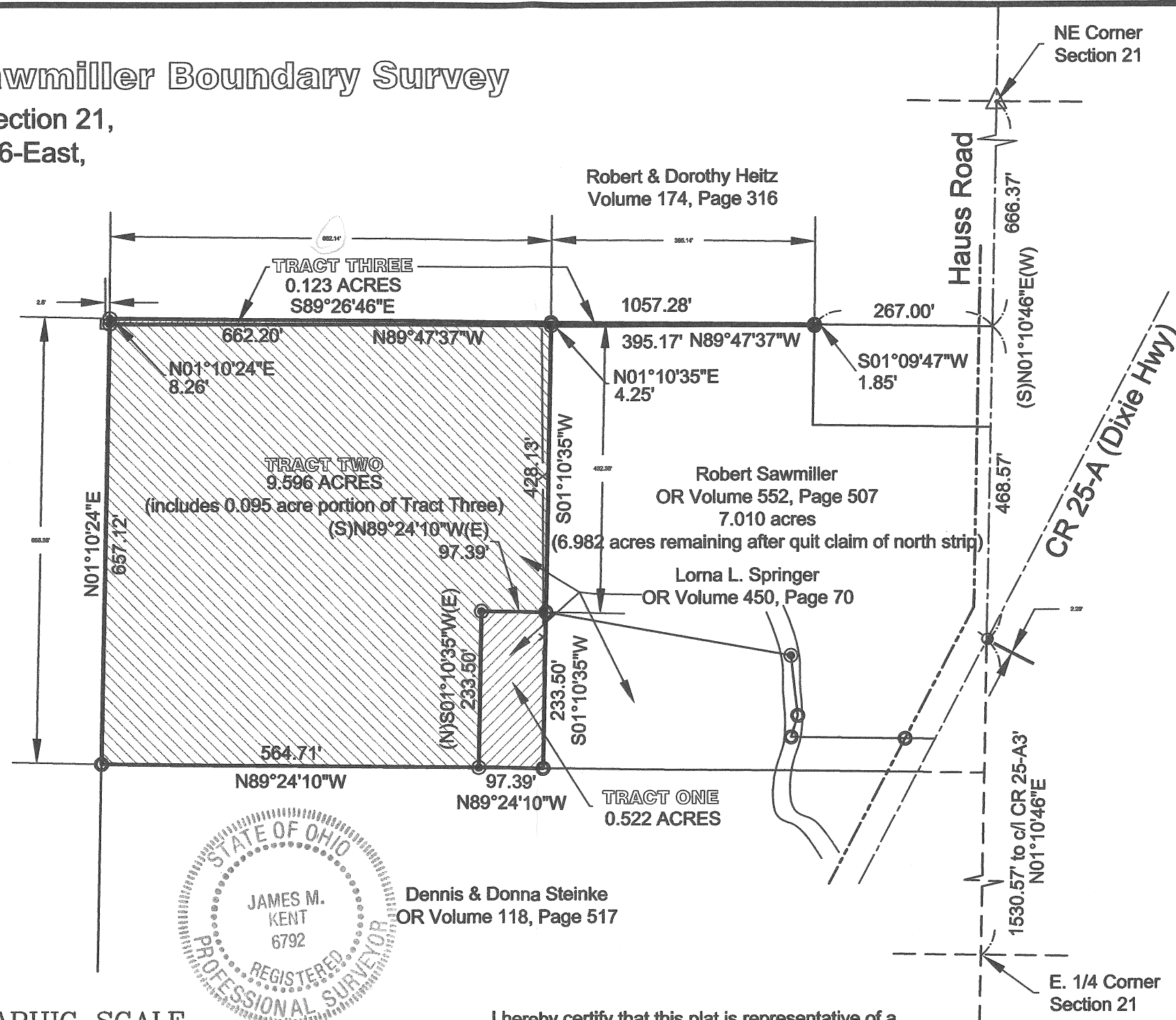

I hereby certify that this plat is representative of a
field survey, performed under my direct supervision.

James M. Kent, Professional Surveyor No. 6792

kent surveying, inc.
AutoCAD ~ Sawmiller, Bob
drawing #4984
February 5, 2008

Q-1

Area retained by Lorna Springer
Tract One

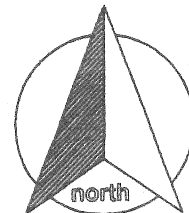

scale:

SURVEYOR'S DESCRIPTION

Being a part of the northeast quarter of Section 21, Town-5-South, Range-6-East, Duchouquet Township, Auglaize County, Ohio as evidenced by O.R. Volume 450, Page 70 and more particularly described as follows:

Commencing for reference at a monument box (found) at the northeast corner of Section 21 and the legal centerline of Hauss Road; thence, S 01° 10' 46" W along the east line of the northeast quarter of Section 21 and the legal centerline of Hauss Road, for a distance of 666.37 feet to a point; thence, N 89° 47' 37" W passing through the west right-of-way line of Hauss Road at a distance of 20.00 feet) for a total distance of 662.14 feet to a 5/8" re-rod w/cap (found); thence, S 01° 10' 35" W for a distance of 432.38 feet to a 5/8" re-rod w/cap (found) said re-rod being the **POINT OF BEGINNING** for the tract herein described;

Thence, continuing S 01° 10' 36" W for a distance of 233.50 feet to a 5/8" re-rod (found);

Thence, N 89° 24' 10" W for a distance of 97.39 feet to a 5/8" re-rod w/cap (set);

Thence, N 01° 10' 35" E for a distance of 233.50 feet to a 5/8" re-rod w/cap (set);

Thence, S 89° 24' 10" E for a distance of 97.39 feet to the **POINT OF BEGINNING** containing therein **0.522 acres**. This is an "add-on" tract, and is not to be transferred as an individual residential lot. Subject to all easements and right-of-way of record at the time of the recording of this instrument. Prepared by James M. Kent, P.S. 6792 with reference herein made to a plat of survey; Kent Surveying, Inc., drawing #4984 dated February 5, 2007. Basis of bearings is per Kent Surveying drawing #1941 dated November 2, 1993 depicting the centerline of Hauss Road as S 01° 10' 46" W.

Corrected distance 4th paragraph - 2/11/08





James M. Kent, PS 6792

CLIENT BOB SAWMILLER DATE 2-11-08
COUNTY AUGLAIZE TOWNSHIP DUCHOUQUET
SECTION 21 T-5-S; R-6-E DRAWN BY JMK
SHEET 1 OF 3 DWG. # 4984

 **kent surveying, inc.**
P.O. Box 96 - 1750 Bellefontaine Street
Wapakoneta, OH 45895
419-738-5677 fax 419-738-7894

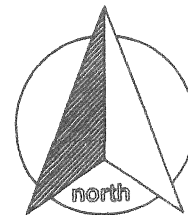
Lorna Springer to Bob Sawmiller
Tract Two



scale:

SURVEYOR'S DESCRIPTION

Being a part of the northeast quarter of Section 21, Town-5-South, Range-6-East, Duchouquet Township, Auglaize County, Ohio as evidenced by O.R. Volume 450, Page 70 and more particularly described as follows:

Commencing for reference at a monument box (found) at the northeast corner of Section 21 and the legal centerline of Hauss Road; thence, S 01° 10' 46" W along the east line of the northeast quarter of Section 21 and the legal centerline of Hauss Road, for a distance of 666.37 feet to a point; thence, N 89° 47' 37" W passing through the west right-of-way line of Hauss Road at a distance of 20.00 feet) for a total distance of 662.14 feet to a 5/8" re-rod w/cap (found), said re-rod being the **POINT OF BEGINNING** for the tract herein described;

Thence, S 01° 10' 35" W for a distance of 432.38 feet to a 5/8" re-rod w/cap (found);

Thence, N 89° 24' 10" W for a distance of 97.39 feet to a 5/8" re-rod w/cap (set);

Thence, S 01° 10' 35" W for a distance of 233.50 feet to a 5/8" re-rod w/cap (set);

Thence, N 89° 24' 10" W for a distance of 564.71 feet to a 5/8" re-rod w/cap (found);

Thence, N 01° 10' 24" E for a distance of 665.38 feet to a 5/8" re-rod w/cap (set);

Thence, S 89° 26' 46" E for a distance of 662.14 feet to the **POINT OF BEGINNING** containing therein **9.596 acres**. This is an "add-on" tract, and is not to be transferred as an individual residential lot. Subject to all easements and right-of-way of record at the time of the recording of this instrument. Prepared by James M. Kent, P.S. 6792 with reference herein made to a plat of survey; Kent Surveying, Inc., drawing #4984 dated February 5, 2007. Basis of bearings is per Kent Surveying drawing #1941 dated November 2, 1993 depicting the centerline of Hauss Road as S 01° 10' 46" W.

Corrected distance 4th paragraph - 2/11/08

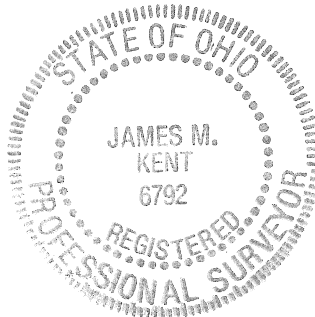



James M. Kent, PS 6792

CLIENT BOB SAWMILLER DATE 2-11-08
COUNTY AUGLAIZE TOWNSHIP DUCHOUQUET
SECTION 21 T-5-S; R-6-E DRAWN BY JMK
SHEET 2 OF 3 DWG. # 4984

 **kent surveying, inc.**
P.O. Box 96 - 1750 Bellefontaine Street
Wapakoneta, OH 45895
419-738-5677 fax 419-738-7894

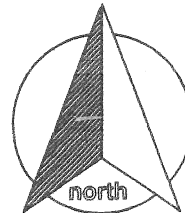
Bob Sawmiller quit claim to Robert & Dorothy Heitz
subsequent to transfer of Tract Two
Tract Three



scale:

SURVEYOR'S DESCRIPTION

Being a part of the northeast quarter of Section 21, Town-5-South, Range-6-East, Duchouquet Township, Auglaize County, Ohio as evidenced by O.R. Volume 552, Page 507 and O.R. Volume ____, Page ____ and more particularly described as follows:

Commencing for reference at a monument box (found) at the northeast corner of Section 21 and the legal centerline of Hauss Road; thence, S 01° 10' 46" W along the east line of the northeast quarter of Section 21 and the legal centerline of Hauss Road, for a distance of 666.37 feet to a point; thence, N 89° 47' 37" W passing through the west right-of-way line of Hauss Road at a distance of 20.00 feet) for a total distance of 267.00 feet to a 5/8" re-rod w/cap (found), said re-rod being the **POINT OF BEGINNING** for the tract herein described;

Thence, S 01° 09' 47" W for a distance of 1.85 feet to a 5/8" re-rod w/cap (found);

Thence, N 89° 47' 37" W for a distance of 1057.37 feet to a 5/8" re-rod w/cap (set);

Thence, N 01° 10' 24" E for a distance of 8.26 feet to a 5/8" re-rod w/cap (set);

Thence, S 89° 26' 46" E for a distance of 1057.28 feet to the **POINT OF BEGINNING** containing therein **0.123 acres**. Subject to all easements and right-of-way of record at the time of the recording of this instrument. Prepared by James M. Kent, P.S. 6792 with reference herein made to a plat of survey; Kent Surveying, Inc., drawing #4984 dated February 5, 2007. Basis of bearings is per Kent Surveying drawing #1941 dated November 2, 1993 depicting the centerline of Hauss Road as S 01° 10' 46" W.

Corrected distance to Point of Beginning 2/11/08

James M. Kent, PS 6792



CLIENT BOB SAWMILLER DATE 2-11-08
COUNTY AUGLAIZE TOWNSHIP DUCHOUQUET
SECTION 21 T-5-S; R-6-E DRAWN BY JMK
SHEET 3 OF 3 DWG. # 4984

kent surveying, inc.
P.O. Box 96 - 1750 Bellefontaine Street
Wapakoneta, OH 45895
419-738-5677 fax 419-738-7894