

**Nedderman Estate Survey**  
Part of the SW 1/4 of Section 22,  
Town-6-South, Range-4-East,  
St. Marys Township,  
Auglaize County, Ohio as evidenced  
by Official Record Volume 219, Page 1014

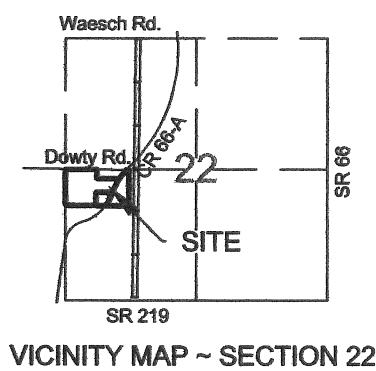

- LEGEND**
- Monument Box (found)
  - 5/8" Re-Rod w/Cap (found)
  - 5/8" Re-Rod w/Cap (set)
  - ⦿ Mag-Nail (set)

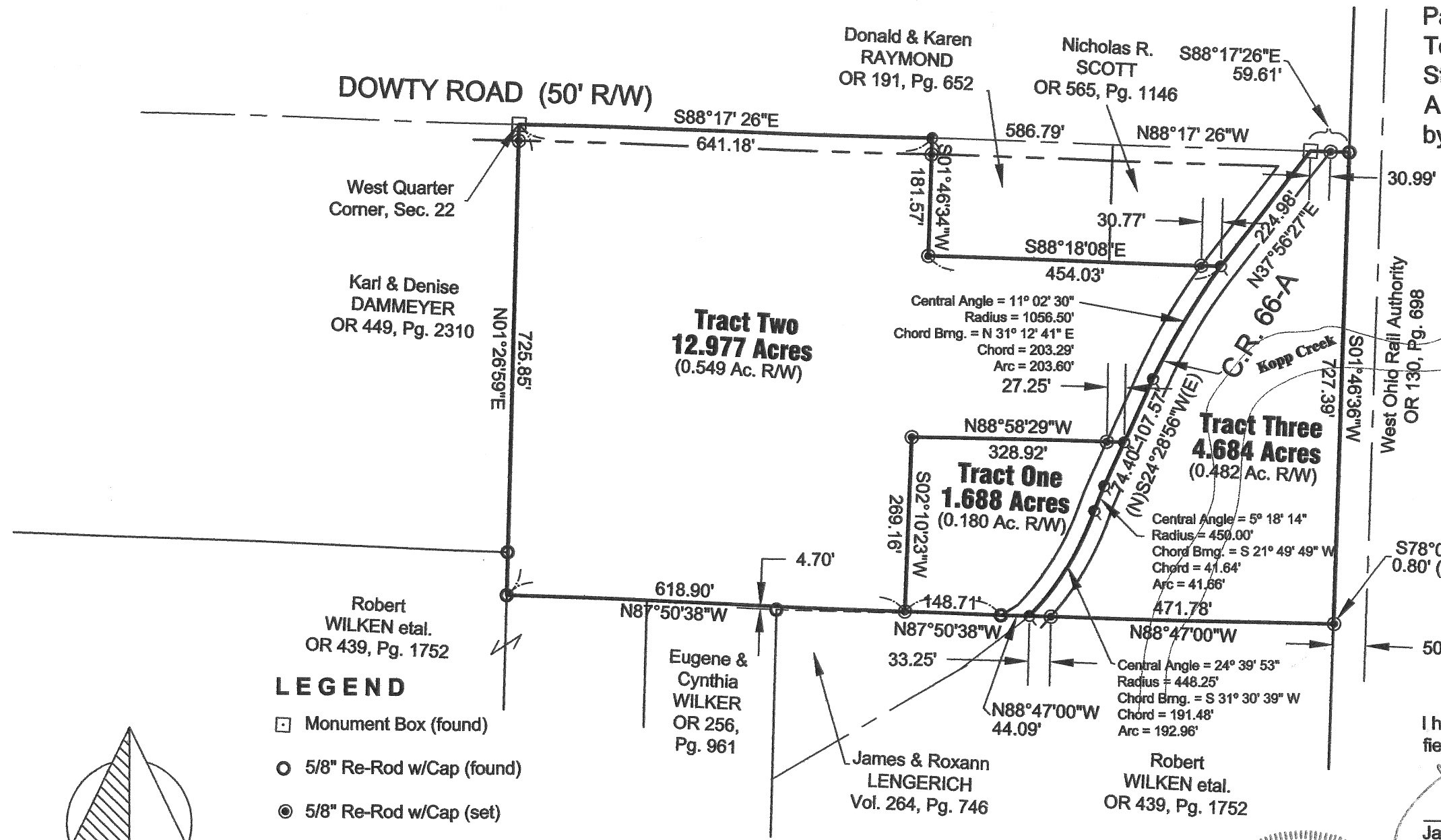
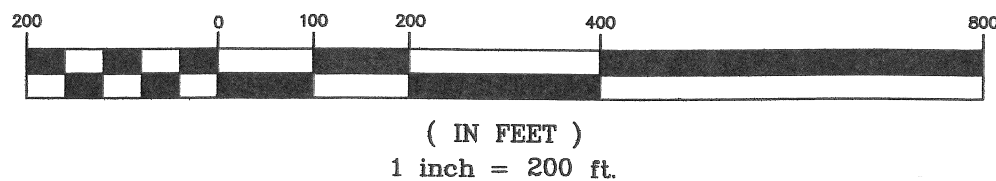
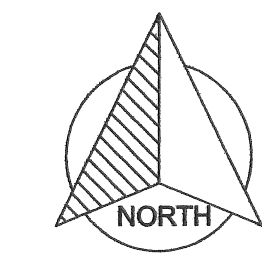

Basis of bearings is per the "Wilker Survey"  
prepared by James W. Geeslin, PS 7764  
dated 1/28/01 depicting the north line of the  
southwest quarter of Section 22 as S88°17' 26"E

I hereby certify that this plat is representative of a  
field survey prepared under my direct supervision.

*James M. Kent*  
James M. Kent, Professional Surveyor No. 6792

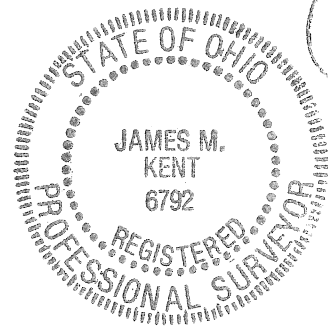

**kent surveying, inc.**  
AutoCAD ~ Nedderman Estate  
drawing #5083  
January 15, 2009

Q228

Nedderman Estate  
Tract One

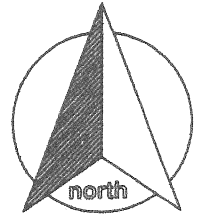

scale:

### SURVEYOR'S DESCRIPTION

Being a part of the southwest quarter of Section 22, Town-6-South, Range-4-East, St. Marys Township, Auglaize County, Ohio as evidenced by Official Record Volume 219, Page 1014 and more particularly described as follows:

Commencing for reference at a monument box found on the west quarter corner of Section 22, said quarter corner also being the legal centerline of Dowly Road; thence, S 01° 26' 59" W for a distance of 725.85 feet to a 5/8" re-rod w/cap (found); thence, S 87° 50' 38" E for a distance of 618.90 feet to a 5/8" re-rod w/cap (set), said re-rod being the **POINT OF BEGINNING** for the tract herein described;

thence, N 02° 10' 23" E for a distance of 269.16 feet to a 5/8" re-rod w/cap (set);

thence, S 88° 58' 29" E (passing through a 5/8" re-rod w/cap set on the west right-of-way line of County Road 66-A at a distance of 301.67 feet) for a total distance of 328.92 feet to a mag-nail (set) on the centerline of County Road 66-A);

thence, S 24° 28' 56" W along the aforesaid centerline for a distance of 74.40 feet to a mag-nail (set) on a point of curve;

thence, continuing along the aforesaid centerline on a tangent curve to the left, said curve having a central angle which measures 05° 18' 14"; a radius which measures 450.00 feet; a chord which bears S 21° 49' 49" W and a chord which measures 41.64 feet, for a total arc length which measures 41.66 feet to a mag-nail set at a point of reverse curve;

thence, continuing along the aforesaid centerline on a tangent curve to the right, said curve having a central angle which measures 24° 39' 53"; a radius which measures 448.25 feet; a chord which bears S 31° 30' 39" W and a chord which measures 191.48 feet, for a total arc length which measures 192.96 feet to a mag-nail (set);

thence, N 88° 47' 00" W for a distance of 44.09 feet to a 5/8" re-rod w/cap (found) on the west right-of-way line of County Road 66-A;

thence, N 87° 50' 38" W for a distance of 148.71 feet to the **POINT OF BEGINNING**, containing therein **1.688 acres** of which 0.180 acres is road right-of-way. Subject to all easements and right-of-way of record at the time of the recording of this instrument. Prepared by James M. Kent, Professional Surveyor No. 6792 with reference herein made to a plat of survey; Kent Surveying, Inc., drawing #5083 dated January 15, 2009. Basis of bearings is per the "Wilker Survey" prepared by James W. Geeslin, Professional Surveyor No. 7764 dated 1/28/01 and depicting the north line of the southwest quarter of Section 22 as S 88° 17' 26" E.

Corrected bearing direction - third paragraph 1/21/09

  
James M. Kent, PS 6792

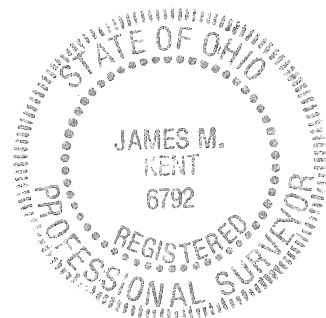

CLIENT NEDDERMAN ESTATE DATE 1-21-09  
COUNTY AUGLAIZE TOWNSHIP ST. MARYS  
SECTION 22 T-6-S; R-4-E DRAWN BY JMK  
SHEET 1 OF 3 DWG. # 5083

 **kent surveying, inc.**  
P.O. Box 96 - 1750 Bellefontaine Street  
Wapakoneta, OH 45895  
419-738-5677 fax 419-738-7894

Nedderman Estate  
Tract Two

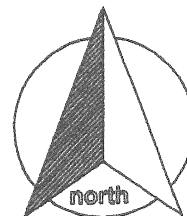

**SURVEYOR'S DESCRIPTION**

scale:

Being a part of the southwest quarter of Section 22, Town-6-South, Range-4-East, St. Marys Township, Auglaize County, Ohio as evidenced by Official Record Volume 219, Page 1014 and more particularly described as follows:

Commencing for reference at a monument box found on the north line of the southwest quarter of Section 22 and the legal centerline intersection of Dowty Road and County Road 66-A; thence, N 88° 17' 26" W along the aforesaid north line and legal centerline of Dowty Road for a distance of 586.79 feet to a mag-nail (set), said nail being the **POINT OF BEGINNING** for the tract herein described;

thence, S 01° 46' 34" W (passing through a 5/8" re-rod w/cap set on the south right-of-way line of Dowty Road at a distance of 25.00 feet) for a total distance of 181.57 feet to a 5/8" re-rod w/cap (set);

thence, S 88° 18' 08" E (passing through a 5/8" re-rod w/cap set on the west right-of-way line of CR 66-A at a distance of 423.26 feet) for a total distance of 454.03 feet to a mag-nail (set) on the centerline of CR 66-A;

thence, with the centerline of CR 66-A on a non-tangent curve which is concave to the southeast, said curve having a central angle which measures 11° 02' 30", a radius which measures 1056.50 feet, a chord which bears S 31° 12' 41" W and a chord which measures 203.29 feet, for a total arc length of 203.60 feet to a mag-nail (set);

thence, continuing along the aforesaid centerline, S 24° 28' 56" W for a distance of 107.57 feet to a mag-nail (set);

thence, N 88° 58' 29" W (passing through a 5/8" re-rod w/cap set on the west right-of-way line of CR 66-A at a distance of 27.25 feet) for a total distance of 328.92 feet to a 5/8" re-rod w/cap (set);

thence, S 02° 10' 23" W for a distance of 269.16 feet to a 5/8" re-rod w/cap (set);

thence, N 87° 50' 38" W for a distance of 618.90 feet to a 5/8" re-rod w/cap (found);

thence, N 01° 26' 59" E (passing through a 5/8" re-rod w/cap set on the south right-of-way line of Dowty Road at distance of 700.85 feet) for a total distance of 725.85 feet to a monument box (found) at the west quarter corner of Section 22 and the legal centerline of Dowty Road;

thence, S 88° 17' 26" E along the north line of the southwest quarter of Section 22 and the aforesaid legal centerline, for a distance of 641.18 feet to **POINT OF BEGINNING**, containing therein **12.977 acres** of which 0.549 acres is road right-of-way. Subject to all easements and right-of-way of record at the time of the recording of this instrument. Prepared by James M. Kent, Professional Surveyor No. 6792 with reference herein made to a plat of survey; Kent Surveying, Inc., drawing #5083 dated January 15, 2009. Basis of bearings is per the "Wilker Survey" prepared by James W. Geeslin, Professional Surveyor No. 7764 dated 1/28/01 and depicting the north line of the southwest quarter of Section 22 as S 88° 17' 26" E.

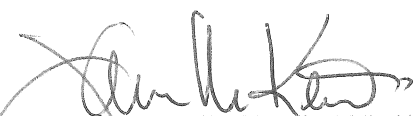
  
James M. Kent, PS 6792

Q 230

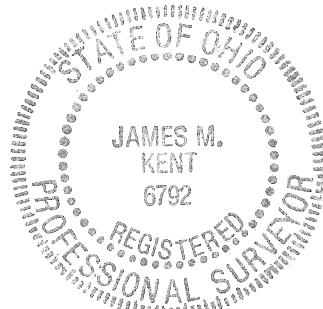

CLIENT NEDDERMAN ESTATE DATE 1-20-09  
COUNTY AUGLAIZE TOWNSHIP ST. MARYS  
SECTION 22 T- 6-S; R- 4-E DRAWN BY JMK  
SHEET 2 OF 3 DWG. # 5083

 **kent surveying, inc.**  
P.O. Box 96 - 1750 Bellefontaine Street  
Wapakoneta, OH 45895  
419-738-5677 fax 419-738-7894

Nedderman Estate  
Tract Three

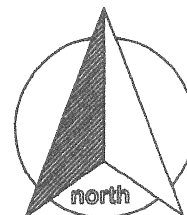

### SURVEYOR'S DESCRIPTION

scale:

Being a part of the southwest quarter of Section 22, Town-6-South, Range-4-East, St. Marys Township, Auglaize County, Ohio as evidenced by Official Record Volume 219, Page 1014 and more particularly described as follows:

Commencing for reference at a monument box found on the west quarter corner of Section 22, said quarter corner also being the legal centerline of Dowty Road; thence, S 01° 26' 59" W for a distance of 725.85 feet to a 5/8" re-rod w/cap (found); thence, S 87° 50' 38" E for a distance of 767.61 feet to a 5/8" re-rod w/cap (found) on the west right-of-way line of County Road 66-A; thence, S 88° 47' 00" E for a distance of 44.09 feet to a mag-nail (set) on the centerline of County Road 66-A, said nail being the **POINT OF BEGINNING** for the tract herein described;

thence, along the centerline of CR 66-A on a non-tangent curve which is concave to the northwest, said curve having a central angle which measures 24° 39' 53", a radius which measures 448.25 feet, a chord which bears N 31° 30' 39" E and a chord which measures 191.48 feet for a total arc length of 192.96 feet to a mag-nail set at a point of reverse curve;

thence, continuing along the aforesaid centerline on a tangent curve to the right, said curve having a central angle which measures 05° 18' 14", a radius which measures 450.00 feet, a chord which bears N 21° 49' 49" E and a chord which measures 41.64 feet for a total arc length of 41.66 feet to a mag-nail (set);

thence, continuing along the aforesaid centerline, N 24° 28' 56" E for a distance of 181.97 feet to a mag-nail (set) on a point of curve;

thence, continuing along the aforesaid centerline on a non-tangent curve to the right, said curve having a central angle which measures 11° 02' 30", a radius which measures 1056.50 feet, a chord which bears N 31° 12' 41" E and a chord which measures 203.29 feet, for a total arc length of 203.60 feet to a mag-nail set;

thence, continuing along the aforesaid centerline N 37° 56' 27" E for a distance of 224.98 feet to a monument box found on the north line of the southwest quarter of Section 22 and the centerline intersection of CR 66-A and Dowty Road;

thence, leaving the centerline of CR 66-A, on the north line of the southwest quarter of Section 22, S 88° 17' 26" E (passing through a 5/8" re-rod w/cap set on the east right-of-way line of CR 66-A at a distance of 30.99 feet) for a total distance of 59.61 feet to a 5/8" re-rod w/cap (found) on the west line of the West Ohio Rail Authority Railroad;

thence, S 01° 46' 36" W along the aforesaid west line, for a distance of 727.39 feet to a point (said point referenced by a 5/8" re-rod w/cap set bearing N 78° 01' 10" E of and 0.80 feet from said corner;

thence, N 88° 47' 00" W (passing through a 5/8" re-rod w/cap set on the east right-of-way line of CR 66-A at a distance of 427.69 feet) for a total distance of 471.78 feet to the **POINT OF BEGINNING**, containing therein **4.684 acres** of which 0.482 acres is road right-of-way. Subject to all easements and right-of-way of record at the time of the recording of this instrument. Prepared by James M. Kent, Professional Surveyor No. 6792 with reference herein made to a plat of survey; Kent Surveying, Inc., drawing #5083 dated January 15, 2009. Basis of bearings is per the "Wilker Survey" prepared by James W. Geeslin, Professional Surveyor No. 7764 dated 1/28/01 and depicting the north line of the southwest quarter of Section 22 as S 88° 17' 26" E.

  
James M. Kent, PS 6792

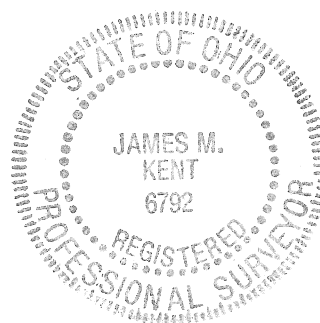

Q231

CLIENT NEDDERMAN ESTATE DATE 1-20-09  
COUNTY AUGLAIZE TOWNSHIP ST. MARYS  
SECTION 22 T-6-S; R-4-E DRAWN BY JMK  
SHEET 3 OF 3 DWG. # 5083

 **kent surveying, inc.**  
P.O. Box 96 - 1750 Bellefontaine Street  
Wapakoneta, OH 45895  
419-738-5677 fax 419-738-7894