

Q-266

# Bockrath & Associates Engineering and Surveying, LLC

137 W. Third St. - Ottawa, OH 45875

(419) 523-5789

## 0.404 ACRE PARCEL

Situated as being part of the Northwest Quarter of Section 36, Township 5 South, Range 5 East, Moulton Township, Auglaize County, Ohio, also being part of a 5.439 acre tract of land as recorded in Official Record Volume 536, Page 471 and more particularly described as follows:

Beginning at a 5/8 inch rebar with ID cap found marking the Southwest corner of the above mentioned 5.439 acre tract of land as recorded in Official Record Volume 536, Page 471 and the POINT OF BEGINNING;

Thence North 00°55'25" East along the West line of said tract (also being the East line of a 7.825 acre tract of land as recorded in Official Record Volume 536, Page 1615) a distance of 352.20 feet to a 5/8 inch rebar with ID cap found marking the Northwest corner of said 5.439 acre tract;

Thence South 87°51'25" East along the North line of said 5.439 acre tract (also being the South line of a 6.990 acre tract of land as recorded in Official Record Volume 573, Page 47) a distance of 50.00 feet to a 5/8 inch rebar with ID cap set;

Thence South 00°55'25" West along a new division a distance of 352.20 feet to a 5/8 inch rebar with ID cap set on the South line of said 5.439 acre tract (also being the North line of the limited access right-of-way of U.S. Route 33);

Thence North 87°51'25" West along said South line (North line of the limited access right-of-way of U.S. Route 33) a distance of 50.00 feet to the POINT OF BEGINNING, said parcel containing 0.404 acres of land, more or less, of which 0.000 acres lies within road right-of-way.

Subject to all legal highways, easements, and restrictions of use whether apparent and/or of record and is from an actual field survey performed in April, 2009, under the supervision of Ohio Professional Surveyor Gregory A. Bockrath, Ohio Surveyor No. 8306.

Note: The bearings used in this description are on an assumed meridian assuming the West line of a 5.439 acre tract of land as recorded in Official Record Volume 536, Page 471 to be North 00 degrees 55 minutes 25 seconds East and are for the purpose of angle determination only.

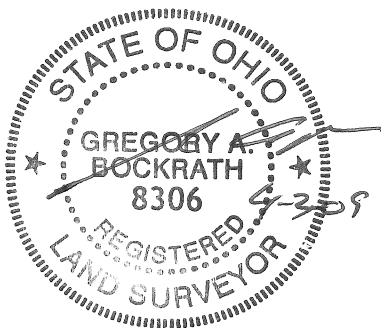

 4-3-09

Gregory A. Bockrath P.S.  
Registered Surveyor No. 8306  
Bockrath & Associates  
Engineering and Surveying, LLC

Q-267