

STROH-MORAN PARCEL SWAP

Two - 0.25 Acre Parcels being a part of the Southwest Quarter of
Section 12, St. Marys Township, Town-6-South, Range-4-East,
County of Auglaize, State of Ohio

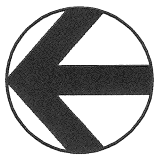

PARCEL A - STROH to MORAN
PARCEL B - MORAN to STROH

LOCATION PLAN

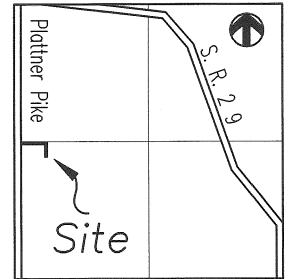

Section 12, St. Marys Twp.
Auglaize County, Ohio

LEGEND

- Iron Pin (set)
- △ Mag Nail (set)
- Monument Box

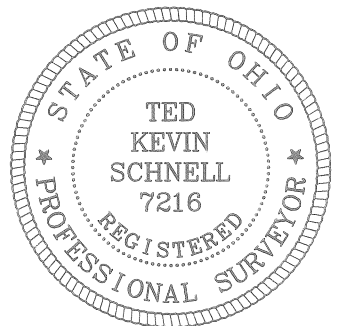
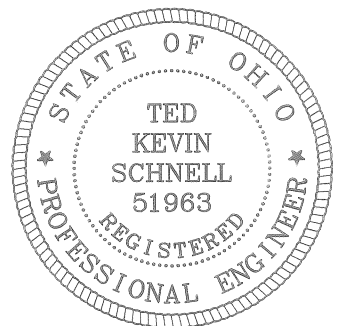

ATTEST

Ted K. Schnell

Ted K. Schnell
Professional Engineer
Professional Surveyor

PLATTNER - PIKE
ASSUMED SOUTH FROM PREVIOUS SURVEYS



SCALE

NOTES

The Basis of Bearings used for this Survey was determined
from a previous Survey by Michael Weadock, PS 6199 dated
March 24, 1987. See SURVEY BOOK H, PAGE 758.

This Survey Plat and Description is Recorded in Survey Book
Q, Page 276, Auglaize County Engineer's Tax
Map Office.

H & S Civil Engineers and Land Surveyors

913 Fieldstone Court Wapakoneta, Ohio 45895

DAVID STROH
client

12
section

ST. MARYS
township

AUGLAIZE
county

OHIO
state

04/10/09
date



H & S Civil Engineers and Land Surveyors

913 Fieldstone Court
Wapakoneta, Ohio 45895
Phone (419) 738-4758
Fax (419) 739-7631
email: hscivil@bright.net

Ted K. Schnell P.E., P.S.

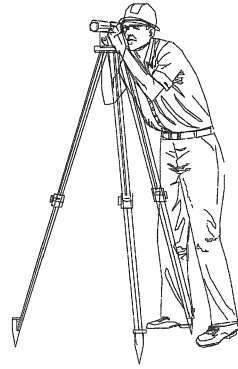

04/10/09

SURVEYOR'S DESCRIPTION FOR 0.25 ACRE PARCEL CARL D. STROH TO PATRICK & MARY MORAN

The following described parcel of land is situated in the Southwest Quarter of Section 12, St. Marys Township, Town-6-South, Range-4-East, Auglaize County, Ohio, and is more particularly described as follows:

Commencing for reference at a Monument Box located at the Northwest Corner of the Southwest Quarter of said Section 12, St. Marys Township, and the PLACE OF BEGINNING;

Thence with a bearing of N. 89°-22'-50" E. along the North line of the Southwest Quarter of said Section 12, St. Marys Township, for a distance of 363.00 feet to an Iron Pin (set);

Thence with a bearing of S. 00°-00' E. for a distance of 30.00 feet to an Iron Pin (set);

Thence with a bearing of S. 89°-22'-50" W. for a distance of 363.00 feet to an Mag Nail (set);

Thence with a bearing of N. 00°-00' W. along the West line of the Southwest Quarter of said Section 12, St. Marys Township, and the centerline of Plattner Pike, C.R. #61, for a distance of 30.00 feet to a Monument Box and the original PLACE OF BEGINNING.

Containing in all 0.250 Acres of land, of which 0.017 Acre being previously dedicated for highway purposes. The above described parcel of land is also subject to all other legal easements, reservations, or restrictions, if any, upon said premises.

The basis of bearings used for this survey were determined from previous surveys on file with the Auglaize County Engineer's Tax Map Office, whereas the West line of the Southwest Quarter of Section 12, St. Marys Township bears due South.

Previous Deed References: Deed Volume OR 46, Page 319, Auglaize County Recorder's Office.

PREPARED BY:

A handwritten signature in black ink, appearing to read "Ted K. Schnell", written over a horizontal line.

Ted K. Schnell
Professional Engineer
Professional Surveyor

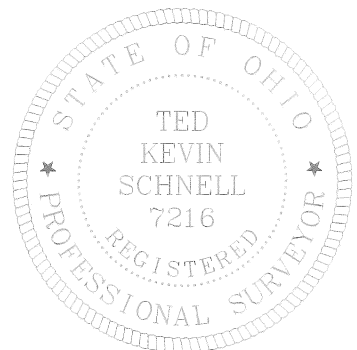
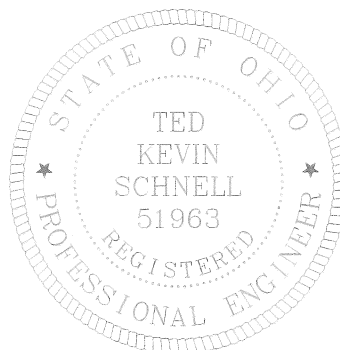

PARCEL A

Q277

H & S Civil Engineers and Land Surveyors

913 Fieldstone Court
Wapakoneta, Ohio 45895
Phone (419) 738-4758
Fax (419) 739-7631
email: hscivil@bright.net

Ted K. Schnell P.E., P.S.

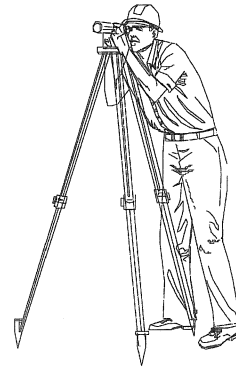

04/10/09

SURVEYOR'S DESCRIPTION FOR 0.250 ACRE PARCEL PATRICK & MARY MORAN TO CARL D. STROH

The following described parcel of land is situated in the Southwest Quarter of Section 12, St. Marys Township, Town-6-South, Range-4-East, Auglaize County, Ohio, and is more particularly described as follows:

Commencing for reference at a Monument Box located at the Northwest Corner of the Southwest Quarter of said Section 12, St. Marys Township;

Thence with a bearing of N. 89°-22'-50" E. along the North line of the Southwest Quarter of said Section 12, St. Marys Township, for a distance of 363.00 feet to an Iron Pin (set);

Thence with a bearing of S. 00°-00' E. for a distance of 30.00 feet to an Iron Pin (set) and the PLACE OF BEGINNING;

Thence with a bearing of N. 89°-22'-50" E. for a distance of 51.86 feet to a point;

Thence with a bearing of S. 00°-00' E. for a distance of 210.00 feet to a point;

Thence with a bearing of S. 89°-22'-50" W. for a distance of 51.86 feet to an Iron Pin (set);

Thence with a bearing of N. 00°-00' W. for a distance of 210.00 feet to an Iron Pin (set) and the original PLACE OF BEGINNING.

Containing in all 0.250 Acres of land. The above described parcel of land is also subject to all other legal easements, reservations, or restrictions, if any, upon said premises.

The basis of bearings used for this survey were determined from previous surveys on file with the Auglaize County Engineer's Tax Map Office, whereas the West line of the Southwest Quarter of Section 12, St. Marys Township bears due South.

Previous Deed References: Deed Volume OR 50, Page 257, Auglaize County Recorder's Office.

PREPARED BY:

A handwritten signature in cursive script that reads "Ted K. Schnell".

Ted K. Schnell
Professional Engineer
Professional Surveyor

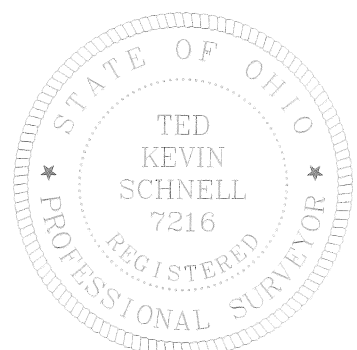
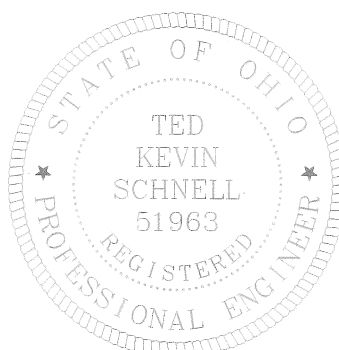

PARCEL B

Q278