

SURVEY FOR LEON E. & ELAINE A. HEITKAMP

BEING THE NORTHEAST QUARTER (1/4) OF THE NORTHWEST FRACTIONAL QUARTER (1/4) OF SECTION 19, TOWN 7 SOUTH, RANGE 4 EAST, JACKSON TOWNSHIP, AUGLAIZE COUNTY, OHIO

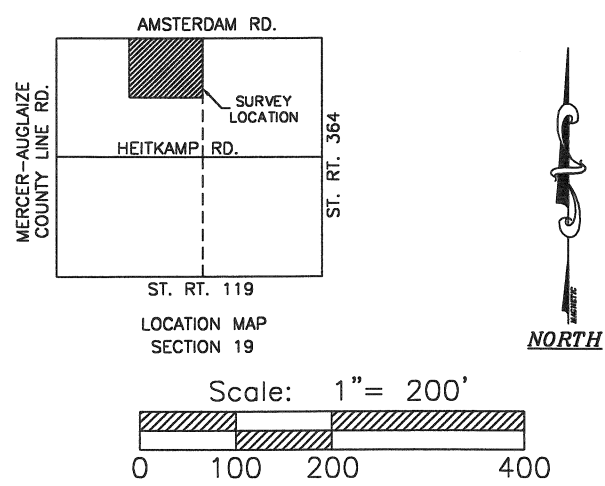

LEGEND

- MONUMENT BOX
- IRON PIN FOUND
- 5/8" IRON PIN W/ CAP SET
- MAG NAIL SET
- MAG NAIL FOUND
- P.K. NAIL FOUND
- WOOD POST FOUND

REFERENCES:

- WOLTERS SURVEY BY STEVEN H. KREMER, P.S. #7487, DATED 9/1/2001
- BRUNS SURVEY BY ALVIN J. SPRALEY, P.S. #5016, DATED 7/19/1985
- ALL DEEDS AS REFERENCED
- AUGLAIZE COUNTY GPS RECORDS

NOTE:
BASIS OF BEARINGS FROM
AUGLAIZE COUNTY GPS RECORDS



SURVEYED BY: *[Signature]*
CRAIG W. MESCHER REG. SURVEYOR No. 8237
DATE: 3/31/2009

M & S SURVEYING
P.O. BOX 86
OSGOOD, OHIO 45351
PHONE: (419) 305-3335

AMSTERDAM ROAD (50' R/W)
NORTH LINE NORTHWEST FRACTIONAL QUARTER OF SECTION 19

S 88°59'25" E ~ 3324.66'
(BASIS OF BEARINGS)
S 88°59'25" E ~ 1657.75'

NORTH QUARTER POST
SECTION 19

TRUE POINT
OF BEGINNING

WILKER ROAD

NORTHWEST CORNER
SECTION 19

JOHN & REBECCA
BRUNS
O.R. 411 PAGE 712

5/8" IRON PIN
FOUND BENT
(ON-LINE)

AREA SURVEYED
50.972 Ac. GROSS
- 0.951 Ac. R/W
50.021 Ac. NET

LEON E. HEITKAMP &
ELAINE A. HEITKAMP
O.R. 441 PAGE 1642
(50 Ac. BY DEED)

GERALD J. BRUNS
O.R. 458 PAGE 1016 & 1020

N 01°27'35" E ~ 1337.09'

6" WOOD POST FOUND 4.00'± NORTH OF
IRON PIN W/ CAP SET ON-LINE. WOOD
POST MATCHES SPRALEY SURVEY THAT
DEPICTS FENCE ROW BETWEEN BRUNS &
HEITKAMP PROPERTIES AT THE TIME OF THE
SURVEY AND WAS THE OBSERVED PROPERTY
LINE OF THE TWO LAND OWNERS.

8" WOOD POST FOUND 4.00'± WEST OF
IRON PIN W/ CAP SET. THE WOOD POST
MATCHES KREMER SURVEY OF WOLTERS
PROPERTY TO THE SOUTH. THE IRON PIN
WITH CAP SET BY KREMER WAS FOUND
LEANING AGAINST WOOD POST ON THE
SURFACE.

PAUL J. WOLTERS
O.R. 544 PAGE 928

KENNETH & JENNIFER WOLTERS
O.R. 349 PAGE 1054

N 88°54'56" W ~ 1660.79'

WOLTERS FARMS
O.R. 348 PAGE 420

**Survey for
Leon E. & Elaine A. Heitkamp
50.972 Ac.**

Being the Northeast Quarter (1/4) of the Northwest Fractional Quarter (1/4) of Section 19, Town 7 South, Range 4 East, Jackson Township, Auglaize County, Ohio, and described as follows:

Commencing at an Iron Pin Found in a Monument Box marking the North Quarter Post of Section 19 and the **TRUE POINT OF BEGINNING**;

Thence South $01^{\circ}19'44''$ West along the East line of the Northwest Fractional Quarter of Section 19, a distance of one thousand three hundred thirty-nine and twenty-three hundredths feet (1339.23') to a 8" Wood Post Found, passing an Iron Pin with Cap Set at twenty-five and zero hundredths feet (25.00');

Thence North $88^{\circ}54'56''$ West, a distance of one thousand six hundred sixty and seventy-nine hundredths feet (1660.79') to an Iron Pin with Cap Set;

Thence North $01^{\circ}27'35''$ East, a distance of one thousand three hundred thirty-seven and nine hundredths feet (1337.09') to a Railroad Spike Found, passing an Iron Pin Found Bent at nine hundred sixty-four and seventy-eight hundredths feet (964.78'), and an Iron Pin with Cap Set at one thousand three hundred twelve and nine hundredths feet (1312.09');

Thence South $88^{\circ}59'25''$ East along the North line of the Northwest Fractional Quarter of Section 19 and the centerline of Amsterdam Road, a distance of one thousand six hundred fifty-seven and seventy five hundredths feet (1657.75') to the **TRUE POINT OF BEGINNING** containing 50.972 acres of land more or less.

Said tract being subject to all highways and any other easements or restrictions of record.

Previous Deed Reference: O.R. 441, Page 1642

Description based on a survey by Craig W. Mescher Registered Surveyor No. 8237 in March 2009 and is on file with the Auglaize County Engineer's Office.

Q 285