

# ADD-ON SURVEY STROH TO SPENCER

0.796 Acre Parcel being a part of the Southwest Quarter of  
Section 12, St. Marys Township, Town-6-South, Range-4-East,  
County of Auglaize, State of Ohio



Northwest Corner,  
Southwest Quarter,  
Section 12,  
St. Marys Twp.

ATTEST

*Ted K. Schnell*

Ted K. Schnell  
Professional Engineer  
Professional Surveyor

SCALE

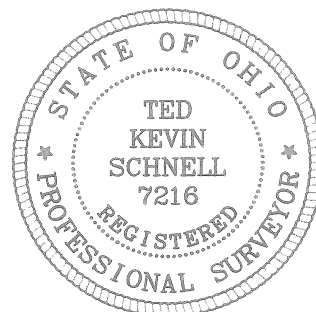
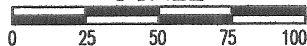

PLATTNER PIKE (C.R. # 61)  
West Line of the Southwest Quarter of Section 12, St. Marys Township

S. 01°-07'-55" W.  
486.11'

N. 01°-07'-55" E.  
203.00'

N. 01°-07'-55" E.  
203.00'

LOCATION PLAN

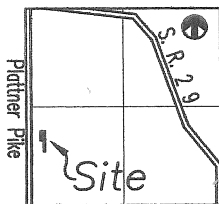

Section 12, St. Marys Twp.  
Auglaize County, Ohio

S. 88°-52'-05" E.  
245.00'

N. 88°-52'-05" W.  
245.00'

283.14'  
S. 88°-52'-05" E.

POB

S. 88°-52'-05" E.  
105.00'

N. 01°-07'-55" E.  
203.00'

N. 88°-52'-05" W.  
38.14'

N. 01°-07'-55" E.  
200.00'

66.86'  
N. 88°-52'-05" W.

S. 01°-07'-55" W.  
403.00'

Carl D. Stroh  
Volume: OR 46  
Page: 319

## LEGEND

- Iron Pin (set)
- Iron Pin (found)
- △ Mag Nail (set)
- ▲ P.K. Nail (found)
- Monument Box

Craig & Monica Rupert  
Volume: OR 508  
Pages 1145-1146

Randall & Jennifer Spencer  
Volume: 264  
Page: 510

## NOTES

The Basis of Bearings used for this Survey was determined  
from the Auglaize County Engineer's Global Positioning Survey.

This Survey Plat and Description is Recorded in Survey Book  
**Q 299**, Page **299** Auglaize County Engineer's Tax  
Map Office.

## PREVIOUS SURVEYS

SURVEY BOOK K, PAGE 301 (Geeslin Survey of 1.300 Acres)  
SURVEY BOOK K, PAGE 487 (Schnell Survey of 1.142 Acres)

## H & S Civil Engineers and Land Surveyors

913 Fieldstone Court Wapakoneta, Ohio 45895

CARL D. STROH

client

12

section

ST. MARYS

township

AUGLAIZE

county

OHIO

state

04/10/09

date



**Q 299**

# H & S Civil Engineers and Land Surveyors

913 Fieldstone Court  
Wapakoneta, Ohio 45895  
Phone (419) 738-4758  
Fax (419) 739-7631  
email: hscivil@bright.net

Ted K. Schnell P.E., P.S.

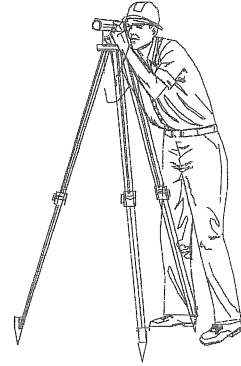

04/22/09

## SURVEYOR'S DESCRIPTION FOR 0.796 ACRE PARCEL CARL D. STROH TO RANDALL & JENNIFER SPENCER

The following described parcel of land is situated in the Southwest Quarter of Section 12, St. Marys Township, Town-6-South, Range-4-East, Auglaize County, Ohio, and is more particularly described as follows:

Commencing for reference at a Monument Box located at the Northwest Corner of the Southwest Quarter of said Section 12, St. Marys Township;

Thence with a bearing of S. 01°-07'-55" W. along the West line of the Southwest Quarter of said Section 12, St. Marys Township, and the centerline of Plattner Pike, for a distance of 486.11 feet to a Mag Nail (set);

Thence with a bearing of S. 88°-52'-05" E. for a distance of 245.00 feet to an Iron Pin (found) and the PLACE OF BEGINNING;

Thence continuing with a bearing of S. 88°-52'-05" E. for a distance of 105.00 feet to an Iron Pin (set);

Thence with a bearing of S. 01°-07'-55" W. and parallel with the West line of the Southwest Quarter of said Section 12, St. Marys Township, and the centerline of Plattner Pike, C.R. #61, for a distance of 403.00 feet to an Iron Pin (set);

Thence with a bearing of N. 88°-52'-05" W. for a distance of 66.86 feet to an Iron Pin (found);

Thence with a bearing of N. 01°-07'-55" E. and parallel with the West line of the Southwest Quarter of said Section 12, St. Marys Township, and the centerline of Plattner Pike, C.R. #61, for a distance of 200.00 feet to an Iron Pin (found);

Thence with a bearing of N. 88°-52'-05" W. for a distance of 38.14 feet to an Iron Pin (found);

Thence with a bearing of N. 01°-07'-55" E. and parallel with the West line of the Southwest Quarter of said Section 12, St. Marys Township, and the centerline of Plattner Pike, C.R. #61, for a distance of 203.00 feet to an Iron Pin (found) and the original PLACE OF BEGINNING.

Containing in all 0.796 Acres of land. The above described parcel of land is subject to all other legal easements, reservations, or restrictions, if any, upon said premises.

(continued)

The basis of bearings used for this survey were determined from the Auglaize County Global Positioning survey, whereas the West line of the Southwest Quarter of said Section 12, St. Marys Township, and the centerline of Plattner Pike, C.R. #61, has a bearing of S. 01°-07'-55" W.

Previous Deed References: Deed Volume OR 46, Page 319, Auglaize County Recorder's Office.

PREPARED BY:



Ted K. Schnell  
Professional Engineer  
Professional Surveyor

