

KRAMER TO KREBS SURVEY

1.510 Acre Parcel being a part of the Northwest Quarter of
Section 25, Moulton Township, Town-5-South, Range-5-East,
County of Auglaize, State of Ohio



Carl Jr. & Peggy Schlenker (Trustees)
Volume: OR 567
Page: 1357-60

Tom & Luanne Miller
Volume: OR 183
Page: 399

S. 85°-15'-19" E.
257.70'

S. 85°-15'-19" E.
200.00'

GLYNWOOD ROAD
(C.R. 158)

Intersection of the West
Line of the Northwest
Quarter with the Centerline
of Glynwood Road

Ref. Pin
at 25.00'

1.510 ACRES
(0.115 Acres R/W)

N. 00°-06'-21" W.
330.00'

S. 00°-06'-21" E.
330.00'

SCALE



Ivo & Camille Kramer
Volume: OR 103
Page: 1097

LOCATION PLAN

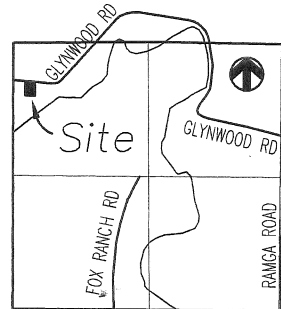

Section 25, Moulton Twp.
Auglaize County, Ohio

Joy & Michelle Sweede
Volume: OR 530
2564-65

ATTEST

Ted K. Schnell

Ted K. Schnell
Professional Engineer
Professional Surveyor

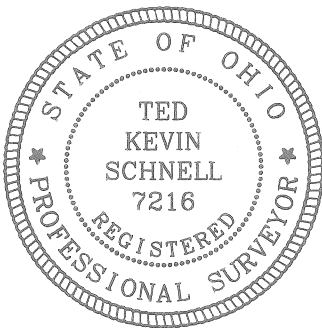
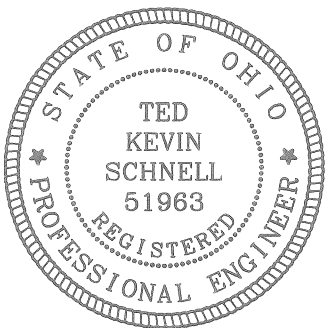

LEGEND

- 5/8ths Iron Pin (set)
- 2" Iron Pipe (found)
- △ Mag Nail (set)
- ▲ RR Spike (found)
- Monument Box

229.72'

S. 00°-06'-21" E.

Iron Pipe (found) for reference
at the top of River Bank

Auglaize River

NOTES

The Basis of Bearings used for this Survey was determined
from the Auglaize County Engineer's Global Positioning Survey
where the C of Glynwood Road Bears S. 85°-15'-19" E.

This Survey Plat and Description is Recorded in Survey Book
Q, Page **432**, Auglaize County Engineer's Tax
Map Office.

H & S Civil Engineers and Land Surveyors

913 Fieldstone Court Wapakoneta, Ohio 45895

KRAMER TO KREBS
client

25
section

MOULTON
township

AUGLAIZE
county

OHIO
state

11/09/09
date



H & S Civil Engineers and Land Surveyors

913 Fieldstone Court
Wapakoneta, Ohio 45895
Phone (419) 738-4758
Fax (419) 739-7631
email: hscivil@bright.net

Ted K. Schnell P.E., P.S.

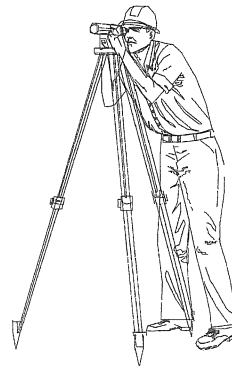

11/11/09

SURVEYOR'S DESCRIPTION FOR 1.510 ACRE PARCEL

The following described parcel of land is situated in the Northwest Quarter of Section 25, Moulton Township, Town-5-South, Range-5-East, Auglaize County, Ohio, and is more particularly described as follows:

Commencing for reference at a Monument Box located at the intersection of the West Line of the Northwest Quarter of said Section 25, Moulton Township, with the centerline of Glynwood Road (C.R. 158);

Thence with a bearing of S. 85°-15'-19" E. along the centerline of Glynwood Road (C.R. 158) for a distance of 257.70 feet to a Mag Nail (set) and the PLACE OF BEGINNING;

Thence continuing with a bearing of S. 85°-15'-19" E. along the centerline of Glynwood Road (C.R. 158) for a distance of 200.00 feet to a Railroad Spike (found);

Thence with a bearing of S. 00°-06'-21" E. for a distance of 330.00 feet to an Iron Pin (set);

Thence with a bearing of N. 85°-15'-19" W. for a distance of 200.00 feet to an Iron Pin (set);

Thence with a bearing of N. 00°-06'-21" W. for a distance of 330.00 feet to an Mag Nail (set), and passing thru and Iron Pin (set) for reference at a distance of 305.00 feet, said Mag Nail being the original PLACE OF BEGINNING.

Containing in all 1.510 Acres of land, of which, 0.115 Acres being used for highway purposes. The above described parcel of land is also subject to all legal easements, reservations, or restrictions, if any, upon said premises.

The basis of bearings used for this survey were determined from the Auglaize County Engineer's Global Positioning Survey. Previous Deed References: Deed Volume OR 103, Page 1097, Auglaize County Recorder's Office.

PREPARED BY:

A handwritten signature in black ink that reads "Ted K. Schnell".

Ted K. Schnell
Professional Engineer
Professional Surveyor

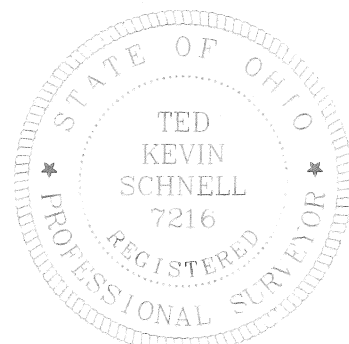
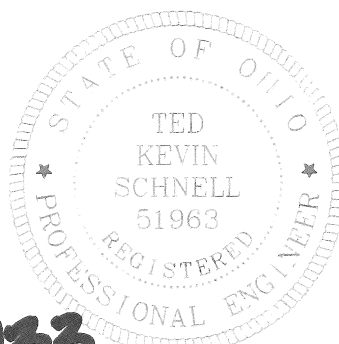

R-433