

Charlyine Kantner (Trustee)
OR Volume 556, Page 2653

1.000 acres
(0.049 acres right-of-way)

S89°51'26"E
325.85'

N89°51'26"W
240.00'

Betty Kantner
Deed Volume 213, Page 113

N00°00'00"W
267.35'

S00°00'00"W
181.50'

Wapak-Fisher Road

222.25'

S00°00'00"W
85.85'

Wapak-Fryberg Road (50' RW)

M00°00'00"S
181.50'

right-of-way line

**Part of the NE 1/4 of Section 3,
T-6-S, R-6-E, Pusheta Township,
Auglaize County, Ohio**

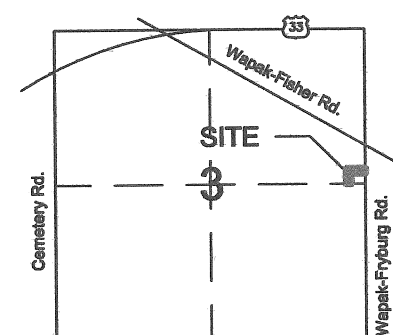

Vicinity Map - Section 3
Pusheta Township

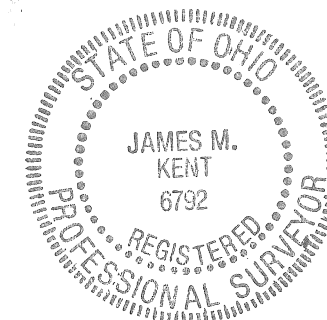

I hereby certify that this plat is representative
of a field survey, performed under my direct
supervision.

James M. Kent
James M. Kent, Professional Surveyor No. 6792

kent surveying, inc.

AutoCAD ~ Kantner, Dean 1750 Bellefontaine St.
drawing #5162 Wapakoneta, OH 45895
December 2, 2009 419.738.7948

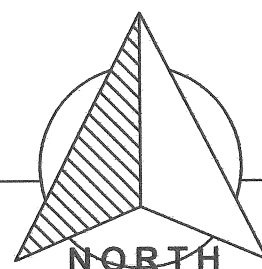

GRAPHIC SCALE

Jeffery & Christine Green
OR Volume 217, Page 289

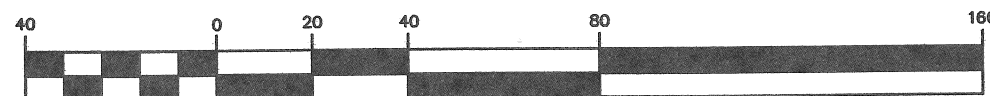

(IN FEET)
1 inch = 40 ft.

Legend

- △ RR spike (found)
 - P-K nail (found)
 - ▽ mag-nail (set)
 - 5/8" re-rod w/cap (set)
- Basis of bearings is per "Connie Oen" survey
prepared by John W. Jauert, PS 6920 dated
August 1993 and recorded in Bk "I", pg. 696.

NE Corner,
SE Quarter,
Section 3

Q-449

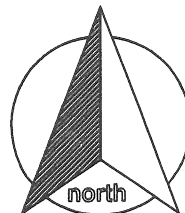

SURVEYOR'S DESCRIPTION

scale:

Being a part of the northeast quarter of Section 3, Town-6-South, Range-6-East, Pusheta Township, Auglaize County, Ohio as evidenced by Official Record Volume 556, Page 2653 and more particularly described as follows:

Commencing for reference at a railroad spike (found) at the northeast corner of the southeast quarter of Section 3 and the legal centerline of Wapak-Fryburg Road; thence, N 00° 00' 00" E along the east line of the northeast quarter of Section 3 and the legal centerline of Wapak-Fryburg Road for a distance of 181.50 feet to a mag-nail (set), said mag-nail being the **POINT OF BEGINNING** for the tract herein described;

thence, N 89° 51' 26" W (passing through a 5/8" re-rod w/cap set for reference on the west right-of-way line of Wapak-Fryburg Road at a distance of 25.00 feet) for a total distance of 240.00 feet to a 5/8" re-rod w/cap (set);

thence, S 00° 00' 00" W for a distance of 181.50 feet to a 5/8" re-rod w/cap (set) on the south line of the northeast quarter of Section 3;

thence, N 89° 51' 26" W along the aforesaid south line, for a distance of 85.85 feet to a 5/8" re-rod w/cap (set);

thence, N 00° 00' 00" W for a distance of 267.35 feet to a 5/8" re-rod w/cap (set);

thence, S 89° 51' 26" E (passing through a 5/8" re-rod w/cap set for reference on the west right-of-way line of Wapak-Fryburg Road at a distance of 300.85 feet) for a total distance of 325.85 feet to a mag-nail (set) on the east line of the northeast quarter of Section 3 and the legal centerline of Wapak-Fisher Road;

thence, S 00° 00' 00" W along the aforesaid east line and legal centerline, for a distance of 85.85 feet to the **POINT OF BEGINNING**, containing therein **1.000 acre** of which 0.049 acres is road right-of-way. Subject to all easements and right-of-way of record at the time of the recording of this instrument. The subject tract is an "add-on" tract, and does not meet the criteria for a "stand alone" residential lot. Prepared by James M. Kent, Professional Surveyor No. 6792 with reference herein made to a plat of survey; Kent Surveying, Inc. drawing #5162 dated December 2, 2009. Basis of bearings per "Oen" survey prepared by John W. Jauert, PS 6920 dated August 1993.

James M. Kent, PS 6792

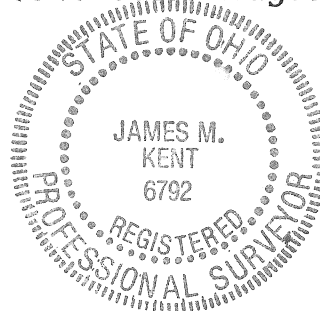

CLIENT DEAN KANTNER DATE 12-02-09
COUNTY AUGLAIZE TOWNSHIP PUSHETA
SECTION 3 T-6-S; R-6-E DRAWN BY JMK
SHEET 1 OF 1 DWG. # 5162

 **kent surveying, inc.**
P.O. Box 96 - 1750 Bellefontaine Street
Wapakoneta, OH 45895
419-738-5677 fax 419-738-7894

Q-450