

SURVEY OF 0.498 ACRES

0.498 Acres being a part of the Southeast Quarter of Section 25,
St. Marys Township, Town-6-South, Range-4-East,
County of Auglaize, State of Ohio

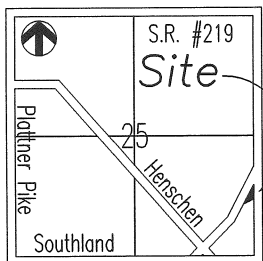

LOCATION PLAN



Section 25
St. Marys Twp

CURVE DATA

$\Delta = 42^{\circ}-27'-45''$

$R = 315.00'$

$T = 122.38'$

Addis & Mary Katterheinrich
Deed Vol OR 116, Page 27
K30-025-001-01

0.498 Acres
(0.268 Acre Exist R/W)

LEGEND

- Iron Pin (set)
- Iron Pin (found)
- △ Mag Nail (set)
- ▲ P.K. Nail (found)
- Monument Box

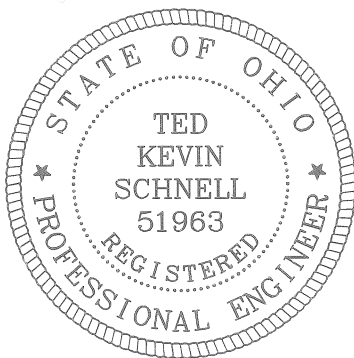

Ted K. Schnell

Ted K. Schnell
Professional Engineer
Professional Surveyor

Ned J. Warner
Deed Vol OR 263, Page 474
K30-025-001-02

NOTES

The bearings used for this Survey were based upon
Auglaize County Engineer's Global Positioning Data.

AUGLAIZE COUNTY ENGINEER
client

25
section

This Survey Plat and Description is Recorded in Survey Book
Q, Page 557, Auglaize County Engineer's Tax
Map Office.

ST. MARYS
township

AUGLAIZE
county

OHIO
state

7/02/10
date

AUGLAIZE COUNTY ENGINEER

P.O. Box 59

1014 SOUTH BLACKHOOF STREET

WAPAKONETA, OHIO 45895

PHONE (419) 739-6520 FAX (419) 739-6521

Description for 0.498 Acre Parcel Ned J. Warner to Auglaize County Engineer and Auglaize County Commissioners

The following described parcel of land is situated in the Southeast Quarter of Section 25, St. Marys Township, Town-6-South, Range-4-East, Auglaize County, Ohio, and is more particularly described as follows:

Commencing for reference at a Monument Box (found) at the Northeast corner of the Southeast Quarter of said Section 25, St. Marys Township;

Thence with a bearing of S. 01°-03'-20" W. along the East line of the Southeast Quarter of said Section 25, St. Marys Township, and the centerline of East Shelby Road, (T.R. #71), for a distance of 478.35 feet to a P.K. Nail (found) at the intersection of East Shelby Road (T.R #71) New Bremen-New Knoxville Road (C.R. 65A), and the PLACE OF BEGINNING;

Thence continuing with a bearing of S. 01°-03'-20" W. along the East line of the Southeast Quarter of said Section 25, St. Marys Township, and the centerline of East Shelby Road, (T.R.#71), for a distance of 146.50 feet to a Mag Nail (set);

Thence with a bearing of N. 88°-56'-40" W. for a distance of 110.00 feet to an Iron Pin (set), and passing thru an Iron Pin (set) for reference at a distance of 20.00 feet;

Thence with a bearing of S. 51°-03'-51" W. for a distance of 151.77 feet to a Mag Nail (set), and passing thru an Iron Pin (set) for reference at a distance of 93.29 feet;

Thence with a bearing of N. 25°-52'-30" E. along the centerline and tangent section of New Bremen-New Knoxville Road, (C.R. # 65A), for a distance of 204.00 feet to an Iron Pin (found) at the P.I. of a curve to the right; said curve having the following data: Deflection Angle (∇) = 42°-27'-45", Radius (R) = 315.00', Tangent (T) = 122.38';

Thence with a bearing of N. 68°-20'-15" E. along the centerline and tangent section of New Bremen-New Knoxville Road, County Road # 65A, for a distance of 152.48 feet to a P.K. Nail (found) at the intersection of East Shelby Road (T.R #71) New Bremen-New Knoxville Road (C.R. 65A), and the original PLACE OF BEGINNING.

Containing in all 0.498 Acres of land, of which, approximately 0.268 Acres being previously dedicated for highway purposes. The above described parcel of land is also subject to all other legal easements, reservations, or restrictions, if any, upon said premises.

Basis of Bearings used for this survey were determined from the Auglaize County Engineer's Global Positioning Survey.

Previous Deed References: Deed Volume OR 263, Page 474, Auglaize County Recorder's Office.

Prepared by



Ted K. Schnell
PE # 51963
PS # 7216

Q-558